

BUILT TO WORK THE WAY YOU WORK



OPERATION & PARTS MANUAL



PIK RITE, INC.

60 PIK RITE LANE
LEWISBURG, PA 17837

FAX 570-523-8175
PHONE 800-326-9763
WWW.PIKRITE.COM/SPREADERS

PROUDLY MADE IN THE USA



January 8, 2018

(SPECIFICATIONS AND DESIGN SUBJECT TO CHANGE WITHOUT NOTICE)

Some illustrations may not represent the spreader model you have; however, the principles of operation and maintenance are the same. If you have questions specific to your spreader please contact your dealer.

(SPECIFICATIONS AND DESIGN SUBJECT TO CHANGE WITHOUT NOTICE)



Table of Contents

OPERATOR'S MANUAL	7
SAFETY	8
PREPARING THE TRACTOR	13
PREPARING THE SPREADER.....	15
CONTROLS	17
ATTACHING THE SPREADER	18
DETACHING THE SPREADER	20
TRANSPORT	21
OPERATING THE SPREADER	24
LUBRICATION & MAINTENANCE	27
SPECIFICATIONS	33
PARTS MANUAL.....	34
7215-1-01 Main Frame & Side Panels	36
7215-1-02 Main Floor & Sliding Floor Guides.....	37
7215-1-03 Sliding Floor.....	38
7215-1-04 Pusher	39
7215-1-05 Front Panels & Shields.....	40
7215-1-06 Endgate	41
7215-1-07 Hubs & Spindles	43
7215-1-08A Opt. Tires & Wheels, 11R-22.5 Truck Tires.....	44
7215-1-08 Tires & Wheels, 16.5-16.1 Implement Tires.....	44
7215-1-08C Opt. Tires & Wheels, 425/65R22.5 Truck Tires.....	45
7215-1-08B Opt. Tires & Wheels, 385/65R22.5 Truck Tires.....	45
7215-1-11 Opt. Side Extensions	46
7215-1-12 Opt. Rock Guard	47
7215-2-01 Driveline, Front, 540 rpm 1-3/8" CV	48
7215-2-02 Driveline, Rear, w/ Clutch.....	49

Pik Rite, Inc.
60 Pik Rite Lane
Lewisburg, PA 17837

Phone: 800-326-9763
Fax: 570-523-8175
www.pikrite.com

HR 250
Manure Spreader



7215-2-03	Driveline, Mid Shaft & Shields.....	51
7215-2-04	Vertical Beaters w/ Gearbox.....	52
7215-2-04LP	Vertical Beaters w/ Gearbox, Low Pro.....	53
7215-2-05	Gearbox, Main Beaters, 540 RPM	54
7215-3-01	Hydraulics, Push Cylinders	55
7215-3-02	Hydraulics, Endgate Cylinders	56
7215-3-03	Cylinder, Sliding Floor.....	57
7215-3-04	Cylinder, Pusher	58
7215-3-05	Cylinder, Endgate	59
7215-3-06	Opt. Control Valve, Open Center	60
7215-3-07	Opt. Remote Flow Control.....	61
7215-4-01	Safety Chain.....	63
7215-4-02	Accessories	64
7215-4-03	Light Assembly, LED	65
7215-4-04	Decals, Front.....	66
7215-4-05	Decals, Sides	67
WARRANTY		70

Pik Rite, Inc.
60 Pik Rite Lane
Lewisburg, PA 17837

Phone: 800-326-9763
Fax: 570-523-8175
www.pikrite.com

HR 250
Manure Spreader



Pik Rite, Inc.
60 Pik Rite Lane
Lewisburg, PA 17837

Phone: 800-326-9763
Fax: 570-523-8175
www.pikrite.com

HR 250
Manure Spreader



OPERATOR'S MANUAL

Pik Rite, Inc.
60 Pik Rite Lane
Lewisburg, PA 17837

Phone: 800-326-9763
Fax: 570-523-8175
www.pikrite.com

HR 250
Manure Spreader

SAFETY



RECOGNIZE SAFETY INFORMATION

This is the safety-alert symbol. When you see this symbol on your machine or in this manual be alert to the potential of personal injury.

Follow recommended precautions and safe operating practices

⚠ DANGER

⚠ WARNING

⚠ CAUTION

UNDERSTAND SIGNAL WORDS

A signal word – DANGER, WARNING, or CAUTION-is used with the safety-alert symbol. DANGER identifies the most serious hazards.

DANGER or WARNING safety signs are located near specific hazards. General precautions are listed on CAUTION safety signs. CAUTION also calls attention to safety messages in this manual.



FOLLOW SAFETY INSTRUCTIONS

Carefully read all safety messages in this manual and on your machine safety signs. Keep safety signs in good condition. Replace missing or damaged safety signs. Be sure new equipment components and repair parts include the current safety signs. Replacement safety signs are available from your Pik Rite dealer.

Learn how to operate the machine and how to use controls properly. Do not let anyone operate without instruction.

Keep your machine in proper working condition. Unauthorized modifications to the machine may impair the function and/or safety and affect machine life.

If you do not understand any part of this manual and need assistance, contact your Pik Rite dealer.



KEEP SHIELDS IN PLACE

Do not operate spreader without safety shields in place.

Rotating parts can crush or dismember causing death or personal injury.

Disconnect PTO driveline and hydraulic lines from tractor before removing shields for adjustment or service.



PROTECT BYSTANDERS

Never operate the spreader near people.

Do not place rocks, timbers or other solid objects in the spreader. Objects can be thrown great distances causing injury to people.



WEAR PROTECTIVE CLOTHING

Wear close fitting clothing and safety equipment appropriate to the job.

Prolonged exposure to loud noise can cause impairment or loss of hearing.

Wear a suitable hearing protective device such as earmuffs or earplugs to protect against objectionable or uncomfortable loud noises.

Operating equipment safely requires the full attention of the operator. Do not wear radio or music headphones while operating machine.

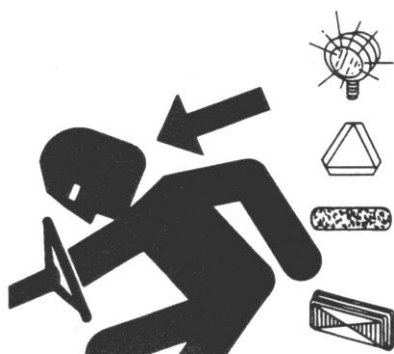

USE SAFETY LIGHTS AND DEVICES

Slow moving tractors, self-propelled equipment and towed implements or attachments can create a hazard when driven on public roads. They are difficult to see, especially at night. Avoid personal injury or death resulting from collision with a vehicle.

Flashing warning lights and turn signals are recommended whenever driving on public roads. To increase visibility, use the devices provided with your machine. For some equipment, install extra flashing warning lights.

Keep safety items in good condition. Replace missing or damaged items.



KEEP RIDERS OFF MACHINE

Riders are subject to injury such as being struck by foreign objects and being thrown off the machine. Riders also obstruct the operator's view resulting in the machine being operated in an unsafe manner



PARK SPREADER SAFELY

Park spreader on a level surface and block wheels.

Close endgate.

Secure jackstand with pin.

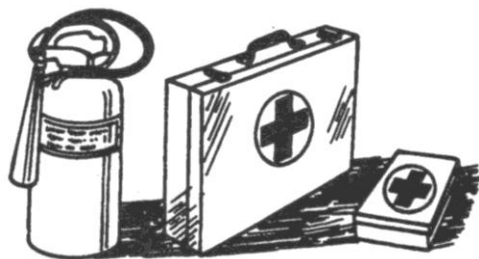

PREPARE FOR EMERGENCIES

Be prepared if a fire starts.

Keep a first aid kit and fire extinguisher handy.

Keep emergency numbers for doctors, ambulance service, hospital, and fire department near your telephone.

USE A SAFETY CHAIN

A safety chain will help control drawn equipment should it accidentally separate from the drawbar.



Using the appropriate adapter parts, attach the chain to the tractor drawbar support or other specified anchor location. Provide only enough slack in the chain to permit turning.

See your Pik Rite dealer for a chain with a strength rating equal to or greater than the gross weight of the towed machine. Do not use safety chain for towing.

OPERATE SPREADER SAFELY



Rotating parts can entangle or strike people, resulting in death or personal injury.

Never enter a spreader while in operation.

Operate the spreader from the tractor seat only.

Do not exceed load capacity of the spreader. (See Transport section)

Reduce speed when turning or traveling on rough terrain. Avoid traveling over loose fill, rocks, ditches or holes.

When working on inclines or slopes, travel uphill or downhill. Keep tractor in gear when traveling downhill.



STAY CLEAR OF RAISED ENDGATE

Contact with a lowering endgate can cause death or personal injury.

Lower endgate and disconnect hydraulic lines before servicing or adjusting.

STAY CLEAR OF ROTATING DRIVELINES

Entanglement in rotating driveline can cause serious injury or death.

Keep tractor master shield and driveline shields in place at all times. Make sure rotating shields turn freely.

Wear close fitting clothing. Stop the engine and be sure PTO driveline is stopped before making adjustments, connections, or cleaning out PTO driven equipment.



STAY CLEAR OF ROTATING BEATER

Rotating beater can entangle or strike causing death or personal injury.

Do not clean out or service spreader while beater is rotating.

Disconnect PTO driveline and make sure all parts have stopped rotating before cleaning or servicing.



WARNING: DO NOT CUT OR WELD ON VERTICAL BEATER ATTACHMENT, SERIOUS INJURY OR DEATH COULD OCCUR WHEN OPERATING

AVOID HIGH-PRESSURE FLUIDS



Escaping fluid under pressure can penetrate the skin causing serious injury.

Avoid the hazard by relieving pressure before disconnecting hydraulic or other lines. Tighten all connections before applying pressure.

Search for leaks with a piece of cardboard. Protect hands and body from high pressure fluids.

If an accident occurs, see a doctor immediately. Any fluid injected into the skin must be surgically removed within a few hours or gangrene may result. Doctors unfamiliar with this type of injury should reference a knowledgeable medical source.



SERVICE SPREADER SAFELY

To help prevent personal injury caused by unexpected movement, be sure to service spreader on level surface.

If spreader is connected to tractor, disengage PTO, engage parking brake and/or place transmission in "PARK," shut off engine and remove key.

If spreader is detached from tractor, block wheels and use safety stands to prevent movement.

Replace all shields after lubricating or servicing.



REDUCE SPEED WHEN TOWING LOADS

Braking to stop towed loads from transport speeds can cause the towed load to swerve and upset. Reduce speed if towed load weighs more than the tractor and is not equipped with brakes.

Follow recommended speed-weight ratio guidelines:

- Maximum speed is 20 mph (32 km/h) when towing loads equal to or less than the tractor.
- Reduce speed to 10 mph (16 km/h) when towing loads more than equal and up to double the tractor weight.
- Do not tow loads exceeding double the tractor weight.
- Use additional caution when towing loads under adverse surface conditions, when turning, and on inclines.

PREPARING THE TRACTOR

PREPARING THE TRACTOR

APPROVED TRACTORS

A drawbar support is required on tractors with a drawbar size of less than 1-1/2 x 3 in.

Tractor hydraulic oil reservoir must have capacity for 3.4 U.S. gal. net draw for spreader with endgate or 3.1 U.S. gal. without endgate.

Tractor standby hydraulic pressure must be between 1500 psi and 2250 psi

One selective control valve is required to operate the spreader.

A second selective control valve is required to operate the endgate.

CHOOSING CORRECT PTO SPEED

MODEL: HP 250 – 540 rpm std.

IMPORTANT: Drive components can be damaged.
Under no circumstances should a machine equipped
for 540 rpm PTO be operated by a tractor equipped
with 1000 rpm PTO

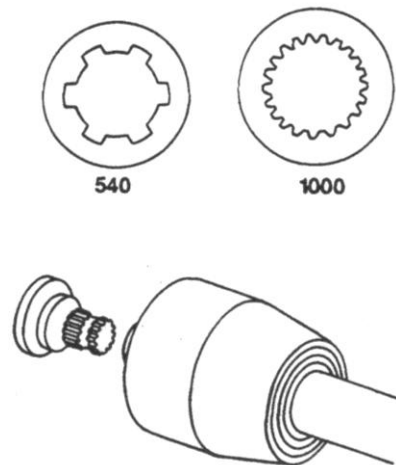

PREPARING THE TRACTOR

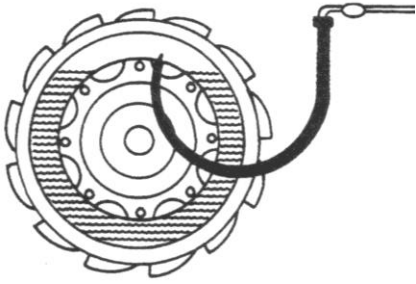

BALLASTING THE TRACTOR

CAUTION: Do not tow loads that weigh more than twice the tractor weight. (See Recommended Maximum Towing Speed in Transporting section.)

To ensure proper stability, adjust ballast and wheel spacing according to tractor operator's manual.

POSITIONING DRAWBAR

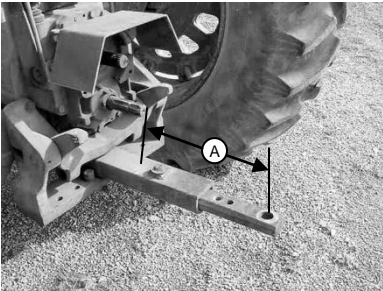

IMPORTANT: Tractor PTO and machine driveline can be damaged. Be sure drawbar length is properly set. If equipped with clevis, remove it. Lock drawbar along tractor centerline with offset down.

Remove clevis if equipped.

Adjust drawbar length (A) (see picture) to help prevent driveline damage.

PTO Speed
540 rpm

Dimension (A)
356 mm (14 in.)

A tractor drawbar support is required on tractors with a drawbar size of less than 1-1/2 x 3 in.

USING SELECTIVE CONTROL LEVERS TO CONTROL FLOOR SPEED

Floor and moving panel speed can be controlled by using tractor selective control lever to extend and retract cylinders.

Adjust selective control valve lever to provide the slowest operating speed. (See your tractor operator's manual).

Maximum hydraulic oil flow through the spreader control valve is 6.8 gpm. Trying to force through more oil than this, may create a pressure drop.

SETTING HYDRAULIC SPEED ENDGATE OPERATION

IMPORTANT: Excessive operating speed may cause machine damage. Adjust selective control valve lever to provide correct operating speed.

Adjust selective control valve lever, it should take two to three seconds to fully extend or retract the cylinder. (See your tractor operator's manual).

CHECKING TRANSMISSION/HYDRAULIC OIL LEVEL

- Cycle all hydraulic cylinders fully two or three times.
- Fully retract all cylinders.
- Check transmission/hydraulic oil level. (See your tractor operator's manual.)

PREPARING THE SPREADER

PREPARING THE SPREADER

LUBRICATING THE MACHINE

Be sure the machine has been adequately lubricated.

(See Lubrication and Maintenance page.)

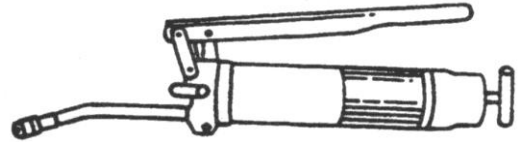

TIGHTENING WHEEL HARDWARE

IMPORTANT: Operating the spreader with loose wheel hardware will damage the hub or wheel. Tighten hardware after initial transport, after one hour of operation and every fifty hours thereafter.

Tighten to 475 lb-ft of torque in the sequence shown.

Tire Size	Wheel Size	Tire Pressure
16.5 x 16.1 Implement	14.00 x 16.1	48 PSI
11 R 22.5	22.5 x 8.25	75 PSI
385/65 R 22.5	22.5 x 11.75	115 PSI
425/65 R 22.5 Truck Tires	22.5 x 13	115 PSI

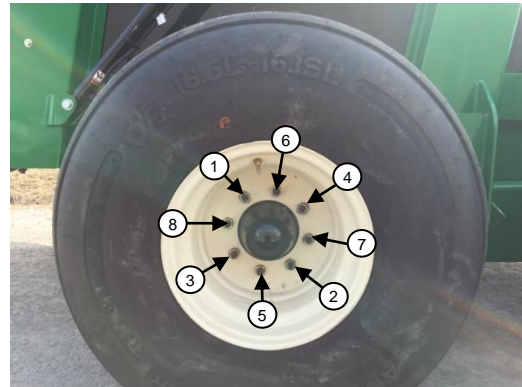

CHECKING TIRES

1. Check tires daily for damage or noticeably low pressure.
2. Repair any cuts or breaks as soon as possible.
3. Protect tires from exposure to sunlight and petroleum products or chemicals.



CONTROLS

OPERATING THE BEATER

To start beater, engage PTO lever slowly, at low engine rpm.

To stop beater, lower engine rpm and disengage PTO. (See your tractor's Operator's Manual)

For best spreading results, operate the tractor engine at "PTO RATED" speed.

OPERATING THE ENDGATE

IMPORTANT: Contact of sliding floor/moving panel with endgate will cause damage. To avoid contact with moving panel, endgate must be raised fully.

Operate the endgate with the second auxiliary control valve lever.

WARNING: Endgate is not a metering device. Doing so may cause damage to the spreader.



OPERATING SLIDING FLOOR/MOVING PANEL USING METERING CONTROL VALVE

To extend the sliding floor and moving panel, lock control lever in operating position.

To retract the sliding floor/moving panel, move control lever in opposite direction.

See your tractor's operating manual for information on how to control flow rates of your hydraulic system.

Maximum hydraulic oil flow through the spreader control valve is 6.8 gpm. Trying to force through more oil than this, may create a pressure drop.

ATTACHING THE SPREADER

ATTACHING THE SPREADER

ATTACHING SPREADER

CAUTION: Help prevent personal injury caused by unexpected movement of the machine. Engage parking brake and/or place transmission in "PARK", shut off engine, and remove key before working around hitch.

1. Attach with a 1-1/8 pin and secure.

IMPORTANT: Shorten safety chain to allow only enough slack required for turning.

2. Lock safety hook onto chain.

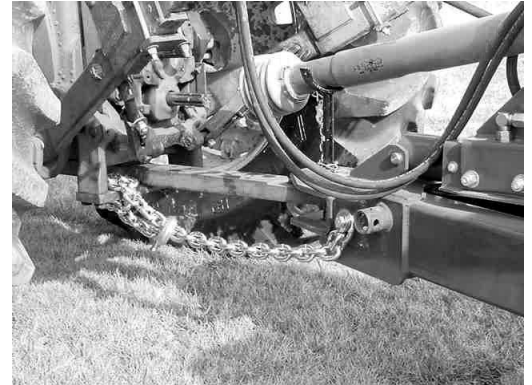

STORING JACKSTAND

1. After the spreader is attached to the tractor and secure, remove jackstand from lift position.
2. Store jackstand as shown and secure with pin.



CONNECT HYDRAULIC HOSES

CAUTION: To avoid injury from escaping hydraulic oil under pressure, relieve the pressure in the system by shutting off the tractor and moving remote cylinder operating levers in both directions before attaching hoses to or detaching hoses from the breakaway couplers.



CONNECT ENDGATE HYDRAULIC HOSES

1. Connect pressure hose to pressure port of hydraulic remote coupler.
2. Connect return hose to return port of hydraulic remote coupler.

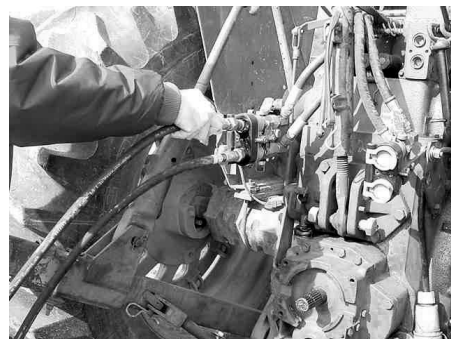

ATTACHING THE SPREADER

CONNECTING HYDRAULIC HOSES

TRACTOR WITH CLOSED CENTER HYDRAULIC SYSTEM

Attach control valve to tractor where it can be reached by the operator.

Attach hoses accordingly.

(Diagram shows unloading configuration, flow reverses to retract.)

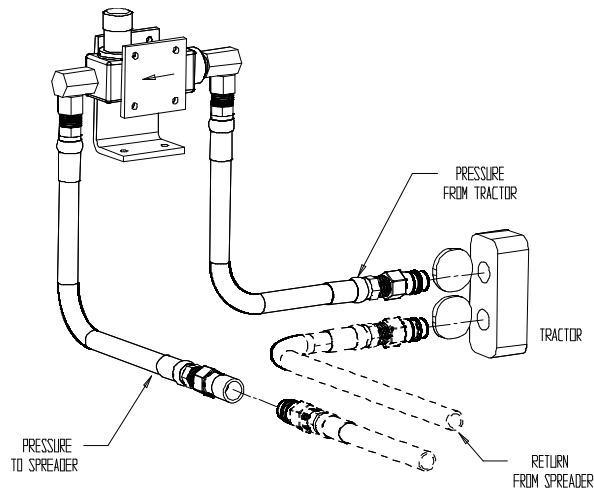

CONNECTING HYDRAULIC HOSES

TRACTOR WITH OPEN CENTER HYDRAULIC SYSTEM

Attach control valve to tractor where it can be reached by the operator.

Attach hoses accordingly.

(Diagram shows unloading configuration, flow reverses to retract.)

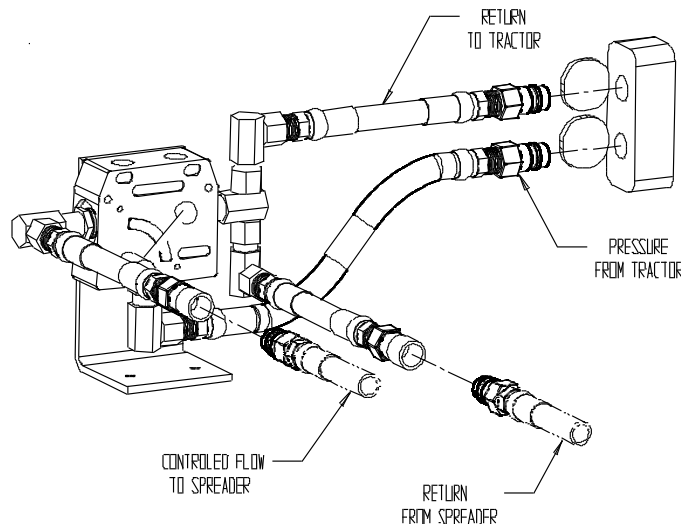

ATTACHING DRIVELINE

IMPORTANT: Avoid causing damage to shielding,
DO NOT use bell on driveline to lift driveline into position.

1. Support driveline, cradling it in your hand.
2. Rotate driveline (C) or tractor PTO (B) to align splines.
3. Pull collar (C) rearward and push forward on bell (A) to engage driveline yoke with tractor PTO (B).
4. Pull back on PTO driveline shielding to be sure driveline is locked. **DO NOT** pull on collar, this will release latch.

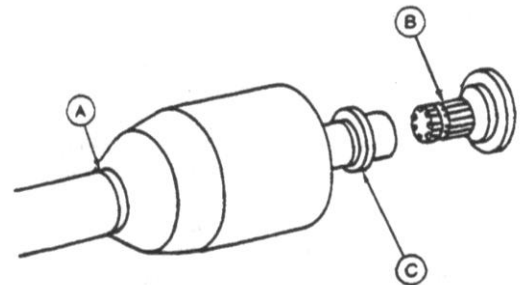

DETACHING THE SPREADER

DETACHING THE SPREADER

DETACHING SPREADER

1. Remove jackstand from storage position, place and secure in lift position.
2. Detach safety chain.
3. Remove hitch pin.
4. Disconnect hoses and control valve. Store on spreader.



DETACHING DRIVELINE

1. Support driveline (A) and pull rearward on collar (C) to release driveline from tractor PTO (B).
2. When possible store driveline in driveline cradle provided with machine.
3. Replace tractor PTO shields.

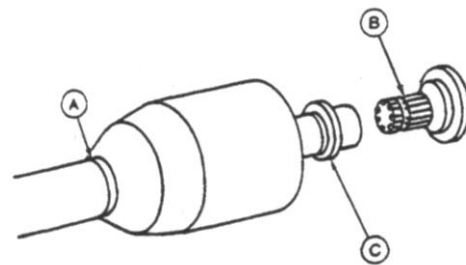

TRANSPORT

USING A SAFETY CHAIN

CAUTION: A safety chain will help control drawn equipment should it accidentally separate from the drawbar while transporting. Using the appropriate adapter parts, attach the chain to the tractor drawbar support or other specified anchor location. Provide only enough slack in the chain to permit turning. See your Pik Rite dealer for a chain with a strength rating equal to or greater than the gross weight of the towed machine.

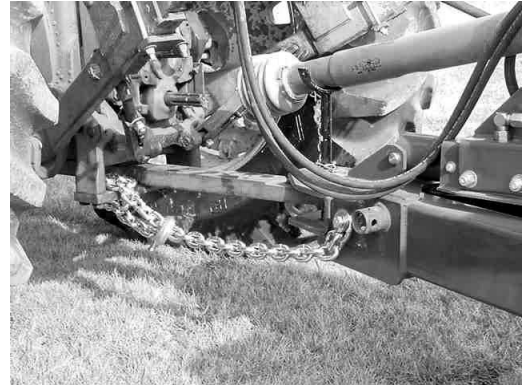

1. Attach safety tow chain

LIGHTING

CAUTION: When transporting the machine on a road or highway at night or during the day, use accessory lights and devices for adequate warning to operators of other vehicles. Check local governmental regulations. Keep safety items in good condition. Replace missing or damaged items.

Contact your Hydra-Ram Dealer for available lighting kit



TOWING LOADS





CAUTION: Braking to stop towed loads from transport speeds can cause the towed load to swerve and upset. Reduce speed if towed load is not equipped with brakes and weighs more than the tractor.



Follow recommended speed-weight ratio guidelines:

- Maximum speed is 20 mph (32 km/h) when towing loads equal to or less than the weight of the tractor.
- Reduce speed to 10 mph (16 km/h) when towing loads more than or up to double the tractor weight.
- **DO NOT** tow loads that exceed double the tractor weight.
- Use additional caution when towing loads under adverse road surface conditions (i.e. slippery or rough), when turning and/or on inclines.
- For proper tractor size and towing speed see the following “Recommended Maximum Towing Speed” chart.
- If necessary, add ballast as described in your tractor’s Operator’s Manual.

RECOMMENDED MAXIMUM TOWING SPEED

Gross Tractor Weight	COMBINED WEIGHT OF SPREADER AND LOAD			
				
<u>Tractor Weight</u>				

(0-2997 lb)	Do Not Tow	Do Not Tow	Do Not Tow	Do Not Tow
(2998-5950 lb)	(10 mph)	(10 mph)	Do Not Tow	Do Not Tow
(5951-11021 lb)	(10 mph)	(10 mph)	(10 mph)	Do Not Tow
(11022-12123 lb)	(20 mph)	(20 mph)	(10 mph)	(10 mph)
(12124-14769 lb)	(20 mph)	(20 mph)	(10 mph)	(10 mph)
(14770-22044 lb)	(20 mph)	(20 mph)	(20 mph)	(10 mph)
(22045-24910 lb)	(20 mph)	(20 mph)	(20 mph)	(20 mph)
(24911-29540 lb)	(20 mph)	(20 mph)	(20 mph)	(20 mph)
(29541 lb-Up)	(20 mph)	(20 mph)	(20 mph)	(20 mph)

**Base Spreader Empty Load*

***Load struck level consisting of manure with high liquid content.
Calculated at 70 lb/cu ft*

****Load piled 381 mm (15 in.) above beater consisting of semi-solid type manure
Calculated at 55 lb/cu ft*

*****Load piled at 15 in. above optional upper beater consisting of semi-solid type manure.
Calculated at 55 lb/cu ft*

OPERATING THE SPREADER

OPERATING THE SPREADER

PREOPERATING CHECKS

1. Be sure spreader does not contain any foreign objects
2. Check for correct hydraulic hookup. Raise endgate fully. Engage beaters, raise endgate, engage moving floor
3. Disengage moving floor, disengage beaters
4. Close endgate

LOADING THE SPREADER

CAUTION: Do not place rocks, timbers, or other solid objects in the spreader. Objects of this nature can damage the spreader and could also be thrown great distances causing possible injury to anyone standing in the vicinity.

Load front of spreader first, distributing load evenly.

When operating without an endgate, avoid loading manure against the beater.



PREPARE TO UNLOAD THE SPREADER

CAUTION: Help prevent personal injury. Be sure no one is near spreader and tractor before operating.

1. Start beater by engaging PTO slowly at low engine rpm. Increase to “PTO RATED” speed.

NOTE: For best spreading results, operate tractor at “PTO RATED” speed.

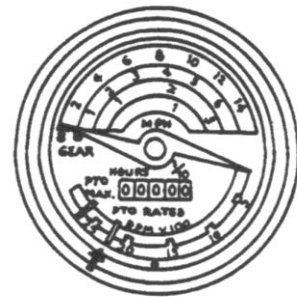

OPERATING THE SPREADER

RAISE ENDGATE

IMPORTANT: Contact of sliding floor/moving panel With endgate will cause damage. To avoid contact with moving panel, endgate must be raised fully.

The endgate closes off the back end of the spreader to contain manure with high liquid content.

The endgate also prevents solid material from being piled tight against the beater.



UNLOADING SPREADER USING METERING VALVE

1. Set flow control on tractor hydraulics obtain desired rate of unload speed.

Note: Rate of spread is affected by both ground speed and unload speed. Experience will help you determine both gear selection and control knob setting.

2. When spreader is empty, disengage PTO, and lower endgate.

PRODUCING GOOD SPREADING RESULTS

1. Operate tractor engine at “PTO RATED” speed.
2. Do not overload beater. A clumpy spread pattern will result from too fast an unload rate.
3. When operating without an endgate, avoid loading material against the beater. Otherwise, large clumps of material will be thrown out during the first few turns of the beater.

CLEANING SPREADER IN COLD WEATHER

When operating the spreader during extended periods of subfreezing temperatures, frozen material may build up on steel surfaces. This can prevent the beater from moving.

After completing spreading for the day, use the following cleaning procedure.

NOTE: Cleaning is only necessary during extended *periods of subfreezing temperatures*.

Remove material buildup from endgate panel. Keep endgate arms clean to prevent freezing to side rails.

OPERATING THE SPREADER

WARMING HYDRAULIC OIL TEMPERATURES BELOW 0°F (−18°C)

It is necessary to warm the hydraulic oil for proper spreader operation.

Follow the procedures in your tractor's Operator's Manual for warming hydraulic oil.

The following procedures apply only to tractors with a closed center hydraulic system.



BYPASSING SPREADER CONTROL VALVE

There will be a large hydraulic oil pressure drop across the auxiliary flow control valve when the oil is cold. Oil pressure available to hydraulic cylinders may be too low.

Try cycling the cylinders several times slowly so the cold oil in the cylinders is mixed with the warm oil in the tractor. In the event of extreme cold; you may need to bypass the control valve to do this. Be sure you begin by moving the cylinders very slowly.

Reconnect hoses to flow control valve.

LUBRICATION & MAINTENANCE

LUBRICATION & MAINTENANCE

CAUTION: Help prevent personal injury caused by unexpected movement of the machine. If spreader is connected to tractor, disengage PTO, engage parking brake and/or place transmission in "PARK", shut off engine, and remove key. If spreader is detached, block wheels and use safety stands.

Replace all shields after lubricating or servicing.

OBSERVING INTERVALS

IMPORTANT: The intervals recommended are based on normal conditions. Severe or unusual conditions may require more frequent attention.



SELECTING GREASE

Depending upon the expected air temperature range during the service interval, use grease as shown on the adjusting temperature chart.

-SAE-Multipurpose High Temperature Grease with Extreme Pressure [EP] Performance with 3 to 5% molybdenum disulfide.

NOTE: Moly-type grease is recommended, however, if not available, a multipurpose grease is acceptable.

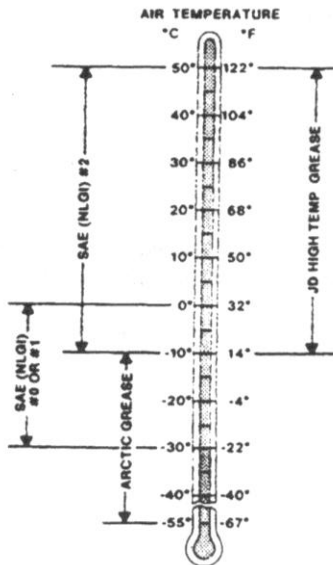

SELECTING GEAR CASE OIL

Depending upon the expected air temperature range during the drain interval, use oil viscosity shown on the adjoining temperature chart.

-API Service Classification GL-5
-Military Specification MIL-L-2105B
-Military Specification MIL-L-2105C

At temperatures below -35° [-31°], use arctic oils such as those meeting Military Specifications MIL-G-10324A.

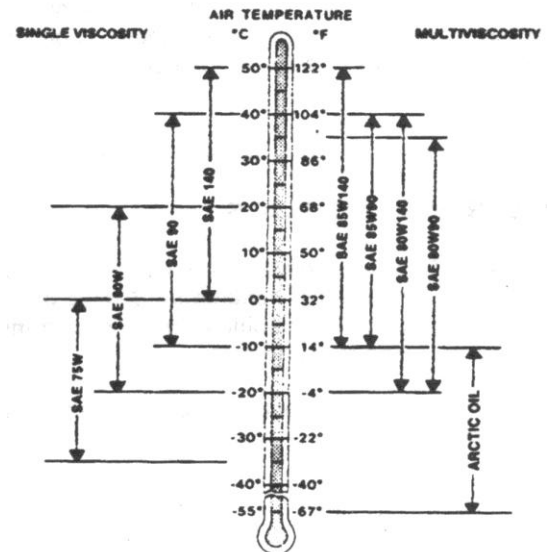

LUBRICATION & MAINTENANCE

SERVICE INTERVALS

Lubricate driveline every 8 hrs

- Lubricate top beater bearings every 40 hrs
- Check gear case oil level every 8 hrs
- Check tires every 8 hrs
- Check axle hub oil every 8 hrs

EVERY 50 HOURS

- Tighten wheel hardware
- Lubricate walking beam pivots

In addition to the above referenced information, you are working with a central lube CV design on the primary that contains a special lubrication provision that needs to be well defined for the user so that extended life on the CV can be achieved.

The key point is that each CV has one zerk in a bearing cap and it is this zerk that is most important since it feeds the inboard cross kit as well as the the ball and socket of the CV. The user needs to understand that the zerk in the cap should receive **15-20 pumps** of grease each day.

The other zerks in the joint, CV housing and telescoping members can operate with 5-6 pumps or until the seals purge. The plastic zerks feeding the shielding should also receive 3-4 pumps daily if shields are being restrained.

Primary Driveline (to Tractor) Lubricate fittings D1 through D6 every eight hours of operation.

Secondary Driveline (under spreader) Lubricate as above including overrunning clutch.

NOTE: Lubrication step D5 is only necessary when driveline does not have grease fitting. Separate front and rear halves of driveline and brush with grease.

EVERY 250 HOURS

- Lubricate endgate pivots

SERVICE AS REQUIRED

- Slip the clutch

GEARBOX

- Change lubricant every 6,000 loads

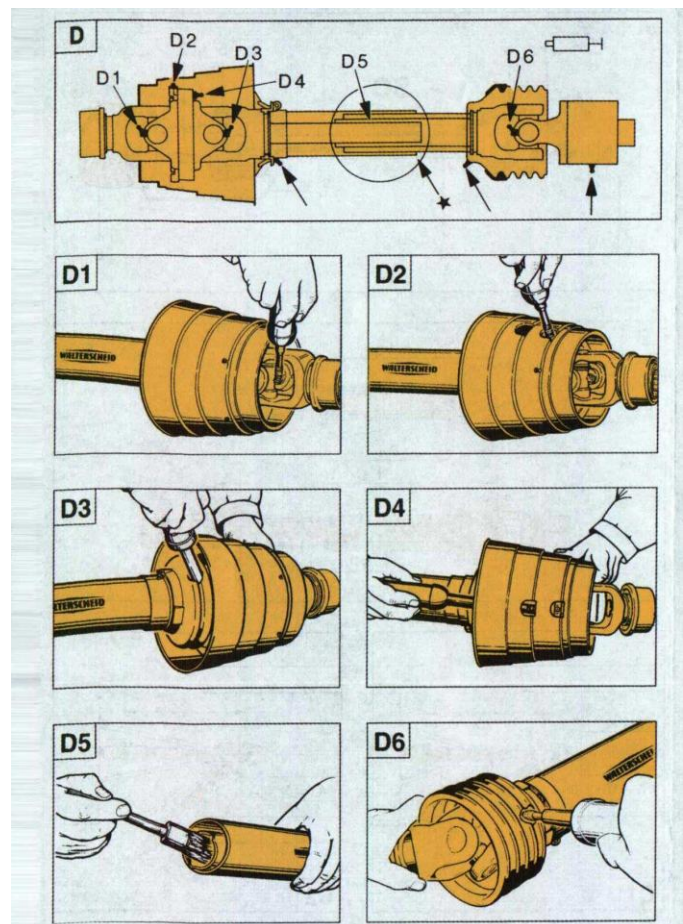

LUBRICATION & MAINTENANCE

CHECK GEAR CASE OIL LEVEL

With spreader on level ground, check oil level at the sight glass on the center gearcase.”A”

Add recommended oil as needed. (See Selecting Gear Case Oil)
To add oil, remove fill cap at the top of the gearcase “B”

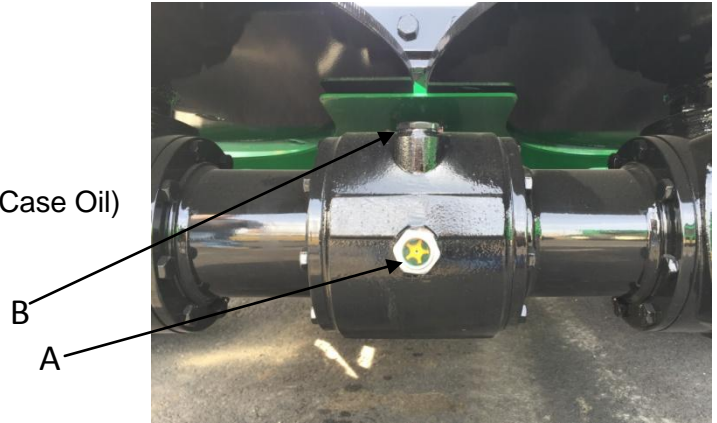

GREASE TOP BEATER BEARINGS

Grease the two bearings at the top of the vertical beaters every 8 hours of operation. Rear grease bank on beater side panel

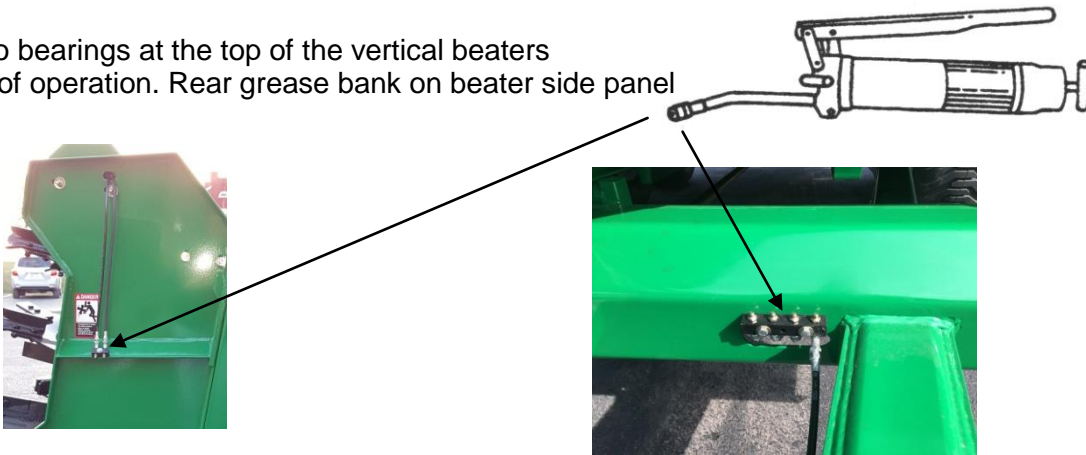

WHEELS AND TIRES

Drop center wheels with recapped truck tires or implement tires are available.

1. Check tires daily for damage or noticeably low pressure.
2. Repair any cuts or breaks as soon as possible.
3. Protect tires from exposure to sunlight and petroleum products or chemicals.

Tire Size	Wheel Size	Tire Pressure
16.5 x 16.1 Implement	14.00 x 16.1	48 PSI
11 R 22.5	22.5 x 8.25	75 PSI
385/65 R 22.5	22.5 x 11.75	115 PSI
425/65 R 22.5 Truck Tires	22.5 x 13	115 PSI



SPECIFICATIONS

LUBRICATE END GATE PIVOTS

Lubricate grease bank on the endgate arm mount

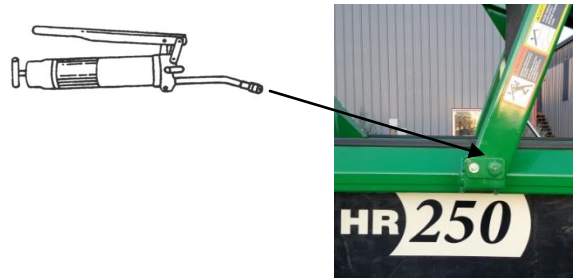

TIGHTENING WHEEL HARDWARE

Operating the spreader with loose wheel hardware will damage the hub or wheel. Tighten hardware after initial transport, after one hour of operation, and every fifty hours thereafter.

Tighten to 170 lb.-ft. in the sequence shown.

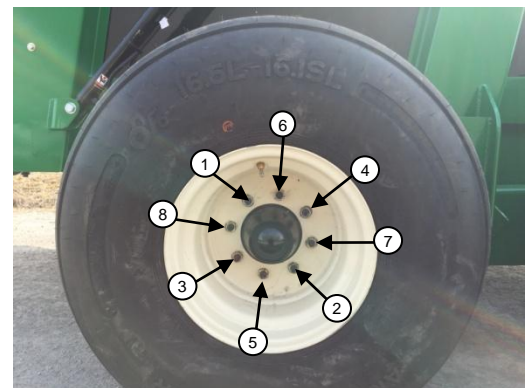

SPECIFICATIONS

LUBRICATE THE THREE PILLOW BLOCKS UNDER THE SPREADER THAT CARRY THE MAIN POWER SHAFT, USING CENTRAL GREASE LOCATION

Lubricate grease fitting with Moly High Temperature/Extreme Pressure Grease.

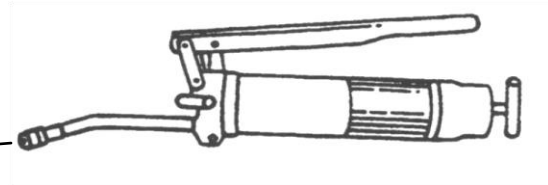

MAINTAINING SLIP CLUTCH, WALTERSCHEID

The clutch is preset and is not field adjustable.

If you determine that your slip clutch needs maintenance or adjustment, contact your dealer.



ADJUST SLIDING FLOOR/MOVING PANEL SEALS

The rubber seals on the moving panel and sliding floor are adjustable.

Properly adjusted seals will minimize leakage and ensure a clean wiping action on the sides and floor.

Inspect adjust, or replace seals as necessary.



SPECIFICATIONS

SPECIFICATIONS

Tractor Size (Minimum)	60 hp PTO
Weight	
Spreader, Complete with Implement tires and all Attachments	5540 lb
Load Capacity	13000 lb
Volume Capacity	
Struck Level	147 cu. ft.
Heaped Load	249 cu. ft
Beater Speed	350 rpm
Unloading Speed	0-16 ft/min Infinitely Variable
Driveline	Shielded 540 rpm
Attachments	Control For Fender or ROPS Open Center Valve With Control Endgate

(Specifications and design subject to change without notice)



PARTS MANUAL

Pik Rite, Inc.
60 Pik Rite Lane
Lewisburg, PA 17837

Phone: 800-326-9763
Fax: 570-523-8175
www.pikrite.com

HR 250
Manure Spreader

DIRECTION ARROW

ARROWS ARE USED WITH ILLUSTRATIONS TO INDICATE THE FRONT OF THE UNIT. "RIGHT-HAND" AND "LEFT-HAND" SIDES ARE DETERMINED BY FACING THE DIRECTION OF MACHINE FORWARD TRAVEL.

BOX ENCLOSED ILLUSTRATIONS

A REFERENCE NUMBER, SHOWN IN THE PARTS LIST, IS ASSIGNED TO A BOX ENCOMPASSING ALL PARTS SOLD AS A SERVICE ASSEMBLY.

REFERENCE NUMBER IDENTIFICATION

000-099	PARTS USED FOR ASSEMBLY
100-199	BOLTS & FASTENERS
800-899	REPLACEMENT PARTS OR SERVICE ASSEMBLIES – USED TO REPLACE OR REBUILD COMPONENTS OF THE MACHINE

7215-1-01

Main Frame & Side Panels

ITEM NO.	QTY	DESCRIPTION	PART NUMBER
1	1	MAIN FRAME	PR70140
2	2	PANELAM, SIDE	PR70153
3	2	GUIDE, SLIDING FLOOR	PR70144
4	2	BUMPER RAIL	PR44526
5	1	EDGE PROTECTOR, PANELAM	PR70162
6	1	EDGE PROTECTOR, PANELAM	PR70163
7	2	SPLASH GUARD	PR39181
8	1	HITCH, 2.125 LOAD CELL	PR75007
9	1	HITCH SHAFT	PR75046
10	1	COLLAR, HITCH SHAFT	PR75047
11	1	1/4" X 28 GREASE FITTING	GF-1428
12	1	CLEVIS PIN	PIN-16-72
13	1	ROLL PIN	PIN-3-20

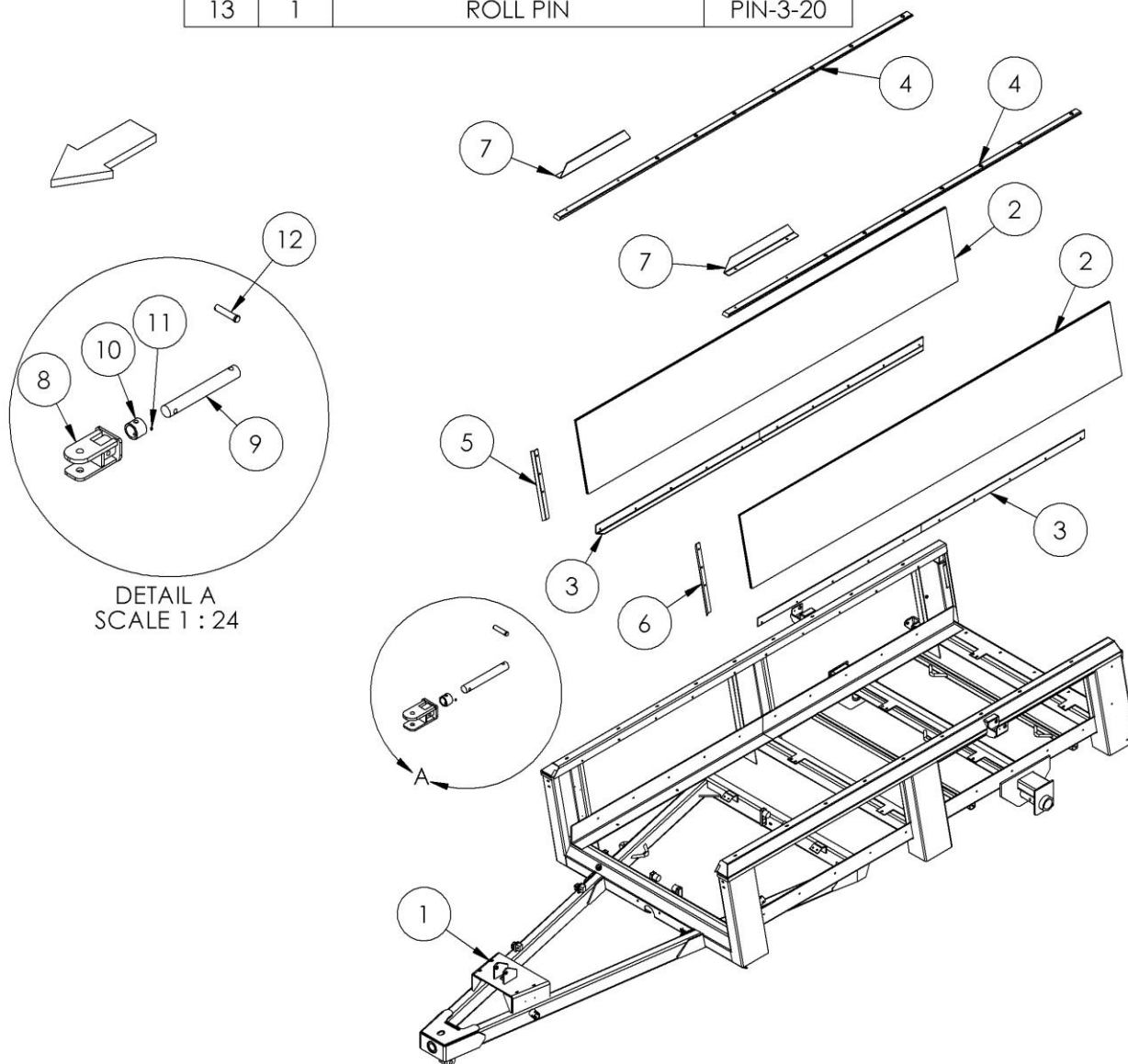

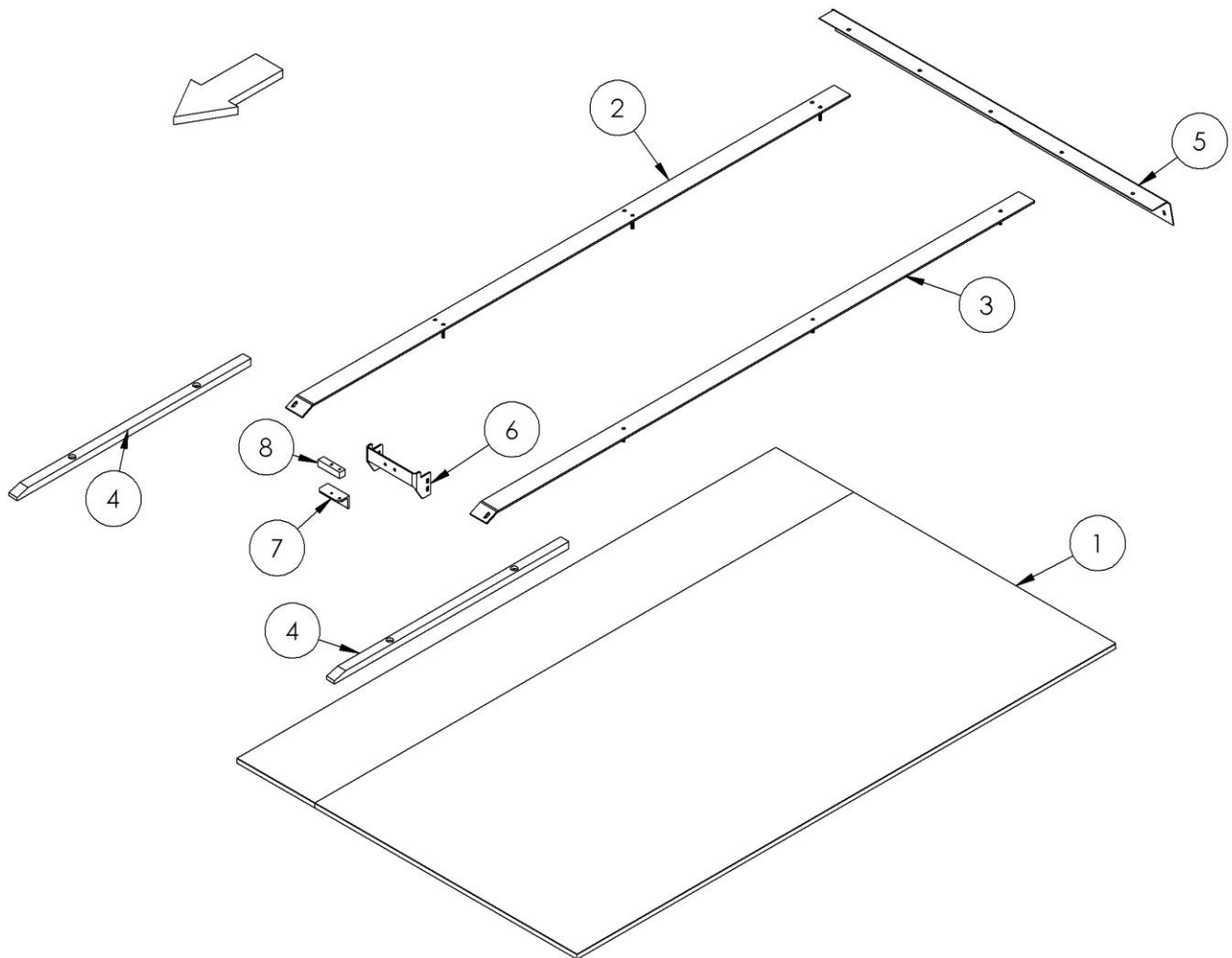

ITEM NO.	QTY	DESCRIPTION	PART NUMBER
1	1	PANELAM FLOOR	PR44530
2	1	WEAR STRIP, SLIDING FLOOR	PR21065
3	1	WEAR STRIP, SLIDING FLOOR	PR21066
4	2	WOOD SLIDE	PR30998
5	1	REAR COVER, PANELAM	PR70146
6	1	BRACLET, FLOOR CYL. SUPP.	PR70147
7	1	ANGLE, FLOOR CYL. SUPP.	PR70092
8	1	PLASTIC, FLOOR CYL. SUPP.	PR32639

7215-1-03

Sliding Floor

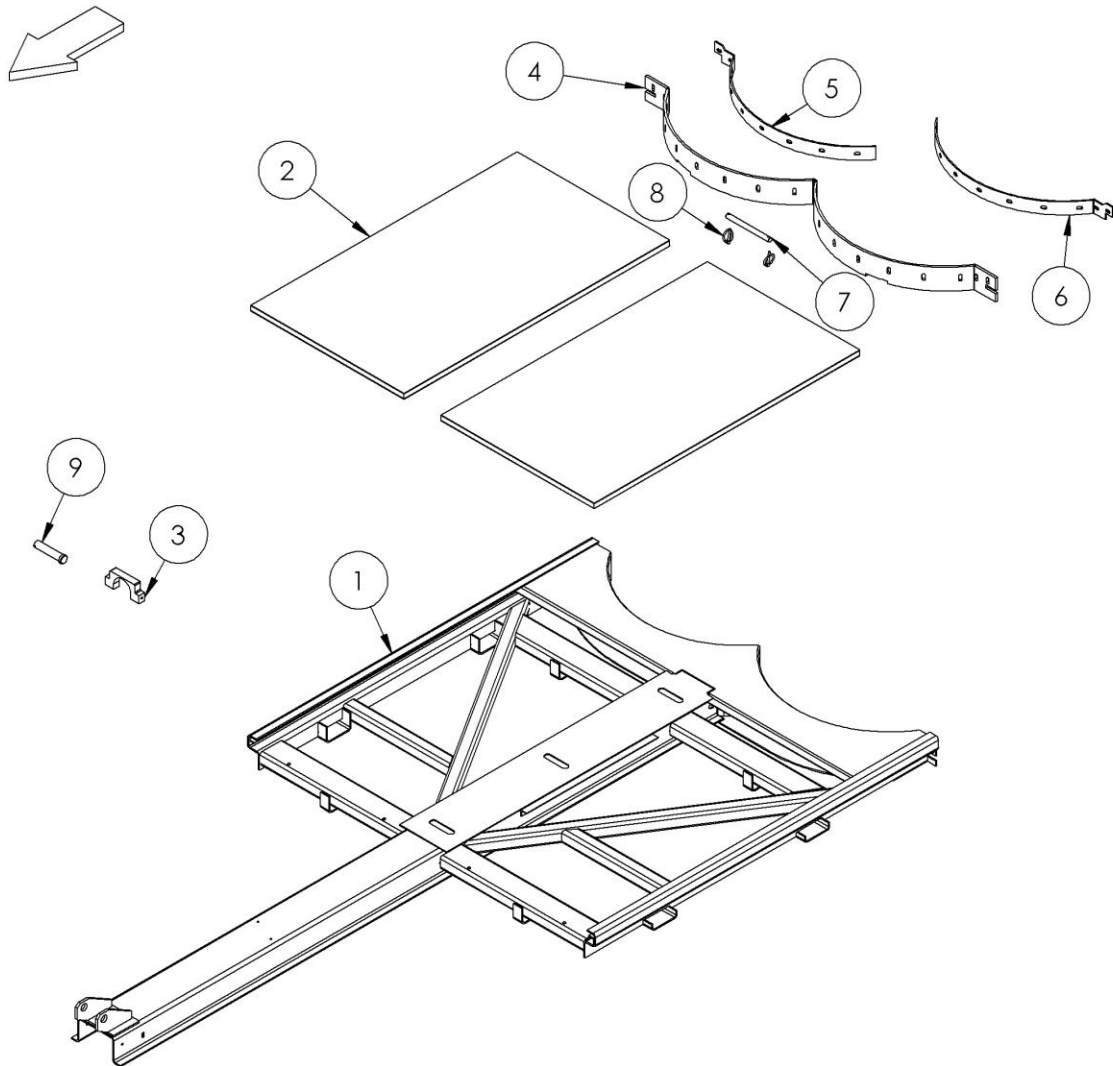

ITEM NO.	QTY	DESCRIPTION	PART NUMBER
1	1	SLIDING FLOOR FRAME	PR70142
2	2	PANELAM, SLIDING FLOOR	PR44562
3	1	PLASTIC CYLINDER GUIDE	PR70143
4	1	SCALLOPED BELTING	PR70164
5	1	SCALLOP BELTING BAR	PR70165
6	1	SCALLOP BELTING BAR	PR70166
7	1	5/8" SS PIN	PR70182
8	2	1/4" LYNCH PIN	PIN-250L
9	1	CLEVIS PIN	PIN-16-72
10	1	ROLL PIN	PIN-3-20

7215-1-04

Pusher

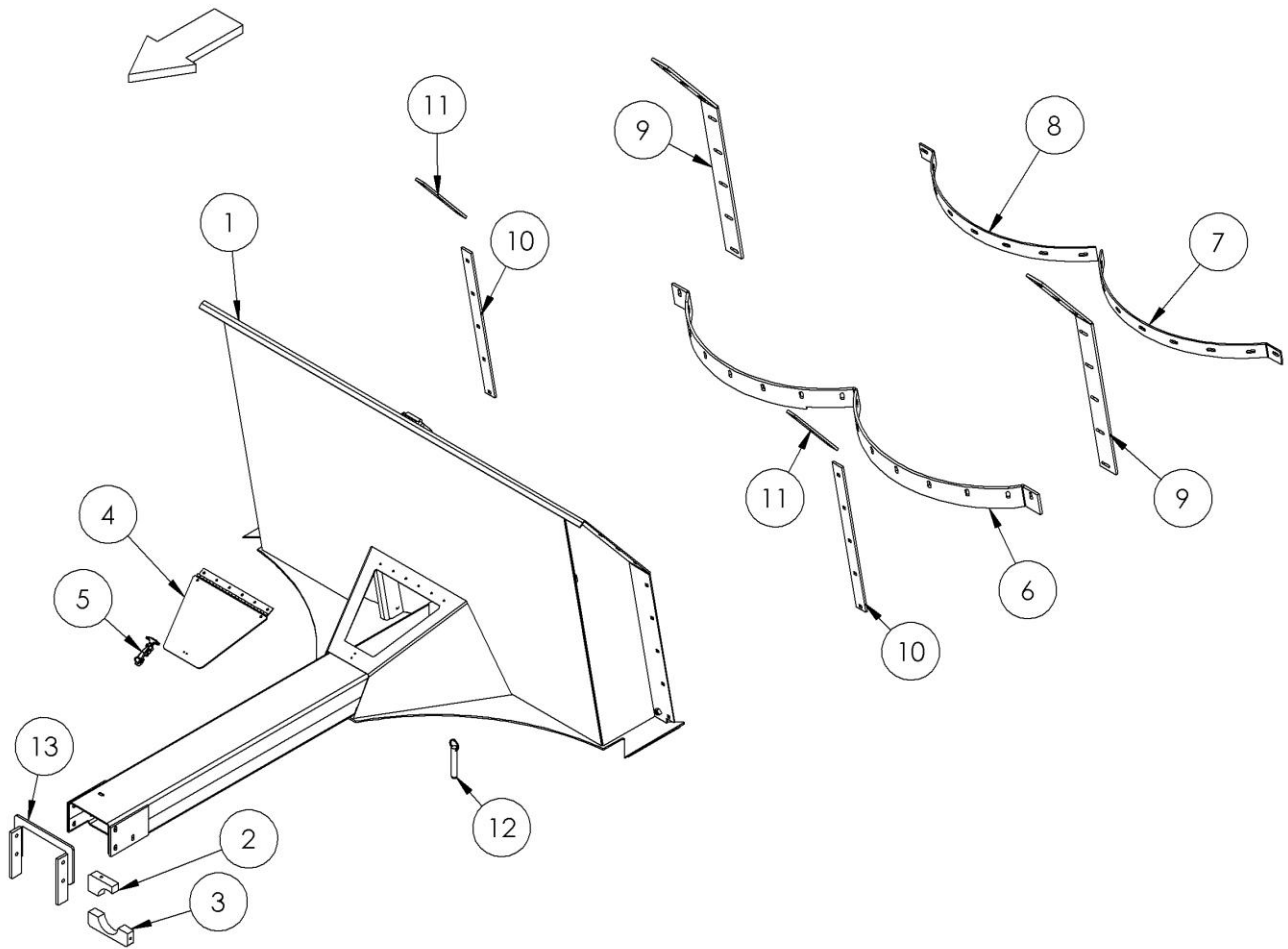

ITEM NO.	QTY	DESCRIPTION	PART NUMBER
1	1	PUSHER WELDMENT	PR70148
2	1	PUSHER CYLINDER GUIDE	PR70154
3	1	PUSHER CYLINDER GUIDE	PR70155
4	1	ACCESS PANEL, PUSHER	PR75037
5	1	MED. RUBBER T-LATCH	LA-1530
6	1	PUSHER BAR, BOTT.	PR70156
7	1	PUSHER BAR, BOTT.	PR70157
8	1	SCALLOP BELTING BAR	PR70158
9	2	BELTING, SIDE	PR70159
10	2	BELTING BACK BAR, SIDE	PR70160
11	2	SIDE BACKING BAR	PR70117
12	1	5/8" QUICK RELEASE PIN, SS	PIN-10-300
13	1	PUSHER GUIDE	PR70199

7215-1-05

Front Panels & Shields

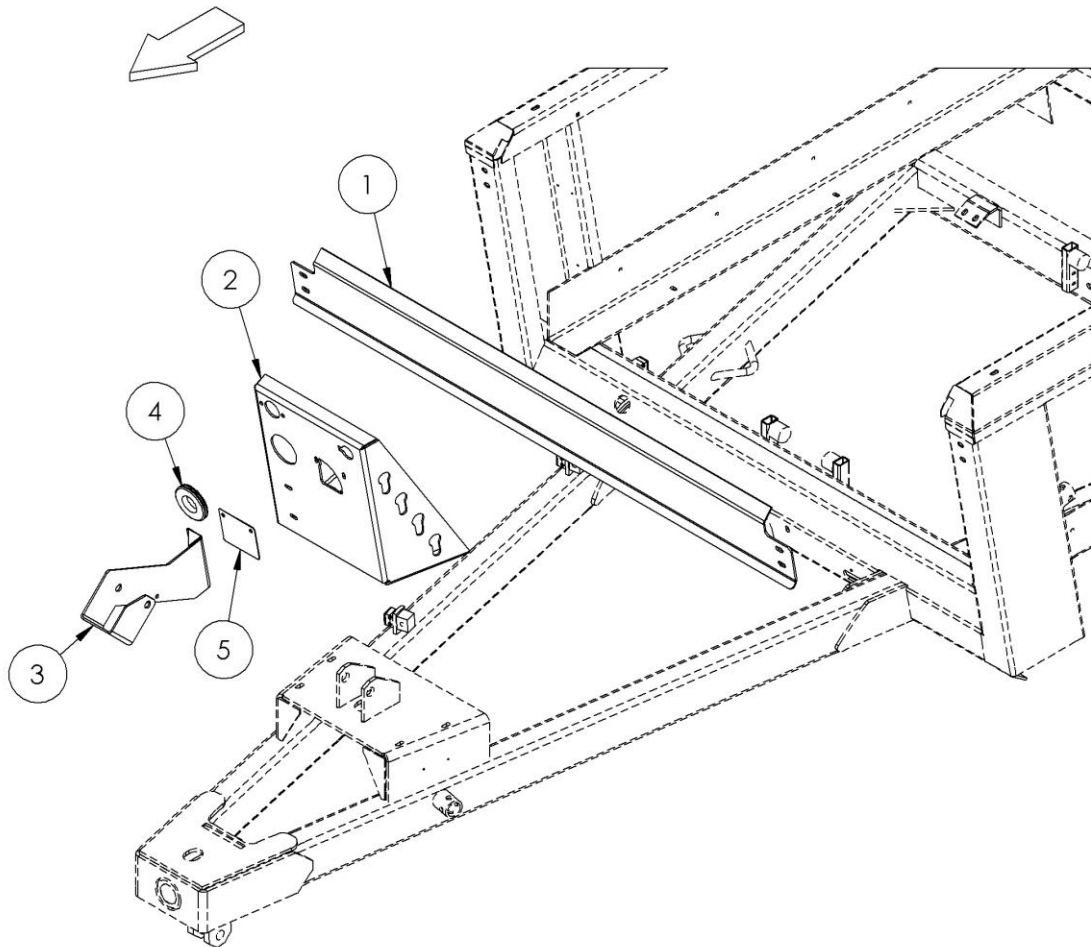

ITEM NO.	QTY	DESCRIPTION	PART NUMBER
1	1	FRONT UPPER PANEL	PR70173
2	1	HOSE MOUNT	PR70086
3	1	PTO HOLDER ASM	PR70087
4	1	3.5" GROMMET	EL-0041
5	1	COVER PLATE, FLOW CONTROL CUTOUT	PR70131
6	1	PIN & HAIRPIN CLIP	PIN-500-575

7215-1-06 Endgate

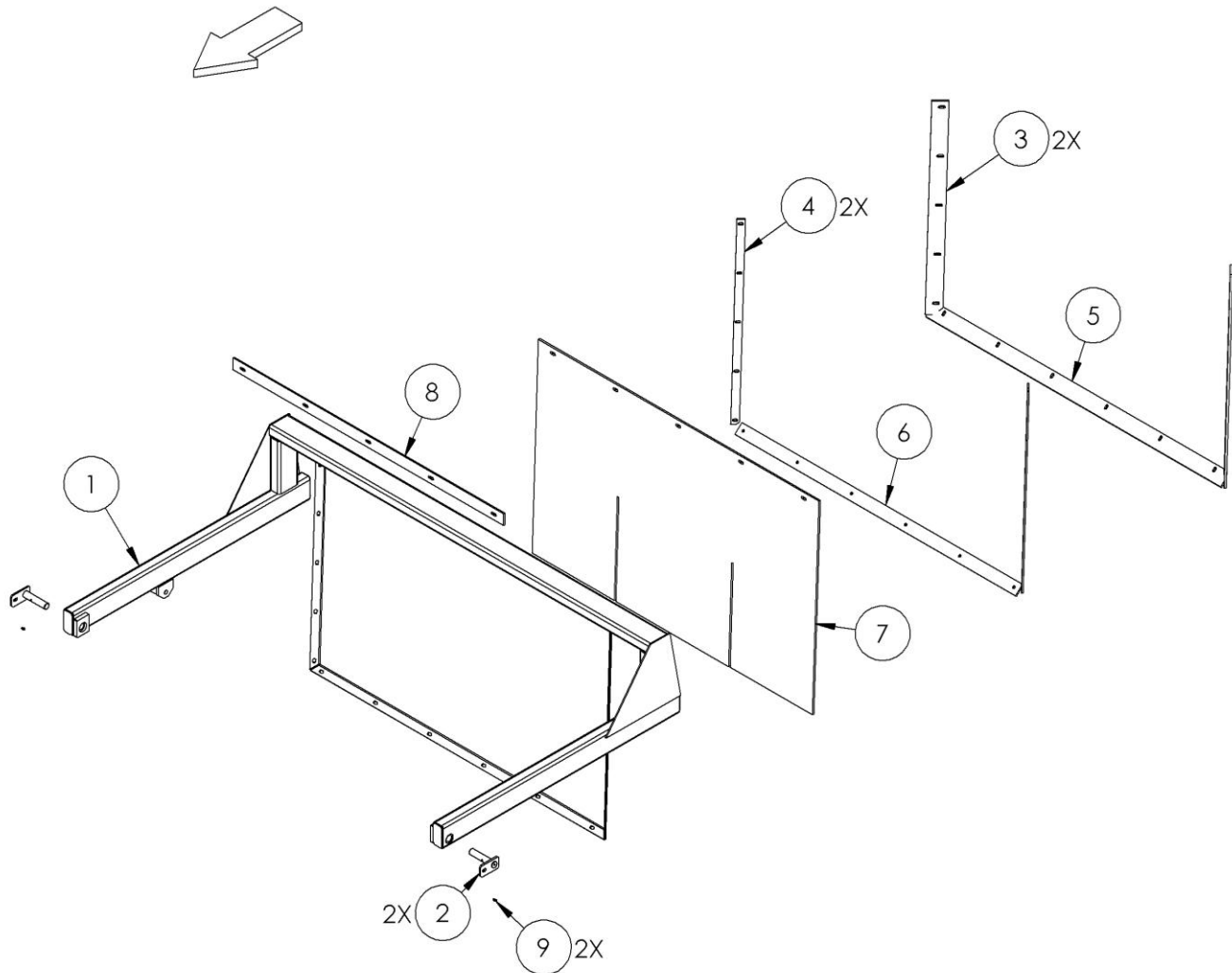

ITEM NO.	QTY	DESCRIPTION	PART NUMBER
1	1	ENDGATE WELDMENT	PR70167
2	2	HINGE PIN	PR70118
3	2	BELTING, END GATE SIDE	PR70174
4	2	BACKING BAR, BELTING	PR70175
5	1	BELTING, END GATE BOTT.	PR70176
6	1	BACKING BAR, BELTING	PR70177
7	1	ENDGATE BELTING	PR70178
8	1	BACKING BAR, BELTING	PR70179
9	2	1/4" X 28 GREASE FITTING	GF-1428

7215-1-07

Hubs & Spindles

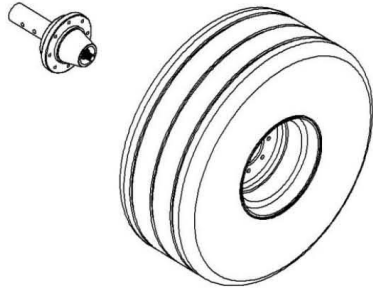

ITEM NO.	QTY	DESCRIPTION	PART NUMBER
1	2	HUB ASSEMBLY	WHL-3000
2	2	11.00-22.5 TIRE & WHEEL ASSY	WHM-7107
801	2	SPINDLE, 3" X 16"	WHL-3001
802	2	SEAL	WHL-3000G
803	2	INNER CONE	WHL-3000C
804	2	INNER CUP	WHL-3000A
805	2	OUTER CUP	WHL-3000B
806	2	OUTER CONE	WHL-3000D
807	2	SPINDLE WASHER	WHL-3000K
808	2	SPINDLE NUT	WHL-3000J
809	2	HUB CAP	WHL-3000H
810	2	COTTER PIN, 3/16 X 2"	PIN-C3-16-32
811	16	LUG NUT	WHL-3000F
812	2	22.5 X 8.25 WHEEL	WHL-7107
813	2	11-22.5 RECAPPED IMPLEMENT TIRE	WHT-7107
814	16	STUD BOLT	WHL-3000E
815	2	WHEEL BEARING KIT	WBR-3000K
816	2	1000-20 TUBE	WHT-1021

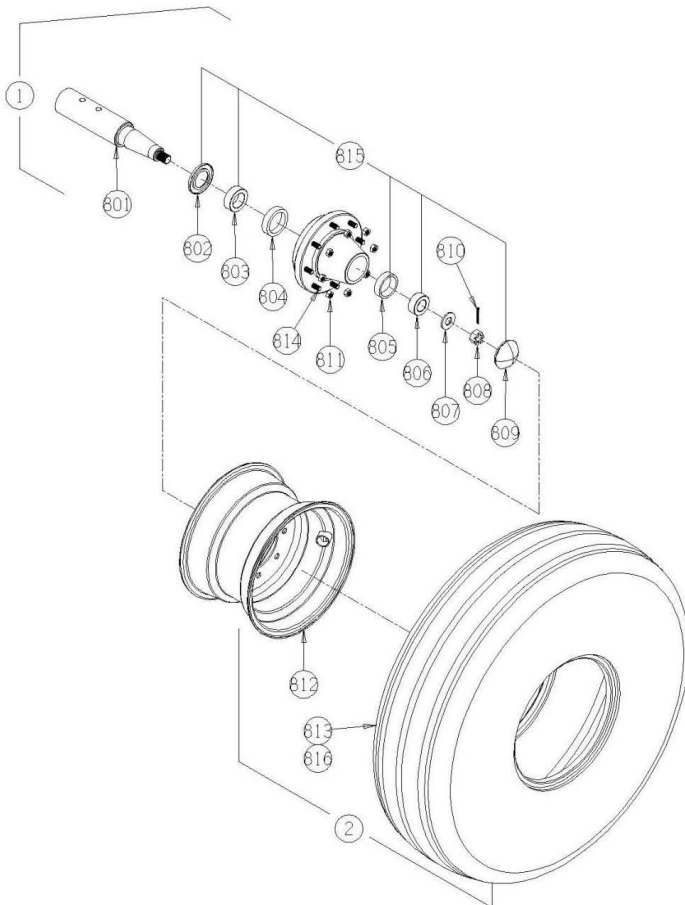

7215-1-08 Tires & Wheels, 16.5-16.1 Implement

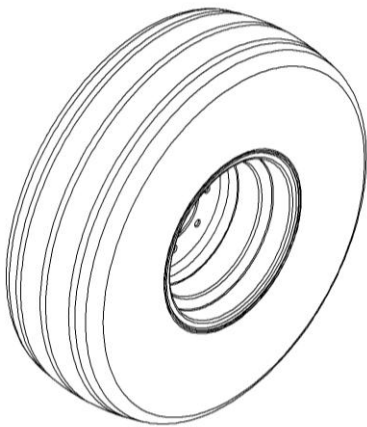

ITEM NO.	QTY	DESCRIPTION	PART NUMBER
1	4	Tire and Wheel Assembly	WHM-1514
801	4	16 X 14 WHEEL 8-8-6	WHL-1614
802	4	16.5 X 16.1 IMPLEMENT TIRE	WHT-1614

7215-1-08A Opt. Tires & Wheels, 11R-22.5 Truck Tires

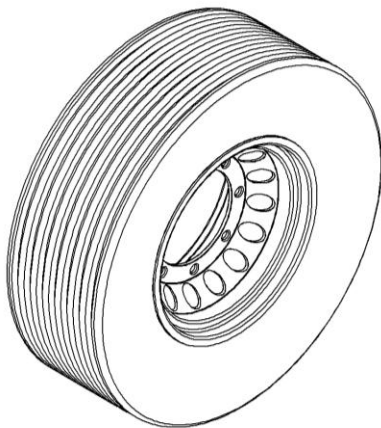

ITEM NO.	QTY	DESCRIPTION	PART NUMBER
1	4	11.00 X 22.5 TIRE & WHEEL ASSEMBLY	WHM-7107
801	4	22.5 X 8.25 WHEEL - 8-8-6 - 3/8" POSITIVE OFFSET	WHL-7107
802	4	11-22.5 IMPLEMENT TIRE	WHT-7107

7215-1-08B

Opt. Tires & Wheels, 385/65R22.5 Truck

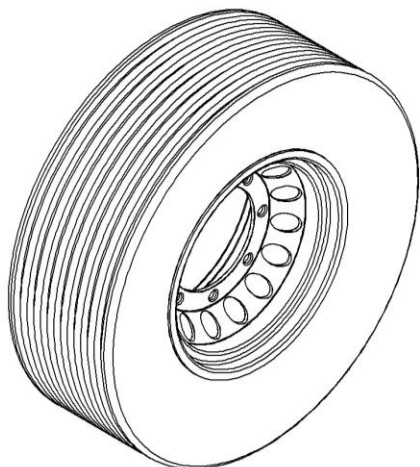

ITEM NO.	QTY	DESCRIPTION	PART NUMBER
1	4	385/65R22.5 TIRE & WHEEL ASSY	WHM-7106
801	4	22.5 X 11.75 WHEEL	WHL-7106
802	4	385/65R22.5 TRUCK TIRE	WHT-7106

7215-1-08C

Opt. Tires & Wheels, 425/65R22.5 Truck Tires

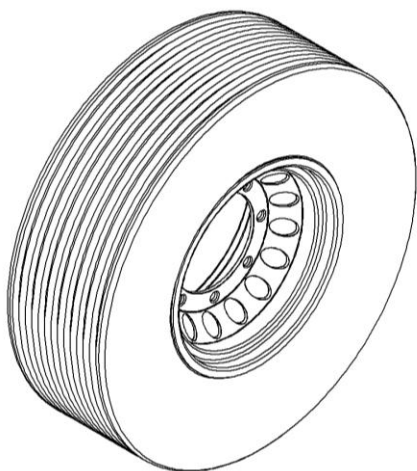

ITEM NO.	QTY	DESCRIPTION	PART NUMBER
1	4	425/65R22.5 TIRE & WHEEL ASSY	WHM-7109
801	4	425/65R22.5 TRUCK TIRE	WHT-7105
802	4	22.5 X 11.75 WHEEL	WHL-7106

7215-1-11

Opt. Side Extensions

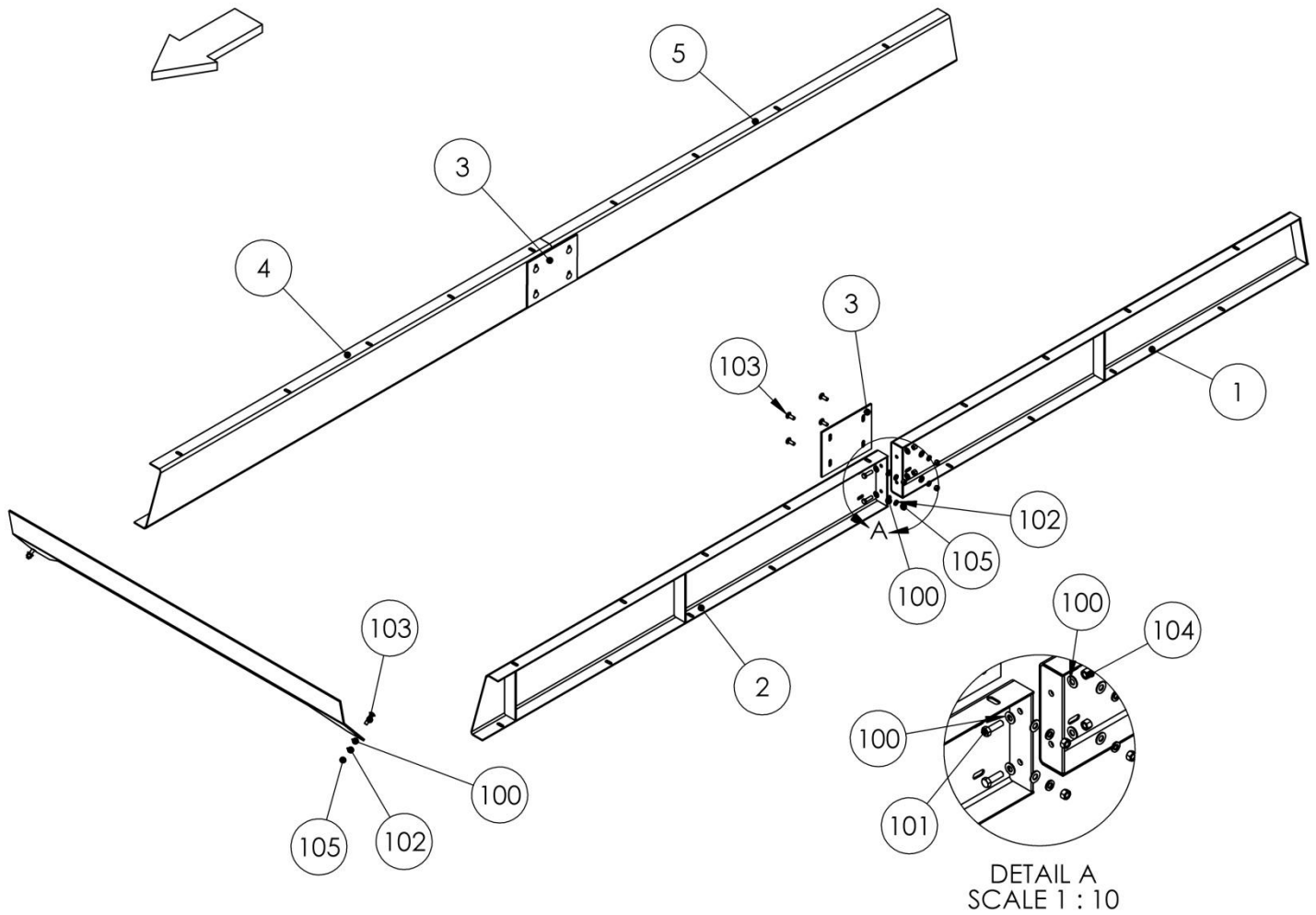

ITEM NO.	EXPLODED/QTY.	DESCRIPTION	PART NUMBER
1	1	SIDE EXTENSION, LH REAR	PR70399
2	1	SIDE EXTENSION, LH FRONT	PR70398
3	2	SPLICE PLATE	PR70400
4	1	SIDE EXTENSION, RH FRONT	PR70401
5	1	SIDE EXTENSION, RH REAR	PR70402
6	1	FORMED SHEET	PR70203
100	17	3/8 SAE FW ZC	BL-6-SW
101	4	3/8-16 X 1-1/4 HHCS G5 ZC	BL-6-125-H
102	10	3/8 SPLIT LW ZC	BL-6-LW
103	10	3/8-16 X 1-1/2 CARRIAGE BOLT G5 ZC	BL-6-150-C
104	13	3/8-16 FIN H LN NE A563 GA ZC	BL-6-LN
105	10	3/8-16 HEX NUT ZC	BL-6-N
106	9	3/8-16 x 1-1/2 HEX CAP G5 ZC	BL-6-150-H
107	9	3/8 FW, LG. OD, G8	BL-6-FW-USS8

7215-1-12

Opt. Rock Guard

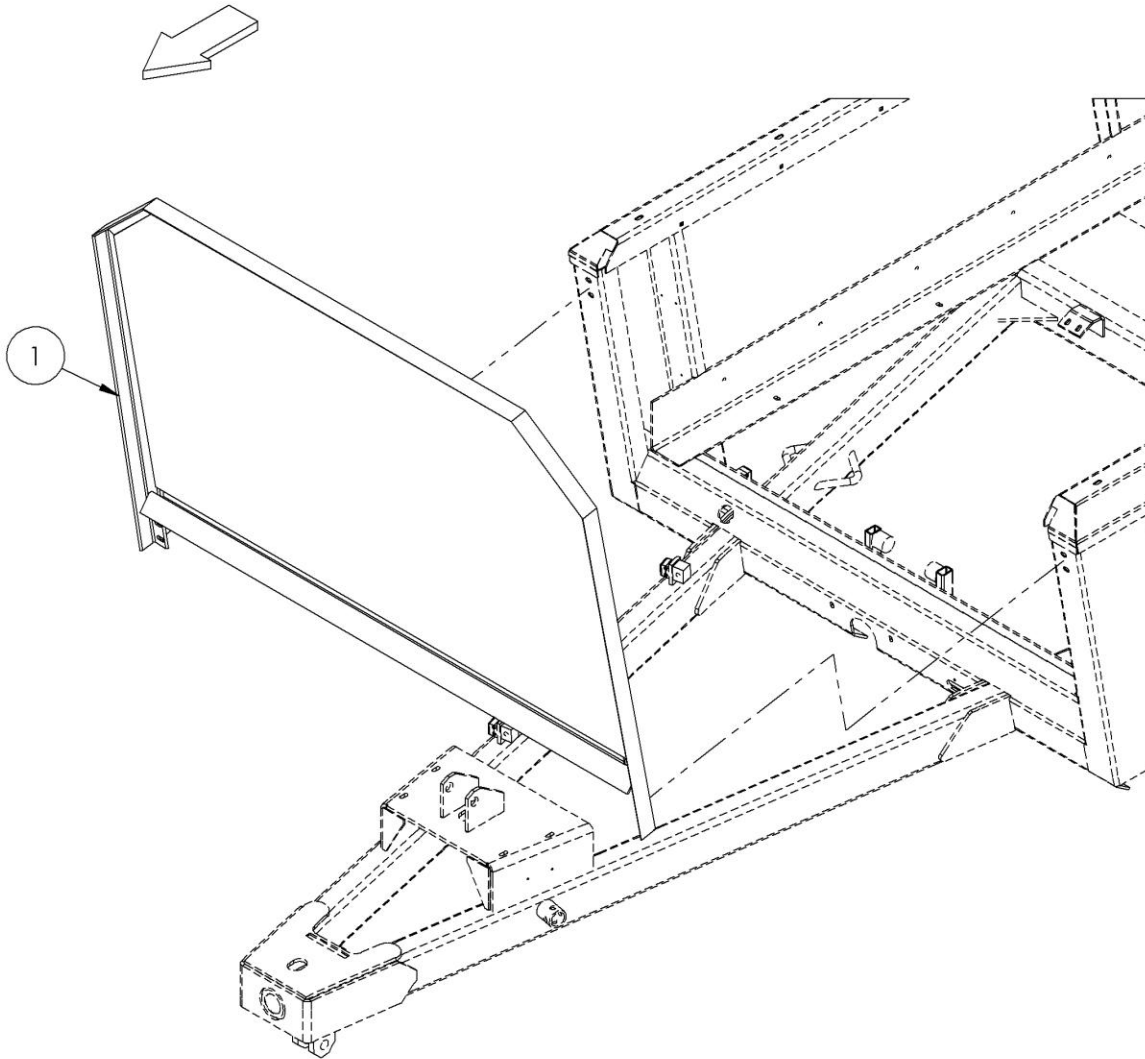

ITEM NO.	QTY	DESCRIPTION	PART NUMBER
1	1	ROCK GUARD	PR70200

7215-2-01

Driveline, Front, 540 rpm 1-3/8" CV

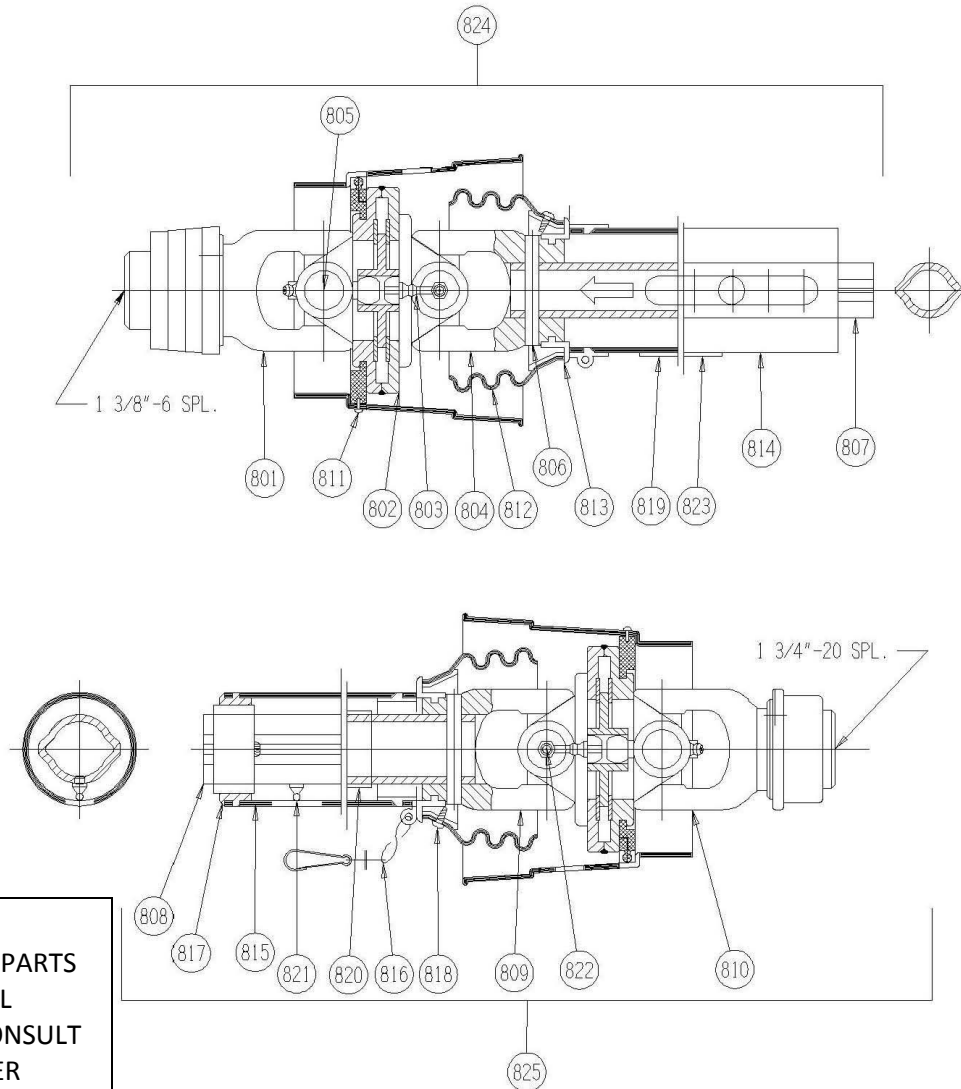

NOTE:
MANY OF THESE PARTS
ARE SPECIAL
ORDER ONLY. CONSULT
YOUR DEALER
FOR AVAILABILITY

ITEM NO.	QTY .	DESCRIPTION	PART NUMBER
1	1	DRIVELINE, 540 rpm, FRONT	PTS-1012
801	1	YOKE ASGE	PTS-1015A
802	2	DOUBLE YOKE	PTS-1008B
803	2	ZERK - IN ITEM 2	PTS-1017C
804	1	INBOARD YOKE 1b	PTS-1008D
805	1	CROSS & BEARING KIT	PTS-1008E
806	2	SPRING PIN	PTS-1010C
807	1	INNER PROFILE, 1bGA	PTS-1008F
809	1	INBOARD YOKE, 2a	PTS-1008H
810	1	YOKE, 1 3/4"-20 SPLINE	PTS-1008J
811	2	CV GUARD & BEARING ASSY	PTS-1008K
812	2	GUARD CONE, 3 RIB	PTS-1008L

ITEM NO.	QTY .	DESCRIPTION	PART NUMBER
813	2	PTO SHIELD BEARING RING	PTS-1009-CMP2
816	1	PTO SHIELD SAFETY CHAIN	PTS-1002K
817	1	SUPPORT BEARING	PTS-1010N
818	14	SCREW	PTS-1010K
819	1	DECAL, OUTER	PTS-1010L
820	1	DECAL, INNER	PTS-1010M
821	1	ZERK	PTB-1014L
822	2	CROSS BEARING & KIT	PTS-1008P
823	1	SUPPORT BEARING	PTS-1021H
823	1	LUBRICATION DECAL	PTS-1008Q
824	1	FRONT, HALF SHAFT	PTS-1012-FH
825	1	REAR, HALF SHAFT	PTS-1008-RH

7215-2-02

Driveline, Rear, w/ Clutch

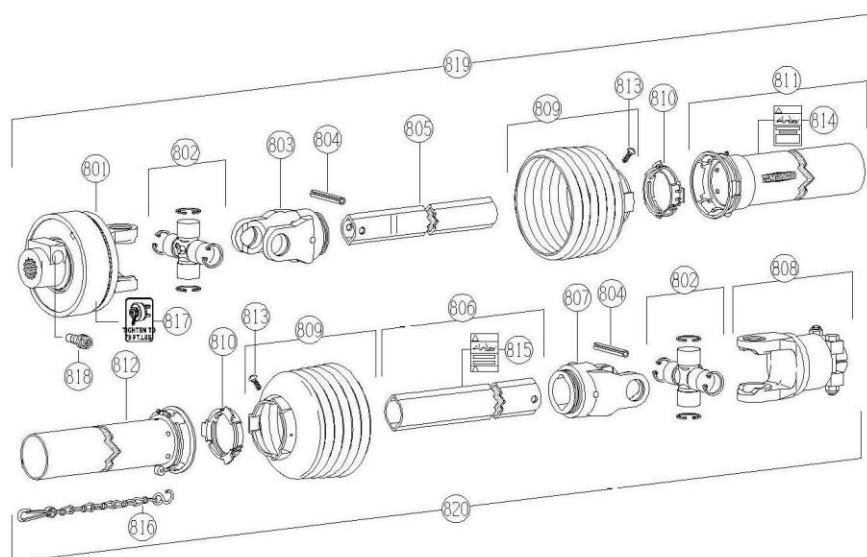

NOTE:
MANY OF THESE PARTS
ARE SPECIAL ORDER
ONLY. CONSULT YOUR
DEALER FOR
AVAILABILITY

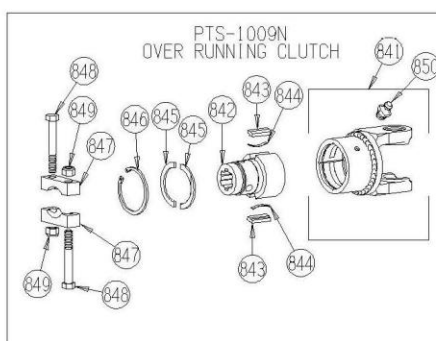
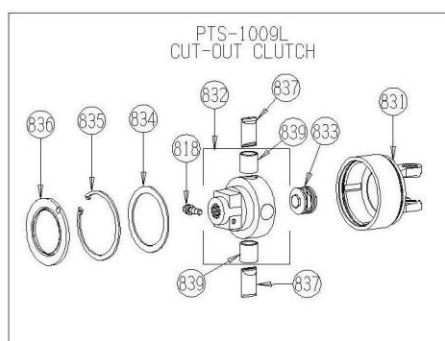

ITEM NO.	QTY	DESCRIPTION	PART NUMBER
1	1	DRIVELINE FOR VERTICALS, REAR	PTS-1009
801	1	CUT-OUT CLUTCH	PTS-1009L
802	2	CROSS & BEARING KIT	PTS-1010B
803	1	INBOARD YOKE, 1b	PTS-1009B
804	2	SPRING PIN	PTS-1010C
805	1	INNER PROFILE	PTS-1014E
806	1	OUTER PROFILE	PTS-1009M
807	1	INBOARD YOKE	PTS-1010D
808	1	OVER RUNNING CLUTCH	PTS-1009N
809	2	SHIELD CONE 6 RIB	PTS-1014I
810	2	PTO SHIELD BEARING RING	PTS-1002J
811	1	GUARD TUBE OUTER	PTS-1009P
812	1	GUARD TUBE INNER	PTS-1009Q
813	2	SCREW	PTS-1010K
814	1	DECAL, OUTER	PTS-1010L
815	1	DECAL, INNER	PTS-1010M
816	1	PTO SHIELD SAFETY CHAIN	PTS-1002K
817	1	DECAL	PTS-1009J
818	1	CC LOCK ASSEMBLY	PTS-1009K

ITEM NO.	QTY	DESCRIPTION	PART NUMBER
819	1	FRONT, HALF SHAFT	PTS-1009-FH
820	1	REAR, HALF SHAFT	PTS-1009-RH
831	1	HOUSING	PTS-1009E-B
832	1	HUB 1-3/4"-20 SPL CC	PTS-1009E-C
833	1	SPRING PACK	PTS-1009E-D
834	1	WASHER	PTS-1009E-E
835	1	RETAINING RING	PTS-1009E-F
836	1	SEALING RING	PTS-1009E-G
838	2	CAM	PTS-1009E-A
839	2	BUSHING - IN PART PTS-1009E-C	PTS-1009E-H
841	1	CLUTCH HOUSING	PTS-1020A-A
842	1	HUB	PTS-1009N-A
843	2	KEY	PTS-1010F-A
844	2	LEAF SPRING	PTS-1010F-B
845	1	SUPPORTING RING	PTS-1009N-B
846	1	RETAINING RING	PTS-1010F-G
847	2	CLAMP BRIDGE	PTS-1009N-C
848	2	HEX BOLT - M16 X 110L	PTS-1009N-D
849	2	LOCKNUT - M16	PTS-1009N-E
850	1	ZERK, DOUBLE YOKE	PTS-1008C

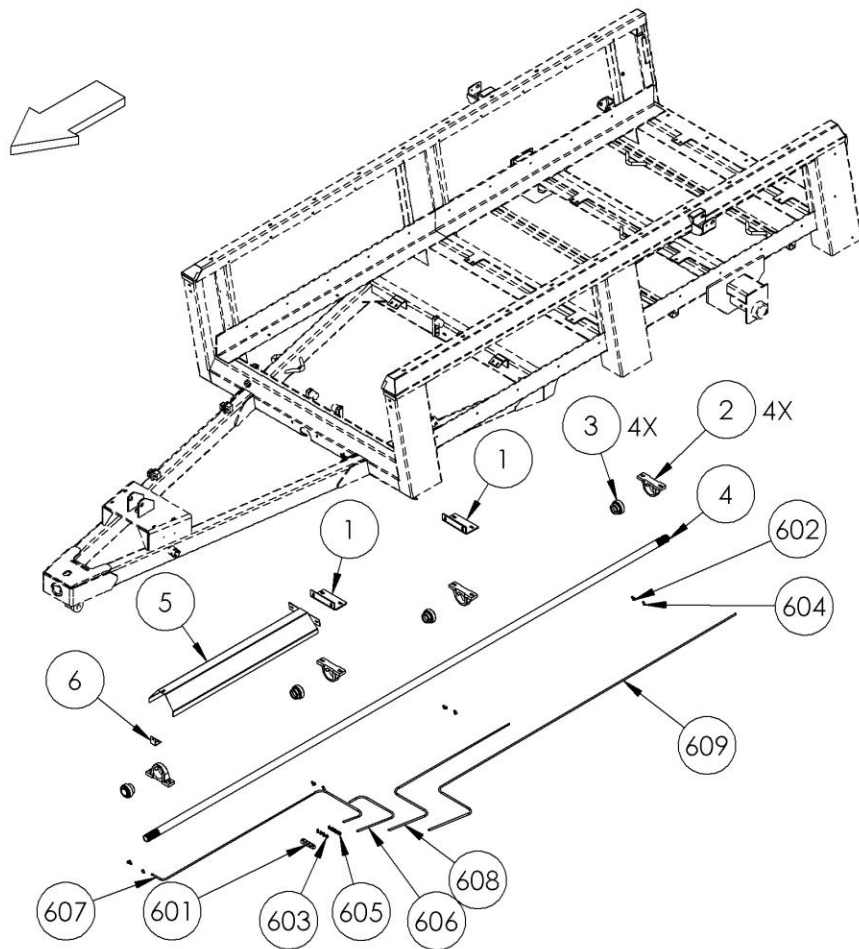

ITEM NO.	QTY	DESCRIPTION	PART NUMBER
1	2	BEARING MOUNT	PR70141
2	4	BEARING HOUSING	BR-085-RAK
3	4	1.75" BEARING	BR-175-085-I
4	1	MAIN DRIVE SHAFT	PR38261
5	1	SHIELD, MAIN DRIVE SHAFT	PR70180
6	1	HANGER, DRIVE SHAFT SHEILD	PR70181
601	1	4" GREASE MANIFOLD	GF-4-4
602	4	1/8MP X 1/8 FPX 90°	A-1501-2-2
603	4	GREASE FITTING 1/8NPT	GF-1827
604	4	1/4"-28 X 1/8" FNPT ADAPTER	GFA-51942
605	4	1/8 MP X 1/8 FPX 45°	A-1503-2-2
606	1	1/8" HOSE X 1/8MP X 1/8MP X 14"	H2-14-2MP-2MP
607	1	1/8" HOSE X 1/8MP X 1/8MP X 52"	H2-52-2MP-2MP
608	1	1/8" HOSE X 1/8MP X 1/8MP X 74"	H2-74-2MP-2MP
609	1	1/8" HOSE X 1/8MP X 1/8MP X 122"	H2-122-2MP-2MP
610	5	HYDRAULIC HOSE HOLDER	HA-1031
611	12	WIRE TIE, 11"	WT-11

ITEM NO.	QTY	DESCRIPTION	PART NUMBER
1	1	GEARBOX, 540 RPM	VTB-1879-A1
2	1	BEATER PANEL, LH	PR70151
3	1	BEATER PANEL, RH	PR70152
4	1	VERTICAL BEATER, LH	VTB-0003
5	1	VERTICAL BEATER, RH	VTB-0004
6	1	BEARING PLATE	PR70168
7	1	BEATER PAN	PR70150
8	2	MOUNT, BEATER PAN	PR70085
9	1	BEARING COVER	PR70169
10	2	HINGE PIN	PR70133
11	2	ROLL PIN	PIN-3-14
12	30	BALANCED BEATER KNIFE	VTB-1899-F3
13	6	BEATER BLADE, RH	VTB-1899-B3

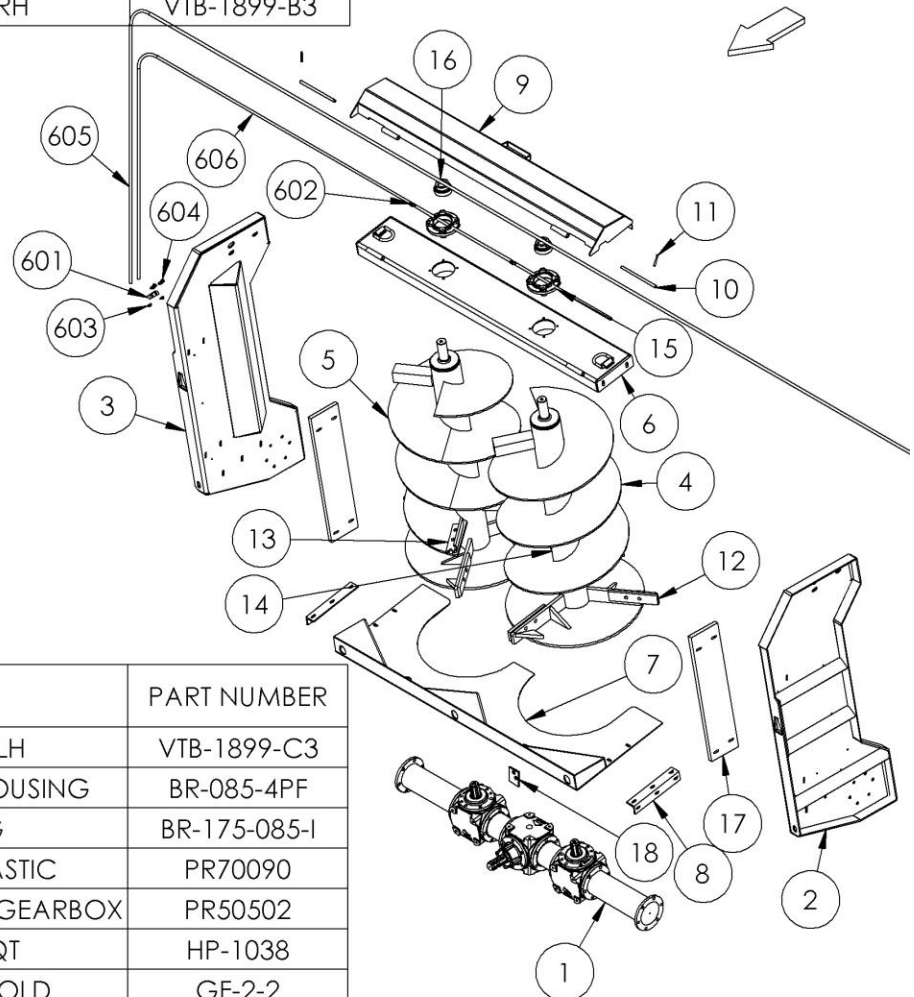

ITEM NO.	QTY	DESCRIPTION	PART NUMBER
14	6	BEATER BLADE, LH	VTB-1899-C3
15	2	FLANGE BEARING HOUSING	BR-085-4PF
16	2	1.75" BEARING	BR-175-085-I
17	2	BEATER PANEL PLASTIC	PR70090
18	1	SHIM, BOTTOM PANEL, GEARBOX	PR50502
19	11	GEAR LUBE @ QT	HP-1038
601	1	2" GREASE MANIFOLD	GF-2-2
602	2	1/8 MP X 1/8 FPX	A-1404-2-2
603	2	GREASE FITTING 1/8NPT	GF-1827
604	2	1/8 MP X 1/8 FPX 45°	A-1503-2-2
605	1	1/8" HOSE, 1/8"MP X 1/8"MP X 67"	H2-67-2MP-2MP
606	1	1/8" HOSE, 1/8"MP X 1/8"MP X 34"	H2-38-2MP-2MP

7215-2-04LP

Vertical Beaters w/ Gearbox, Low Pro

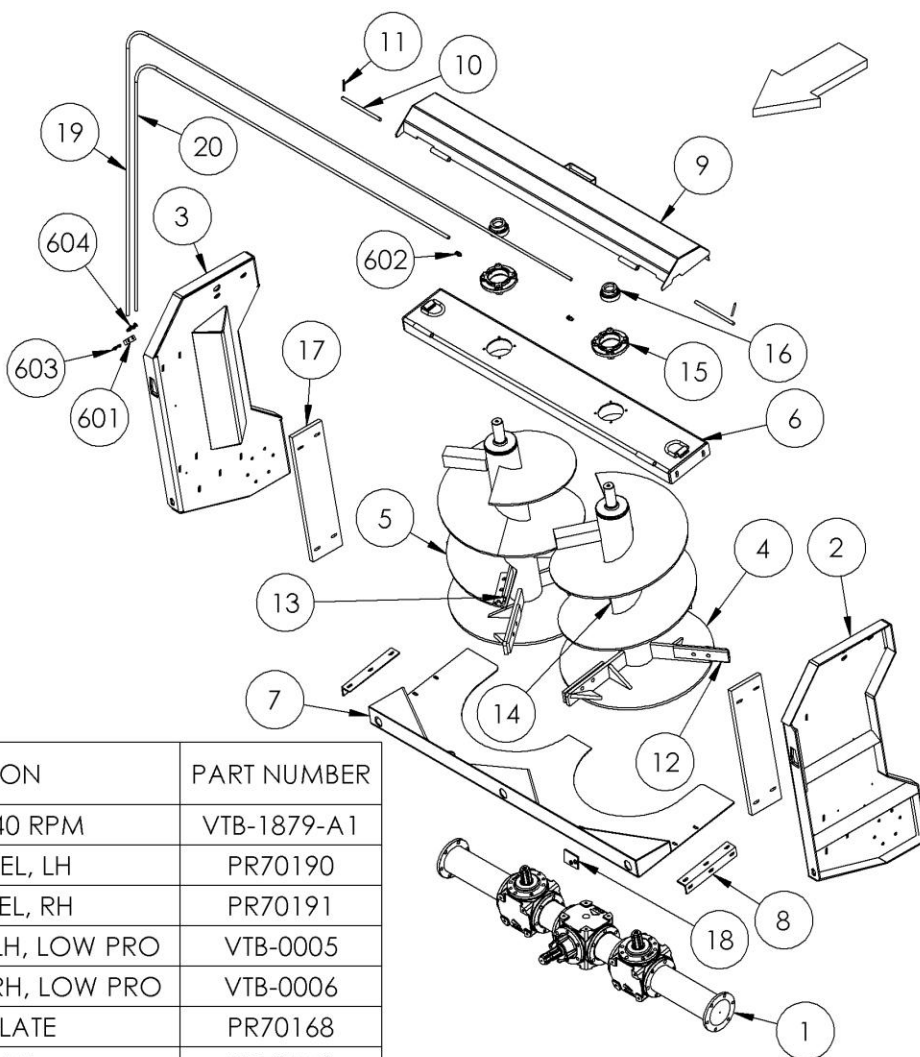

ITEM NO.	QTY	DESCRIPTION	PART NUMBER
1	1	GEARBOX, 540 RPM	VTB-1879-A1
2	1	BEATER PANEL, LH	PR70190
3	1	BEATER PANEL, RH	PR70191
4	1	VERTICAL BEATER, LH, LOW PRO	VTB-0005
5	1	VERTICAL BEATER, RH, LOW PRO	VTB-0006
6	1	BEARING PLATE	PR70168
7	1	BEATER PAN	PR70150
8	2	MOUNT, BEATER PAN	PR70085
9	1	BEARING COVER	PR70169
10	2	HINGE PIN	PR70133
11	2	ROLL PIN	PIN-3-14
12	24	BALANCED BEATER KNIFE	VTB-1899-F3
13	5	BEATER BLADE, RH	VTB-1899-B3
14	5	BEATER BLADE, LH	VTB-1899-C3
15	2	FLANGE BEARING HOUSING	BR-085-4PF
16	2	1.75" BEARING	BR-175-085-I
17	2	SPACER, BEATER PANEL	PR70192
18	1	SHIM, BOTTOM PANEL, GEARBOX	PR50502
19	1	1/8" HOSE, 1/8"MP X 1/8"MP X 67"	H2-56-2MP-2MP
20	1	1/8" HOSE, 1/8"MP X 1/8"MP X 34"	H2-23-2MP-2MP
601	1	2" GREASE MANIFOLD	GF-2-2
602	2	1/8 MP X 1/8 FPX	A-1404-2-2
603	2	GREASE FITTING 1/8NPT	GF-1827
604	2	1/8 MP X 1/8 FPX 45°	A-1503-2-2

NOTE:
MANY OF THESE PARTS
ARE SPECIAL ORDER
ONLY. CONSULT YOUR
DEALER FOR
AVAILABILITY

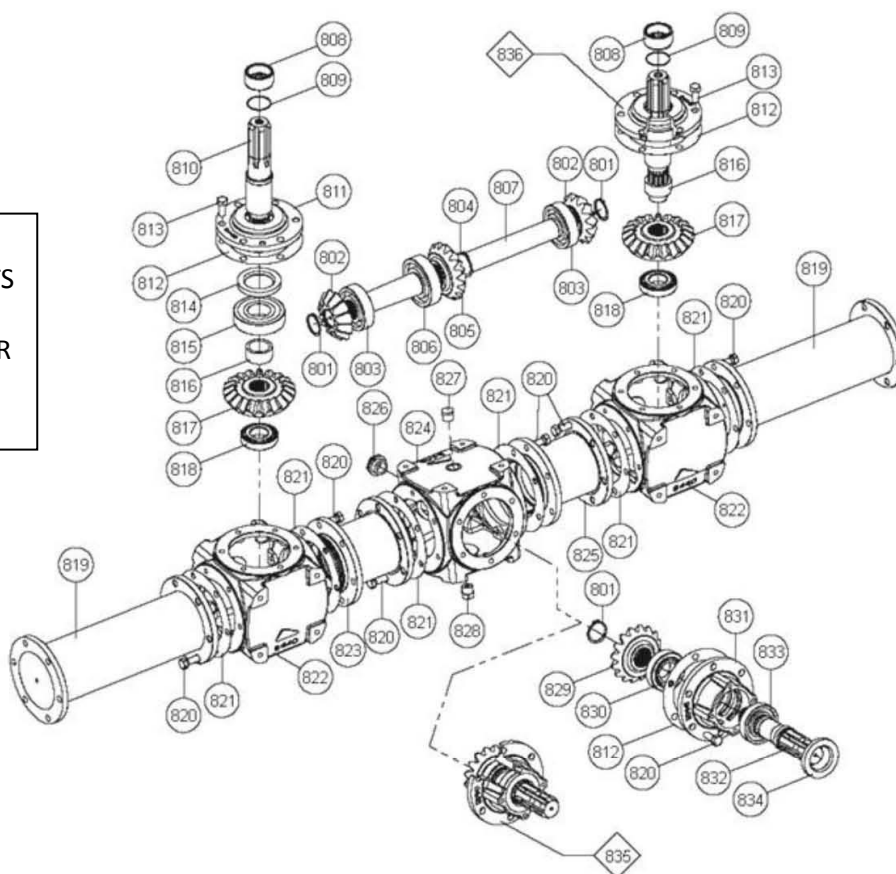

ITEM NO.	QTY	DESCRIPTION	PART NUMBER
1	0	GEARBOX ASSY	VTB-1879-A1
801	3	CIRCLIP E 40	VTB-1879-B1
802	2	PINION Z=13	VTB-1879-C1
803	2	BEARING 6308	VTB-1879-D1
804	1	SNAP RING, E 45	GBX-5-ST10-R
805	1	PINION Z=16	VTB-1879-E1
806	1	BEARING 6309	VTB-1879-F1
807	1	SHAFT	VTB-1879-G1
808	2	SPACER	VTB-1879-H1
809	2	O-RING 2175	VTB-1879-I1
810	2	SHAFT	VTB-1879-J1
811	2	CALOTTE	VTB-1879-K1
812	3	GASKET	VTB-1879-L1
813	12	SCREW, HEX-HD M12X30	VTB-1879-M1
814	2	OIL SEAL	VTB-1899-K2
815	2	BEARING 6309-2RS	VTB-1879-N1
816	2	SPACER 40/51/25	VTB-1879-O1
817	2	GEAR Z=20	VTB-1879-P1
818	2	BEARING 30207	VTB-1879-Q1

ITEM NO.	QTY	DESCRIPTION	PART NUMBER
819	2	SPACER	VTB-1879-R1
820	42	SCREW, HEX-HD M12X35	VTB-1879-S1
821	6	GASKET	VTB-1879-T1
822	2	HOUSING	VTB-1879-U1
823	1	SPACER L=134.65	VTB-1879-V1
824	1	HOUSING	VTB-1879-W1
825	1	SPACER L=134.65	VTB-1879-X1
826	1	OIL LEV. INDICATOR	VTB-1879-Y1
827	1	PLUG, 1/2" GAS	VTB-1879-Z1
828	1	OIL PLUG, 1/2" GAS	VTB-1899-D2
829	1	PINION Z=16	VTB-1879-A2
830	1	BEARING 32208	VTB-1879-B2
831	1	HUB	VTB-1879-C2
832	1	SHAFT	VTB-1879-D2
833	1	BEARING 6208	VTB-1879-E2
834	1	OIL SEAL 48/80/10	VTB-1879-F2
835	1	HUB COMPLETE	VTB-1879-G2
836	2	CALOTTE COMPLETE	VTB-1879-H2

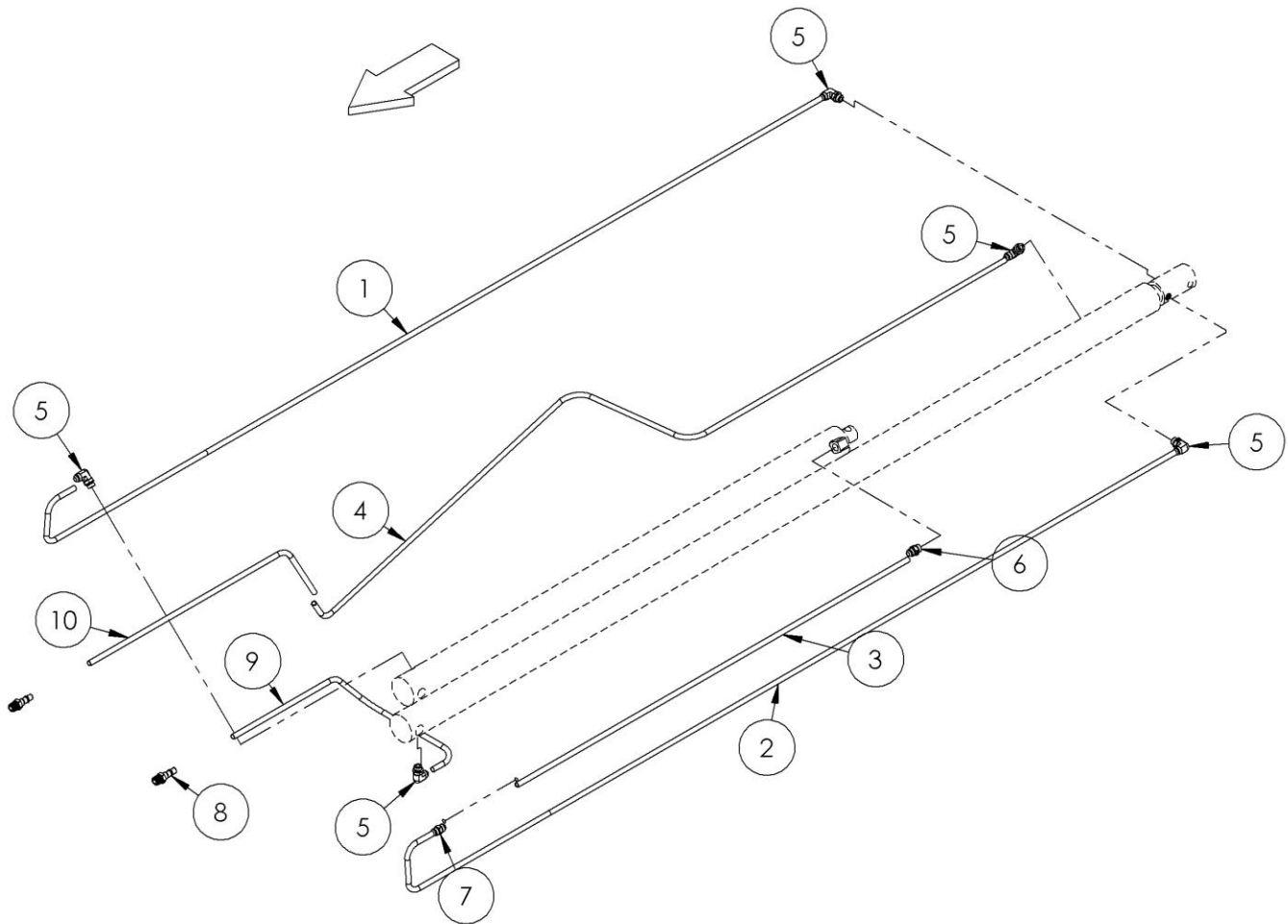

ITEM NO.	QTY	DESCRIPTION	PART NUMBER
1	1	1/2" SS TUBE, PUSHER EXTEND	H-T7050
2	1	1/2" SS TUBE, PUSHER RETRACT	H-T7051
3	1	1/2" SS TUBE, PUSHER RETRACT	H-T7052
4	1	1/2" SS TUBE, SLIDING FLOOR	H-T7055
5	5	ELBOW, 1/2" MJ X 8 SAE	A-6801-8-8
6	1	1/2" MJIC X 8 SAE	A-6400-8-8
7	1	1/2" JIC MALE UNION	A-2403-8-8
8	2	1/2" QUICK COUPLER	A-QD-2000-8-8
9	1	1/2" HOSE, 1/2"MP X 1/2"MJ X 100"	H8-100-8MP-8FJ
10	1	1/2" HOSE, 1/2"MP X 1/2"MJ X 94"	H8-94-8MP-8MJ
11	5	HYTRAN @ GAL.	HY-TRAN

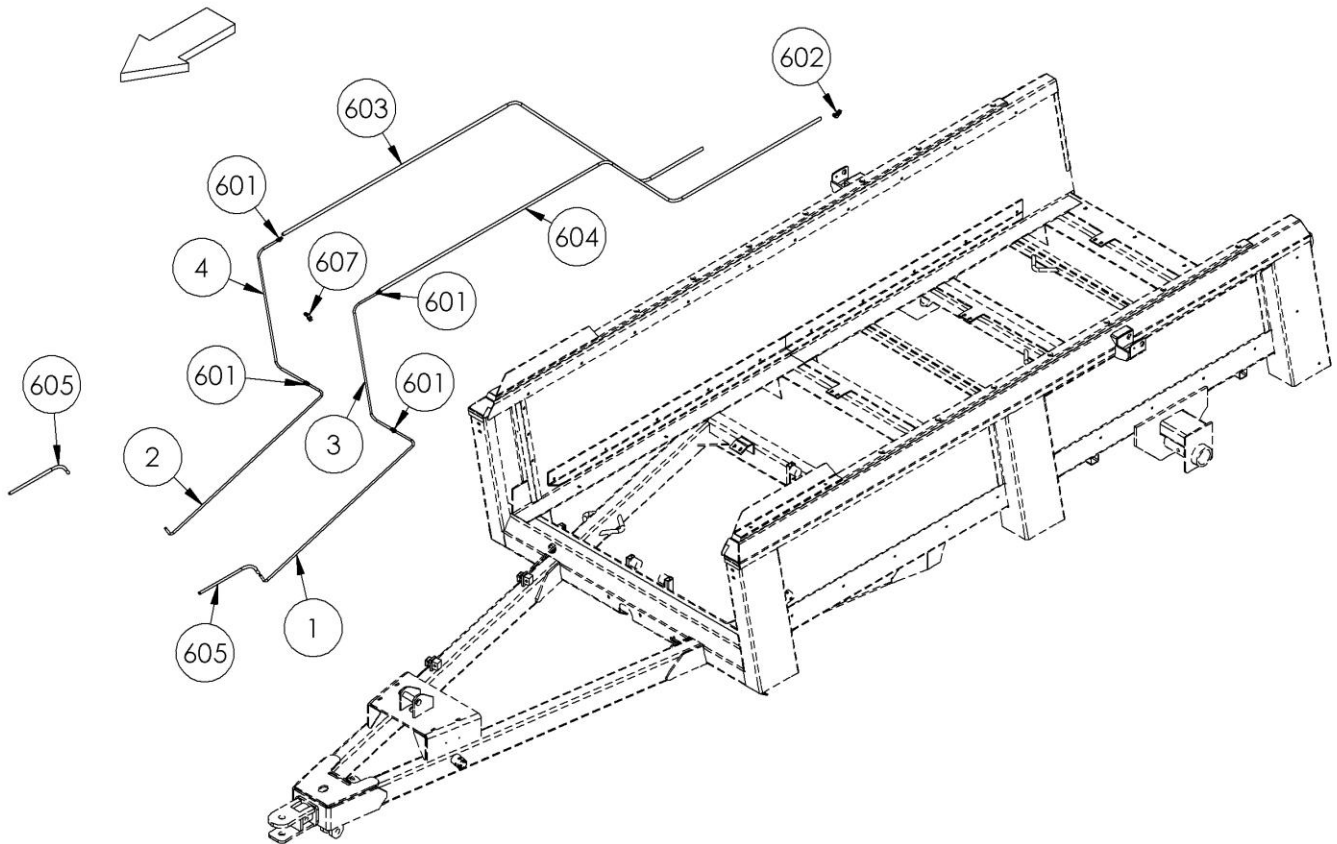

ITEM NO.	QTY	DESCRIPTION	PART NUMBER
1	1	3/8" SS TUBE, ENDGATE TOP	H-T7053
2	1	3/8" SS TUBE, ENDGATE BOTT	H-T7054
3	1	3/8" SS TUBE, ENDGATE	H-T7056
4	1	3/8" SS TUBE, ENDGATE	H-T7057
5	2	OIL LINE	H-T7018
601	4	UNION, 3/8" MJ X 3/8" MJ	A-2403-6-6
602	1	ELBOW, 3/8" MJ X 3/8" SAE	A-6801-6
603	1	1/4" HOSE, 3/8" FJ X 3/8" MJ X 33"	H4-33-6FJ-6MJ
604	1	1/4" HOSE, 3/8" FJ X 3/8" MJ X 59"	H4-59-6FJ-6MJ
605	2	1/4" HOSE, 1/2" MP X 3/8" MJ X 94"	H4-94-8MP-6MJ
606	2	1/2" QUICK COUPLER	A-QD-2000-8-8
607	1	ELBOW, 45°, 3/8 MJ x 6 SAE	A-6802-06

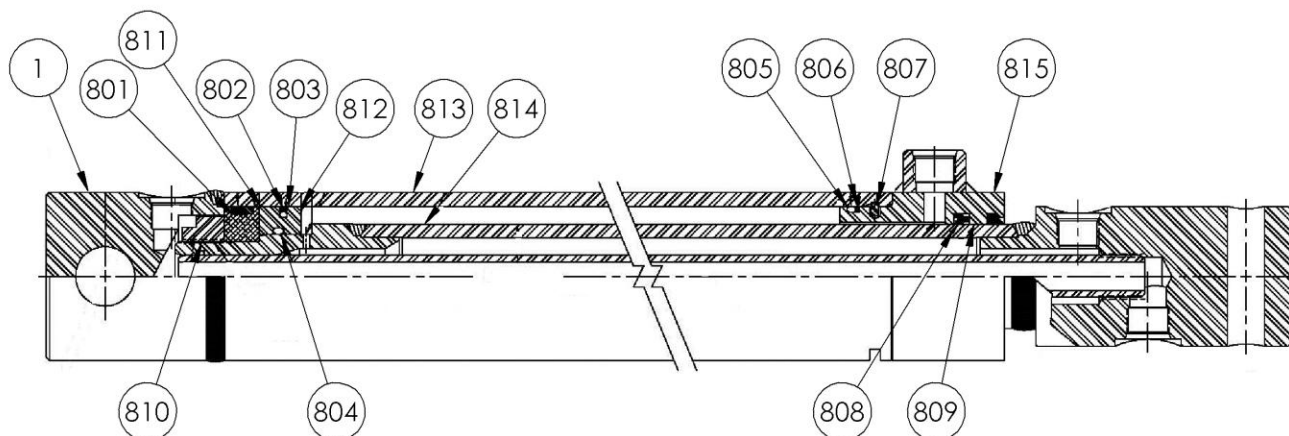

816 SEAL KIT

NOTE:
MANY OF THESE PARTS ARE SPECIAL
ORDER ONLY. CONSULT YOUR DEALER
FOR AVAILABILITY

ITEM NO.	QTY	DESCRIPTION	PART NUMBER
1	1	MAIN CYLINDER	PR24703
801	1	WEAR RING	PR24701-B
802	1	POLY HONE	PR24701-C
803	1	O-RING	PR24701-D
804	1	O-RING	PR24701-E
805	1	O-RING	PR24701-F
806	1	BACKUP RING	PR24701-G
807	1	WIRE RETAINING RING	PR24701-H
808	1	LOADED U-CUP	PR24701-I
809	1	ROD WIPER	PR24701-J
810	1	LOCKNUT - THIN	PR24701-K
811	1	PISTON	PR24701-L
812	1	PISTON	PR24701-M
813	1	BARREL ASSY	PR24701-N
814	1	ROD ASSY	PR24701-O
815	1	HEAD ASSY	PR24701-P
816	1	SEAL KIT, MAIN CYL.	PR24701-SK

7215-3-04

Cylinder, Pusher

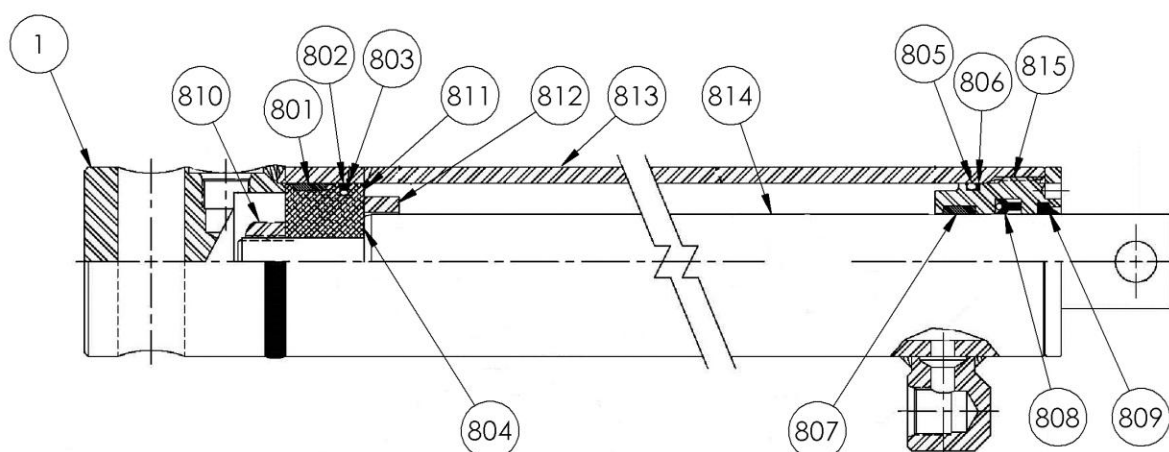

816 SEAL KIT

NOTE:
MANY OF THESE PARTS
ARE SPECIAL ORDER
ONLY. CONSULT YOUR
DEALER FOR AVAILABILITY

ITEM NO.	QTY	DESCRIPTION	PART NUMBER
1	1	SECONDARY CYLINDER	PR24704
801	1	WEAR RING	PR24702-A
802	1	POLY HONE	PR24701-C
803	1	O-RING	PR24701-D
804	1	O-RING	PR24702-B
805	1	O-RING	PR24702-C
806	1	BACKUP RING	PR24701-G
807	1	WEAR RING	PR24702-D
808	1	LOADED U-CUP	PR24702-E
809	1	ROD WIPER	PR24702-F
810	1	LOCKNUT	PR24702-G
811	1	PISTON	PR24702-H
812	1	SPACER	PR24704-A
813	1	BARREL ASSY	PR24704-B
814	1	ROD	PR24704-C
815	1	INTERNAL HEAD	PR24702-L
816	1	SEAL KIT	PR24704-SK

7215-3-05

Cylinder, Endgate

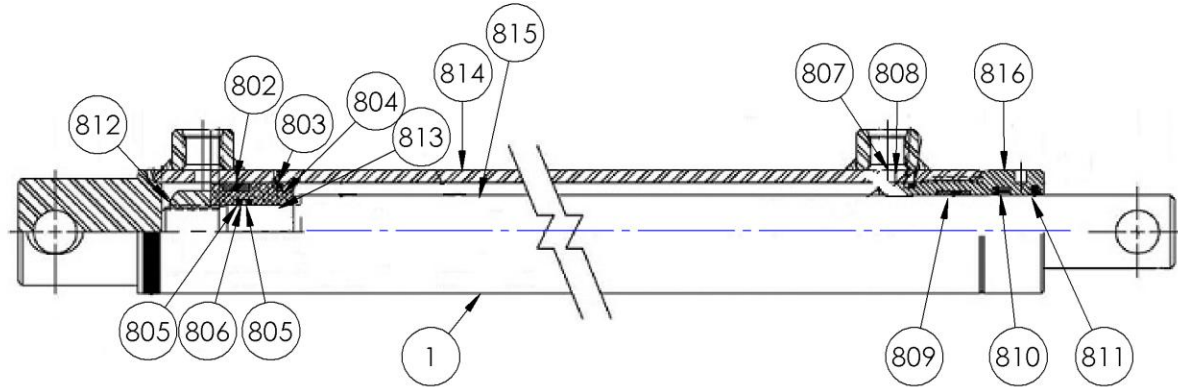

817 SEAL KIT

NOTE:
MANY OF THESE PARTS ARE SPECIAL
ORDER ONLY. CONSULT YOUR DEALER
FOR AVAILABILITY

ITEM NO	QTY	DESCRIPTION	PART NUMBER
1	2	CYLINDER, ENDGATE, 1.5 BORE	PR39068
802	1	WEAR RING	PR39068-A
803	1	TFE SEAL	PR39068-B
804	1	O RING	PR39068-C
805	2	BACK-UP RING	PR39068-D
806	1	O RING	PR39068-E
807	1	O RING	PR39068-F
808	1	BACK-UP RING	PR39068-G
809	1	WEAR RING	PR39068-H
810	1	LOADED U-CUP	PR39068-I
811	1	ROD WIPER	PR39068-J
812	1	LOCKNUT	PR39068-K
813	1	PISTON	PR39068-L
814	1	BARREL ASSEMBLY	PR39068-M
815	1	ROD	PR39068-N
816	1	INTERNAL CYL. HEAD, 1-1/2" (FINE)	PR39068-OB
817	1	SEAL KIT, ENDGATE CYL., PER EACH	PR39068-SK

7215-3-06

Opt. Control Valve, Open Center

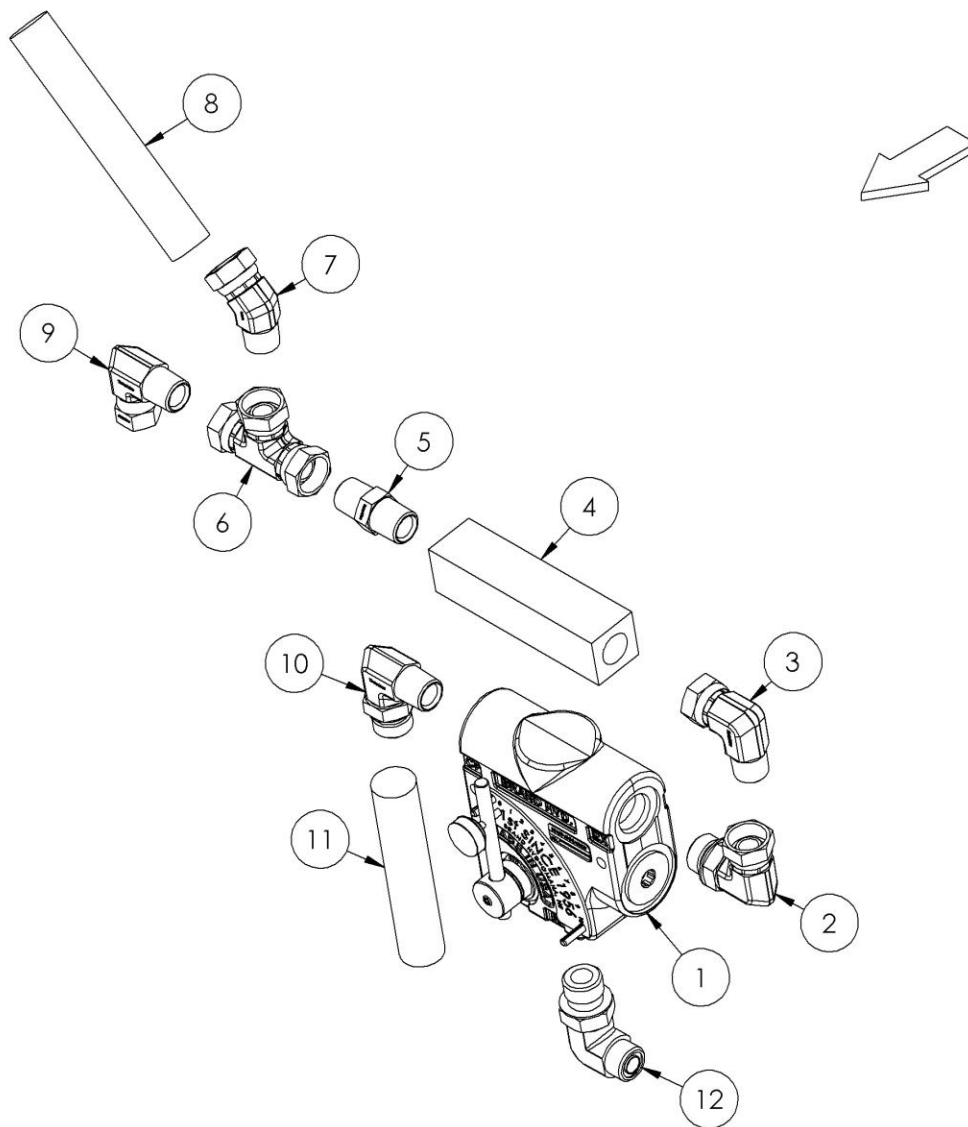

ITEM NO.	QTY	DESCRIPTION	PART NUMBER
1	1	FLOW CONTROL	HV-FC5510
2	1	10 SAE X 1/2 FFX90°, FORGED	A-6901-10-8
3	1	ELBOW 1/2 MP X 1/2 FFX90°	A-1501-8-8
4	1	1/2" PARKER CHECK VALVE	HV-CKV-800S
5	1	HEX NIPPLE 1/2" X 1/2"	A-5404-8-8
6	1	SWIVEL T 1/2" NPTF	A-1603-8-8-8
7	1	ELBOW 1/2 MP X 1/2 FP X 45°	A-1503-8-8
8	1	1/2" HOSE 1/2MP X 1/2MJ X 16" L	H8-16-8MP-8MJ
9	1	ELBOW 1/2 MP X 1/2 FJX	A-6501-8-8
10	1	10 SAE X 1/2" MP 90°	A-6806-10-8
11	1	1/2" HOSE 1/2MP X 1/2FJIC X 27" L	H8-27-8MP-8FJ
12	1	ELBOW 1/2 MJ X 10 SAE	A-6801-8-10

7215-3-07

Opt. Remote Flow Control

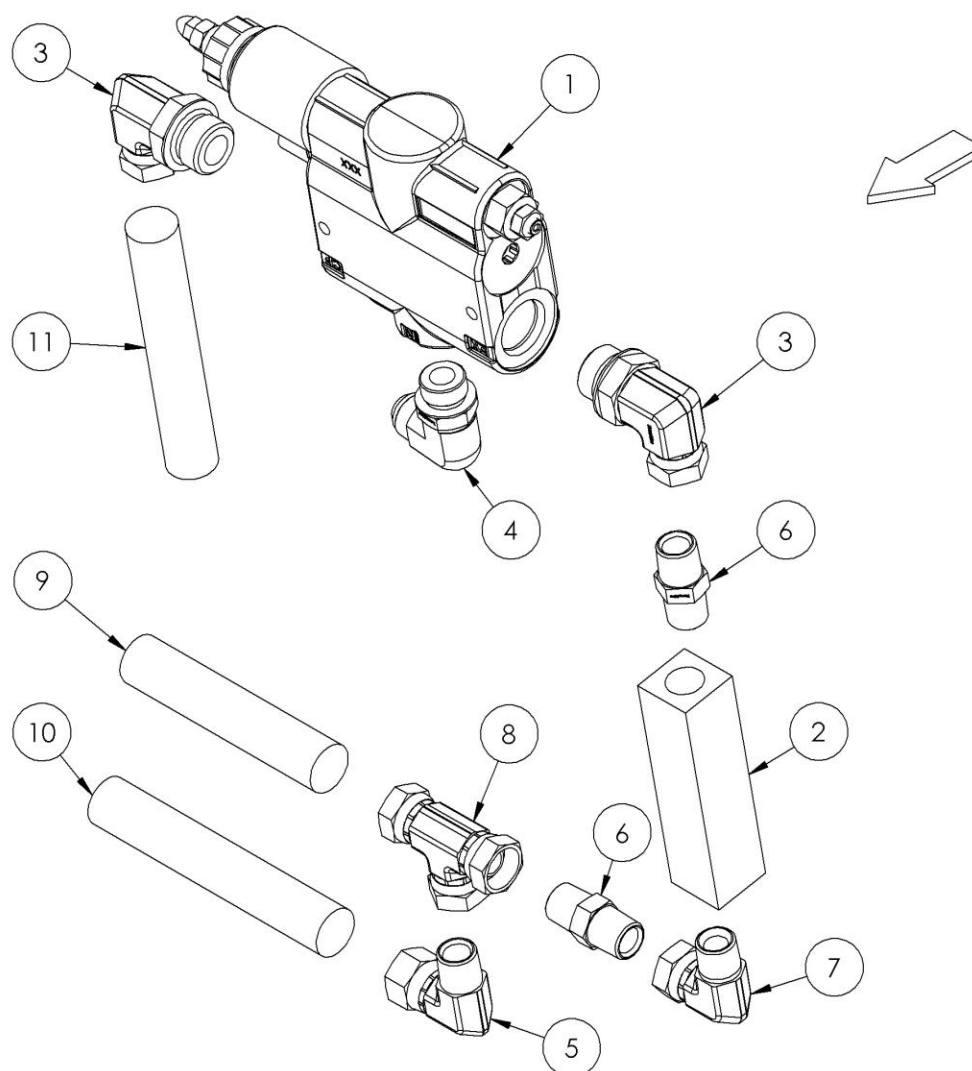

ITEM NO.	QTY	DESCRIPTION	PART NUMBER
1	1	ELECT. FLOW CONTROL	HVE-C122012
2	1	1/2" PARKER CHECK VALVE	HV-CKV-800S
3	2	ELBOW 12 SAE X 1/2" FPX	A-6901-12-8
4	1	ELBOW 5/8" MJ X 10 SAE	A-6801-10
5	1	ELBOW 1/2 MP X 5/8 FJX	A-6501-10-08
6	2	HEX NIPPLE 1/2" X 1/2"	A-5404-8-8
7	1	ELBOW 1/2 MP X 1/2 FPX90°	A-1501-8-8
8	1	SWIVEL T 1/2" NPTF	A-1603-8-8-8
9	1	1/2" HOSE 1/2MP X 5/8MJIC X 27" L	H8-27-8MP-10MJ
10	1	1/2" HOSE X 1/2MP X 1/2MP X 94" L	H8-94-8MP-8MP
11	1	1/2" HOSE 1/2MP X 5/8FJ X 16" L	H8-16-8MP-10FJ

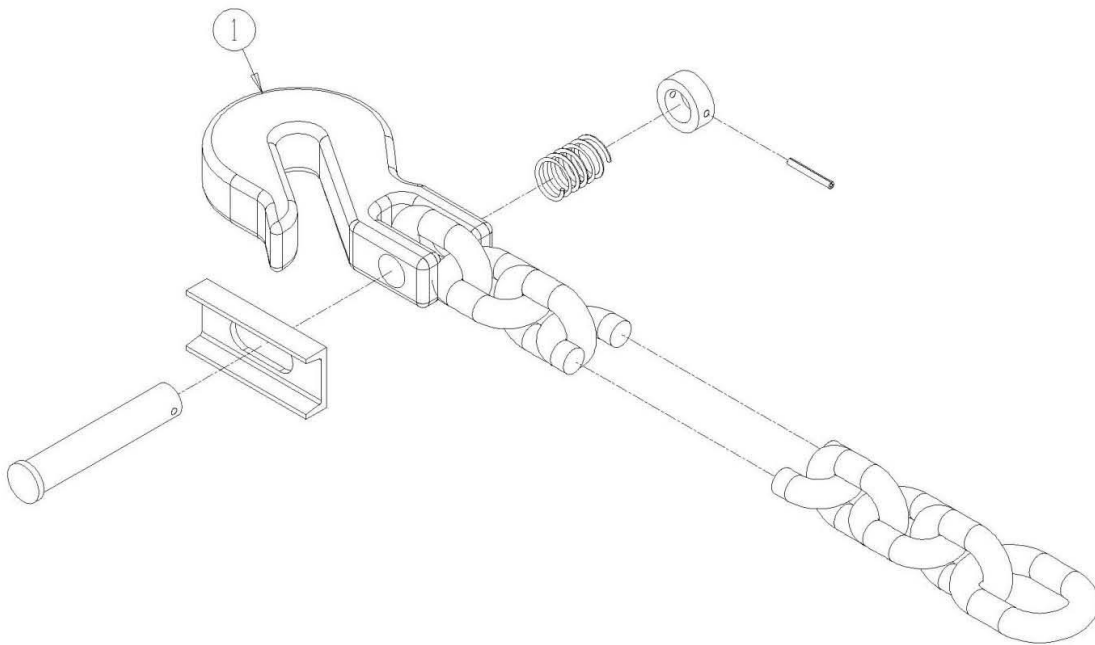

ITEM NO.	QTY	DESCRIPTION	PART NUMBER
1	1	SAFETY CHAIN, 20,200 lb CAPACITY	FRM-3164
101	1	3/4" X 4-1/2" GR 8 HH BOLT ZINC	BL-12-450-8
102	1	3/4" LOCK NUT w/ NYLIN INSERT, GR 8	BL-12-LN-8
103	2	3/4" FLAT WASHER, GR 8	BL-12-FW-8

7215-4-02

Accessories

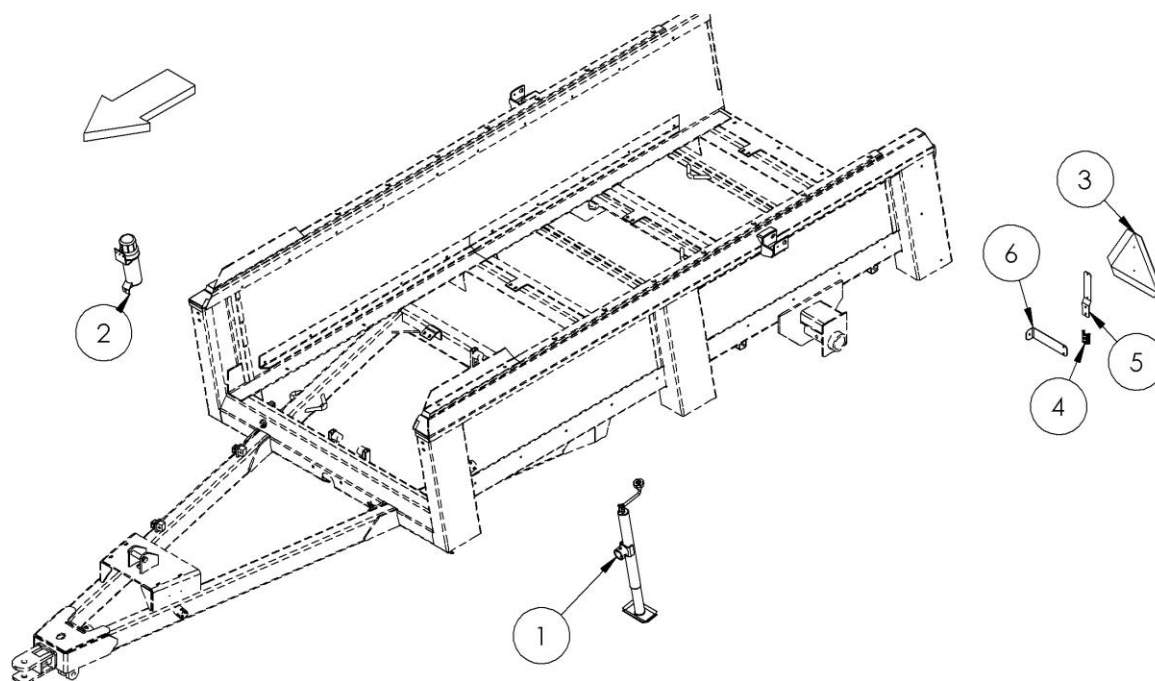

ITEM NO.	QTY	DESCRIPTION	PART NUMBER
1	1	SIDEWIND SWIVEL JACK, 5,000 lb	WH-16122
2	1	MANUAL HOLDER	MAN-67670
3	1	SMV SIGN	SMV-PL
4	1	SOCKET, SPADE MOUNT	SMV-S
5	1	SPADE MOUNT	SMV-SM
6	1	BRACKET, SMV SIGN	PR39117
101	3	12-24 X 7/8, DRILL & TAP SCREW	BL-1224-087-DT
102	2	1/4 X 5/8 CARRIAGE BOLT, ZINC	BL-4-062-C
103	2	5/16-18 HEX LN NE ZC	BL-5-LN
104	2	1/4-20 HEX LN NE ZC	BL-4-LN
105	2	5/16 USS FW ZC	BL-5-FW
106	1	3/8-16 X 1 1/4 HHCS G5 ZC	BL-6-125-H
107	2	3/8 USS FW ZC	BL-6-FW
108	1	3/8 UNC FIN HEX LOCK NUT	BL-6-LN
109	3	1/4 USS FW ZC	BL-4-FW
110	2	5/16-18 X 3/4 HEX CAP	BL-5-075-H
801	1	CRANK ASSY, JACK	WH-16122-D
802	1	PIN & CHAIN ASSY, JACK	WH-16122-E

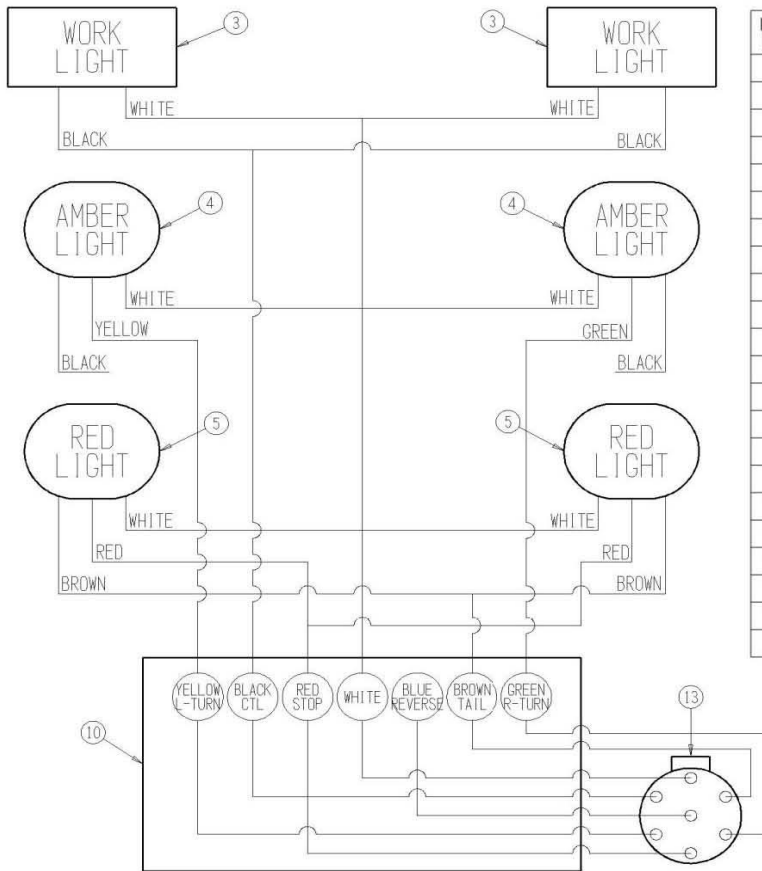

ITEM NO.	QTY	DESCRIPTION	PART NUMBER
1	2	LIGHT BRACKET	PR63004
2	4	MOUNT, LIGHT BRKT	PR70130
3	2	AUX. WORK LIGHT	EL-1233
4	1	LED LIGHT, LH	EL-1501
5	1	LED LIGHT, RH	EL-1502
6	1	4-PIN CONN., LH	EL-1503
7	1	4-PIN CONN., RH	EL-1504
8	1	HARNESS, RH	EL-40602-342
9	1	HARNESS, LH	EL-40603-426
10	2	HARNESS, WORK LT	EL-40604-13
11	1	JUNCTION BOX	ELE-15-964
12	1	7 CONDUCTOR, 55" L HARNESS	EL-50781-55
13	2	GROMMET	EL-0038
14	1	12 GA. 7 CONDUCTOR, 12' L SPIRAL CORD	ELC-127-144
15	1	TRAILER CONNECTOR HD SOCKET	ELT-37674
16	1	BOOT, TC HD SOCKET	EL-37679
100	16	3/8 USS FW ZC	BL-6-FW
101	8	3/8 SPLIT LW ZC	BL-6-LW
102	4	3/8 UNC FIN H LN NE A563 GRA ZC	BL-6-LN
103	12	3/8-16 X 1-1/4 HHCS G5 ZC	BL-6-125-H
104	8	1/4-20 HEX LN NE ZC	BL-4-LN
105	8	1/4 UNC X 1-1/2 CARRIAGE BOLT G5 ZC	BL-4-150-C

TYPICAL TRACTOR PLUG (LOOKING AT PLUG):

12 O'CLOCK - WHITE - GROUND
 10 O'CLOCK - BLACK - FIELD LIGHTS
 8 O'CLOCK - YELLOW - LEFT TURN
 6 O'CLOCK - RED - KEYED AUXILIARY
 4 O'CLOCK - GREEN - RIGHT TURN
 2 O'CLOCK - BROWN - TAIL LAMP
 CENTER - BLUE - KEYED AUXILIARY

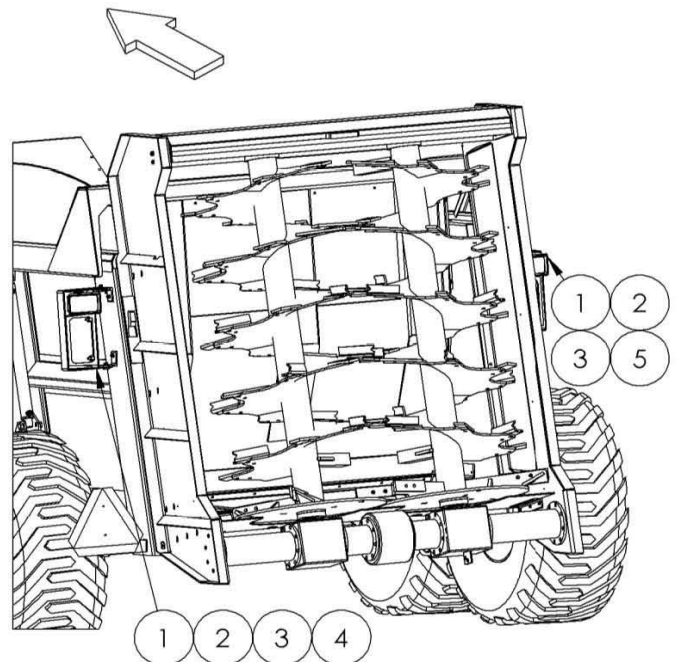
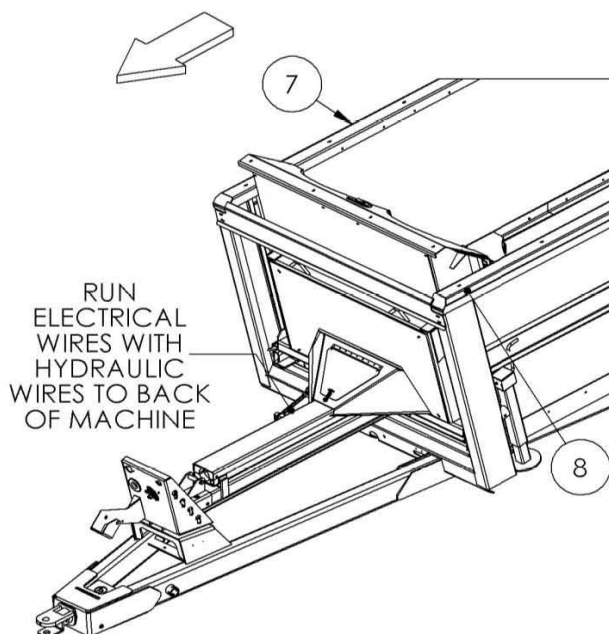

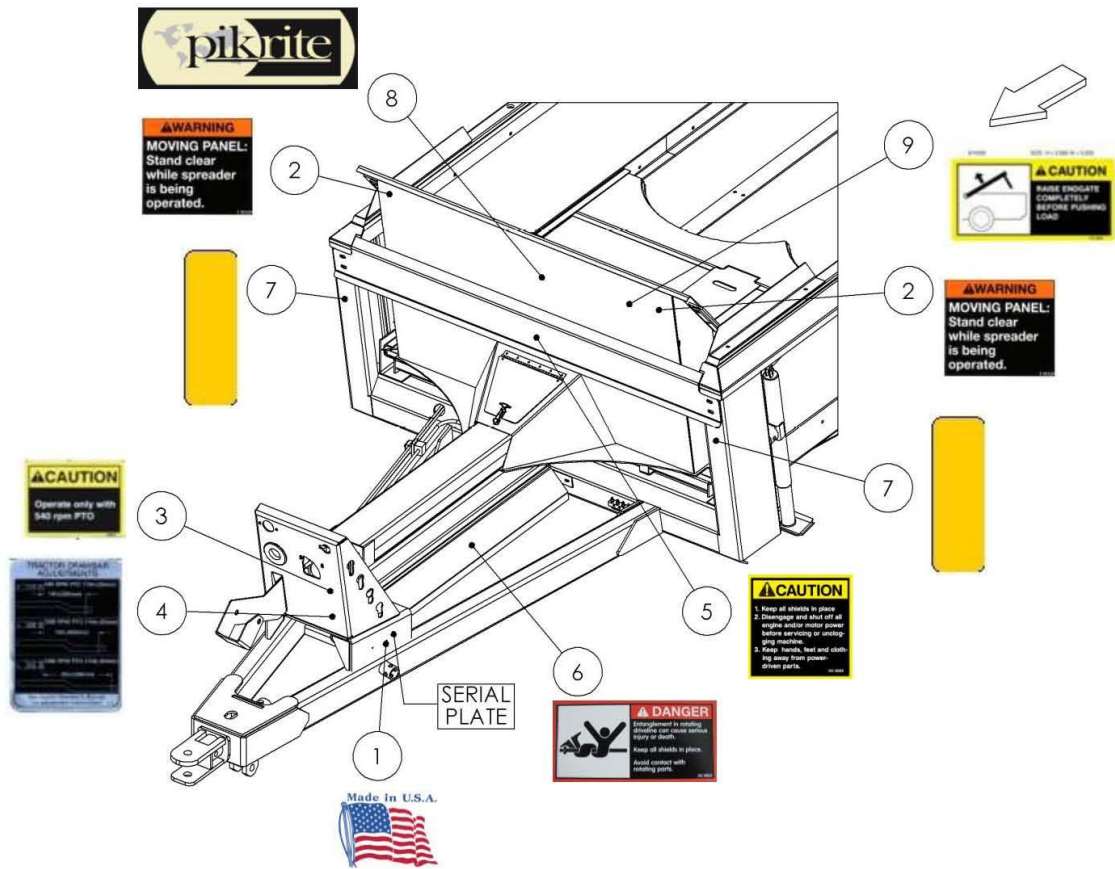

ITEM NO.	QTY	DESCRIPTION	PART NUMBER
1	1	DECAL, MADE IN USA	DC-0011
2	2	DECAL, WARNING, MOVING PANEL	DC-0020
3	1	DECAL, CAUTION, 540 rpm	DC-0024
4	1	DECAL, TRACTOR DRAWBAR	DC-0022
5	1	DECAL, CAUTION, SHIELDS	DC-0023
6	1	DECAL, DANGER, ENTANGLEMENT	DC-0025
7	2	DECAL, YELLOW REFLECTOR	EL-1226
8	1	DECAL, PIK RITE LOGO	DC-0097
9	1	DECAL, CAUTION, ENDGATE	DC-0038

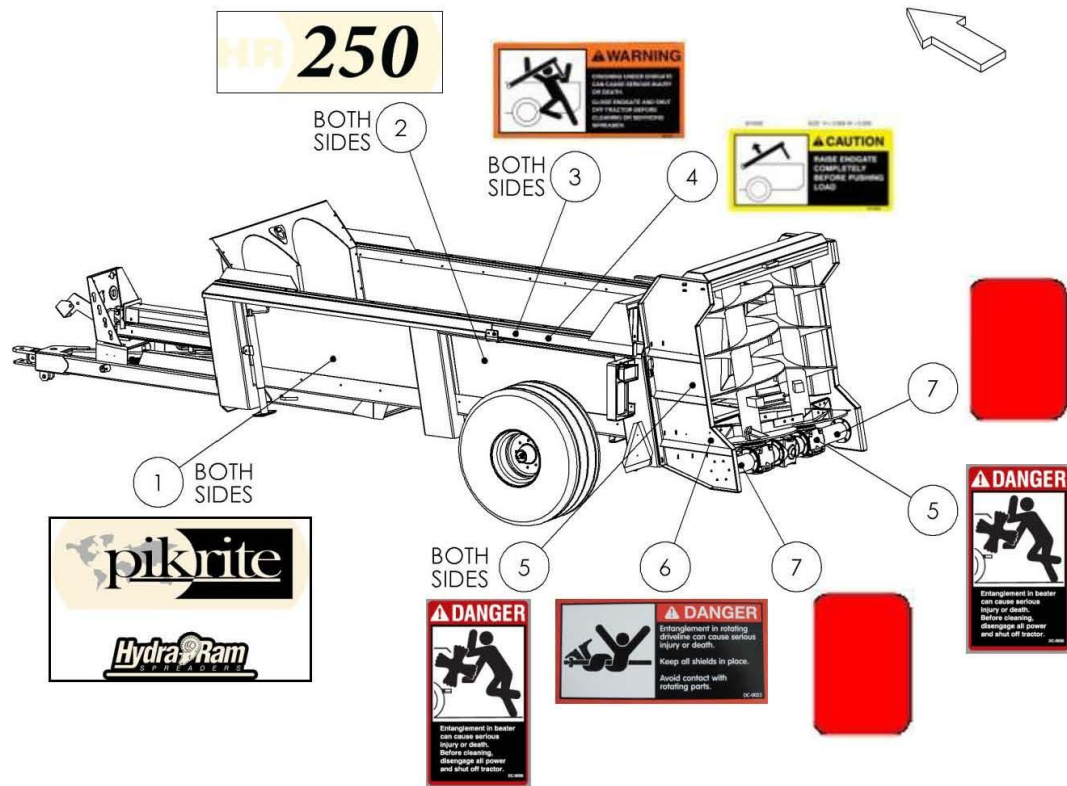

ITEM NO.	QTY	DESCRIPTION	PART NUMBER
1	2	DECAL, PIK RITE LOGO	DC-0107
2	2	DECAL, HR 250 LOGO	DC-0100
3	2	DECAL, WARNING, ENDGATE	DC-0026
4	1	DECAL, CAUTION, RAISE ENDGATE	DC-0038
5	3	DECAL, DANGER, BEATER	DC-0030
6	1	DECAL, DANGER, ENTANGLEMENT	DC-0025
7	2	DECAL, RED REFLECTOR	EL-1227

WARRANTY

Pik Rite, Inc. provides a limited warranty assuring any new Hydra-Ram Spreader to be free from defects in material and workmanship for a period of two (2) years from the original date of purchase.

Pik Rite will repair or replace, at its option and without charge, any defective or malfunctioning part (excluding items of normal wear or misuse) of the spreader for this allotted time.

**PIK RITE MAKES NO WARRANTY OF
MERCHANTABILITY OR FITNESS FOR A
PARTICULAR USE.**

Customer's Responsibility:

It is the customer and/or operator's responsibility to read the Operator's Manual, to operate, lubricate, maintain and store the equipment in accordance with all instructions and safety procedures. Failure of the operator to read the operators manual is a misuse of this equipment.

It is the customer and/or operators responsibility to inspect the product and to have any part(s) repaired or replaced when continued operation would cause damage or excessive wear to other parts or cause a safety hazard.

It is the customer's responsibility to deliver the product to the authorized dealer, from whom the spreader was purchased, for service or replacement of defective parts, which are covered by warranty.

It is the customer's responsibility for any cost incurred by the dealer for hauling the product for the purpose of performing a warranty obligation or inspection.

WARRANTY INFORMATION

Make certain the warranty registration card has been forwarded to:

Pik Rite, Inc.
60 Pik Rite Lane
Lewisburg, PA 17837

Always give your dealer the serial number of your Pik Rite, Inc. product when ordering parts or requesting service or other information.

In the space provided record the model number, the serial number and the date of purchase to assist in providing you with prompt and efficient service.

MODEL NUMBER: HR250

DEALER: _____

SERIAL NUMBER: _____

ADDRESS: _____

PURCHASE DATE: _____

PHONE: _____

SALESMAN: _____

Keep Page for Your Records

Pik Rite, Inc.
60 Pik Rite Lane
Lewisburg, PA 17837

Phone: 800-326-9763
Fax: 570-523-8175
www.pikrite.com

HR 250
Manure Spreader