



# Operation and Parts Manual



July, 2020

Pik Rite, Inc.  
60 Pik Rite Lane  
Lewisburg, PA 17837

Phone: 800-326-9763  
Fax: 570-523-8175  
[www.pikrite.com](http://www.pikrite.com)

**HP 700**  
**Manure Spreader**

(SPECIFICATIONS AND DESIGN SUBJECT TO CHANGE WITHOUT NOTICE)

Some illustrations may not represent the spreader model you have; however, the principles of operation and maintenance are the same. If you have questions specific to your spreader please contact your dealer.

(SPECIFICATIONS AND DESIGN SUBJECT TO CHANGE WITHOUT NOTICE)



## Table of Contents

OPERATION MANUAL.....	6
SAFETY.....	8
PREPARING THE TRACTOR .....	13
PREPARING THE SPREADER.....	16
CONTROLS.....	18
ATTACHING THE SPREADER .....	19
DETACHING THE SPREADER .....	20
TRANSPORT .....	21
OPERATING THE SPREADER .....	24
LUBRICATION & MAINTENANCE .....	27
SPECIFICATIONS .....	33
PARTS MANUAL.....	36
74215-1-01 Main Frame & Hitch Panels.....	38
74215-1-02 -Stone Guard .....	39
74215-1-03 Front Shields.....	39
74215-1-05 Endgate .....	40
74215-1-07 Axle & Walking Beam .....	41
74215-1-07A Opt. – Weight Scale Assy, 5 pt, GT400 .....	422
74215-1-07B Opt. – Weight Scale Assy, 5 pt, NT460 .....	43
74215-1-08 Wheels & Tires .....	444
74215-1-09 Opt. – Metering Shield .....	444
74215-2-01 Driveline, 1000 rpm.....	455
74215-2-02 Main Drive Shaft.....	466
74215-2-03 Vertical Beaters, Quick Disconnect .....	477
74215-2-03A Vertical Beater Gearbox .....	48
74215-2-04 Web Chain Drive.....	Error! Bookmark not defined.
74215-2-05 Web Chain Gearbox .....	51
74215-3-01 Hydraulics, Web Drive.....	52
74215-3-02 Hydraulics, Endgate.....	53

Pik Rite, Inc.  
60 Pik Rite Lane  
Lewisburg, PA 17837

Phone: 800-326-9763  
Fax: 570-523-8175  
[www.pikrite.com](http://www.pikrite.com)

**HP 700**  
**Manure Spreader**





74215-3-03	Endgate Cylinders.....	54
74215-4-01	Air Brakes .....	55
74215-4-02	Hydraulic Brake Assembly.....	57
74215-4-03	Opt. – Tractor Brake Control.....	58
74215-5-01	Electrical & Lighting.....	59
74215-6-01	Safety Tow Chain.....	60
74215-6-02	Jack Stand.....	61
74215-6-03	SMV Emblem & Bracket .....	62
74215-6-04	Decals, Front.....	63
74215-6-05	Decals, Sides & Rear .....	64
<b>WARRANTY .....</b>		<b>67</b>

Pik Rite, Inc.  
60 Pik Rite Lane  
Lewisburg, PA 17837

Phone: 800-326-9763  
Fax: 570-523-8175  
[www.pikrite.com](http://www.pikrite.com)

***HP 700***  
**Manure Spreader**



## **OPERATION MANUAL**

Pik Rite, Inc.  
60 Pik Rite Lane  
Lewisburg, PA 17837

Phone: 800-326-9763  
Fax: 570-523-8175  
[www.pikrite.com](http://www.pikrite.com)

***HP 700***  
**Manure Spreader**



## SAFETY

**RECOGNIZE SAFETY INFORMATION**

This is the safety-alert symbol. When you see this symbol on your machine or in this manual be alert to the potential of personal injury.

**Follow recommended precautions and safe operating practices**

**⚠ DANGER**

**⚠ WARNING**

**⚠ CAUTION**

**UNDERSTAND SIGNAL WORDS**

A signal word – DANGER, WARNING, or CAUTION-is used with the safety-alert symbol. DANGER identifies the most serious hazards.

DANGER or WARNING safety signs are located near specific hazards. General precautions are listed on CAUTION safety signs. CAUTION also calls attention to safety messages in this manual.

**FOLLOW SAFETY INSTRUCTIONS**

Carefully read all safety messages in this manual and on your machine safety signs. Keep safety signs in good condition. Replace missing or damaged safety signs. Be sure new equipment components and repair parts include the current safety signs. Replacement safety signs are available from your Pik Rite dealer.

Learn how to operate the machine and how to use controls properly. Do not let anyone operate without instruction.

Keep your machine in proper working condition. Unauthorized modifications to the machine may impair the function and/or safety and affect machine life.

If you do not understand any part of this manual and need assistance, contact your Pik Rite dealer.



## KEEP SHIELDS IN PLACE

Do not operate spreader without safety shields in place.

Rotating parts can crush or dismember causing death or personal injury.

Disconnect PTO driveline and hydraulic lines from tractor before removing shields for adjustment or service.



## PROTECT BYSTANDERS

Never operate the spreader near people.

Do not place rocks, timbers or other solid objects in the spreader. Objects can be thrown great distances causing injury to people.



## WEAR PROTECTIVE CLOTHING

Wear close fitting clothing and safety equipment appropriate to the job.

Prolonged exposure to loud noise can cause impairment or loss of hearing.

Wear a suitable hearing protective device such as earmuffs or earplugs to protect against objectionable or uncomfortable loud noises.

Operating equipment safely requires the full attention of the operator. Do not wear radio or music headphones while operating machine.

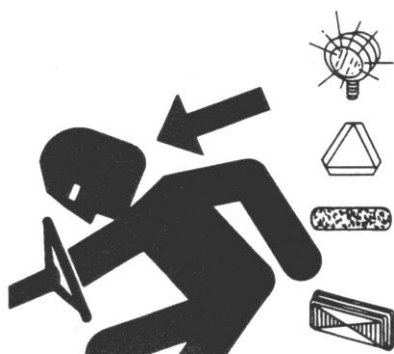

## USE SAFETY LIGHTS AND DEVICES

Slow moving tractors, self-propelled equipment and towed implements or attachments can create a hazard when driven on public roads. They are difficult to see, especially at night. Avoid personal injury or death resulting from collision with a vehicle.

Flashing warning lights and turn signals are recommended whenever driving on public roads. To increase visibility, use the devices provided with your machine. For some equipment, install extra flashing warning lights.

Keep safety items in good condition. Replace missing or damaged items.



## KEEP RIDERS OFF MACHINE

Riders are subject to injury such as being struck by foreign objects and being thrown off the machine. Riders also obstruct the operator's view resulting in the machine being operated in an unsafe manner



## PARK SPREADER SAFELY

Park spreader on a level surface and block wheels.

Close endgate.

Secure jackstand with pin.

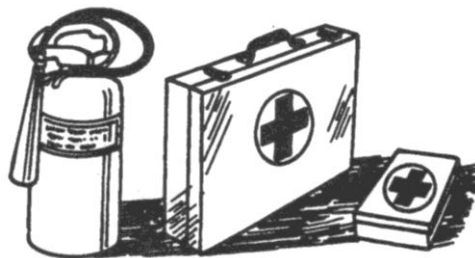

## PREPARE FOR EMERGENCIES

Be prepared if a fire starts.

Keep a first aid kit and fire extinguisher handy.

Keep emergency numbers for doctors, ambulance service, hospital, and fire department near your telephone.

## USE A SAFETY CHAIN

A safety chain will help control drawn equipment should it accidentally separate from the drawbar.



Using the appropriate adapter parts, attach the chain to the tractor drawbar support or other specified anchor location. Provide only enough slack in the chain to permit turning.

See your Pik Rite dealer for a chain with a strength rating equal to or greater than the gross weight of the towed machine. Do not use safety chain for towing.

## OPERATE SPREADER SAFELY



Rotating parts can entangle or strike people, resulting in death or personal injury.

Never enter a spreader while in operation.

Operate the spreader from the tractor seat only.

Do not exceed load capacity of the spreader. (See Transport section)

Reduce speed when turning or traveling on rough terrain. Avoid traveling over loose fill, rocks, ditches or holes.

When working on inclines or slopes, travel uphill or downhill. Keep tractor in gear when traveling downhill.



## STAY CLEAR OF RAISED ENDGATE

Contact with a lowering endgate can cause death or personal injury.

Lower endgate and disconnect hydraulic lines before servicing or adjusting.



## STAY CLEAR OF ROTATING DRIVELINES

Entanglement in rotating driveline can cause serious injury or death.

Keep tractor master shield and driveline shields in place at all times. Make sure rotating shields turn freely.

Wear close fitting clothing. Stop the engine and be sure PTO driveline is stopped before making adjustments, connections, or cleaning out PTO driven equipment.

## STAY CLEAR OF ROTATING BEATER

Rotating beater can entangle or strike causing death or personal injury.

Do not clean out or service spreader while beater is rotating.

Disconnect PTO driveline and make sure all parts have stopped rotating before cleaning or servicing.



**WARNING: DO NOT CUT OR WELD ON VERTICAL BEATER ATTACHMENT, SERIOUS INJURY OR DEATH COULD OCCUR WHEN OPERATING**

## AVOID HIGH-PRESSURE FLUIDS



Escaping fluid under pressure can penetrate the skin causing serious injury.

Avoid the hazard by relieving pressure before disconnecting hydraulic or other lines. Tighten all connections before applying pressure.

Search for leaks with a piece of cardboard. Protect hands and body from high pressure fluids.

If an accident occurs, see a doctor immediately. Any fluid injected into the skin must be surgically removed within a few hours or gangrene may result. Doctors unfamiliar with this type of injury should reference a knowledgeable medical source.



## SERVICE SPREADER SAFELY

To help prevent personal injury caused by unexpected movement, be sure to service spreader on level surface.

If spreader is connected to tractor, disengage PTO, engage parking brake and/or place transmission in "PARK," shut off engine and remove key.

If spreader is detached from tractor, block wheels and use safety stands to prevent movement.

Replace all shields after lubricating or servicing.

## REDUCE SPEED WHEN TOWING LOADS

Braking to stop towed loads from transport speeds can cause the towed load to swerve and upset. Reduce speed if towed load weighs more than the tractor and is not equipped with brakes.

Follow recommended speed-weight ratio guidelines:

- Maximum speed is 20 mph (32 km/h) when towing loads equal to or less than the tractor.
- Reduce speed to 10 mph (16 km/h) when towing loads more than equal and up to double the tractor weight.
- Do not tow loads exceeding double the tractor weight.
- Use additional caution when towing loads under adverse surface conditions, when turning, and on inclines

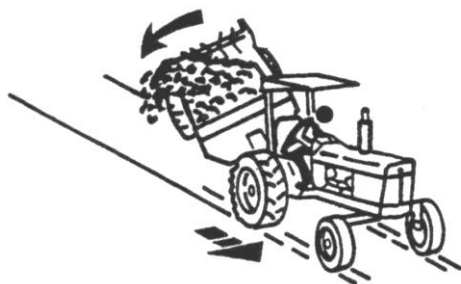



# PREPARING THE TRACTOR

## PREPARING THE TRACTOR

### APPROVED TRACTORS, MODEL HP 700

Row Crop Tractors with 200 HP PTO rating or larger are approved for operation with the HP 700 Spreader.

Utility Tractors are **NOT APPROVED** because of drawbar weight limitations and the inability to ballast the tractor enough to meet requirements for towing.

A drawbar support is required on any tractor with a drawbar size of no less than 1-1/2 x 3 in.

Tractor hydraulic oil reservoir must have capacity for 3.7 U.S. gal. net draw for a spreader with an endgate or 3.1 U.S. gal. without an endgate.

Tractor standby hydraulic pressure must be 1500 psi minimum.

One selective control valve is required to operate the spreader.

A second selective control valve is required to operate the endgate.

### CHOOSING CORRECT PTO SPEED

**MODEL HP 700** – 1000 rpm only

**IMPORTANT:** Drive components can be damaged.

Under no circumstances should a machine equipped for 540 rpm PTO be operated by a tractor equipped with 1000 rpm PTO. Nor should a 1000 rpm PTO machine be operated with a tractor equipped with 540 rpm PTO.

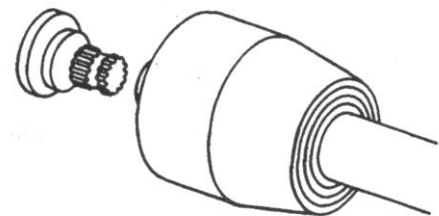
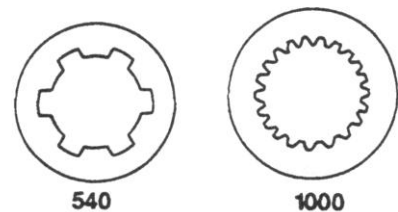

# PREPARING THE TRACTOR

## BALLASTING THE TRACTOR

**CAUTION:** Do not tow loads that weigh more than twice the tractor weight.  
(See Recommended Maximum Towing Speed in Transport section.)

To ensure proper stability, adjust ballast and wheel spacing according to tractor operator's manual.

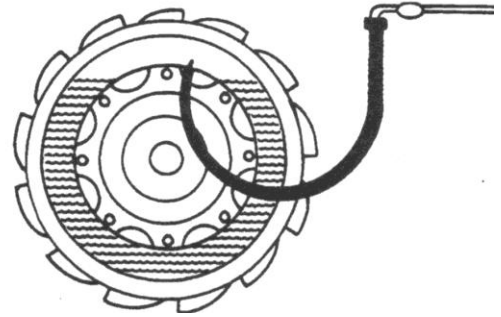

## POSITIONING DRAWBAR

**IMPORTANT:** Tractor PTO and machine driveline can be damaged. Be sure drawbar length is properly set. If equipped with clevis, remove it. Lock drawbar along tractor centerline with offset down.

Clevis is needed

Adjust drawbar length (A) to help prevent driveline damage.

PTO Speed	Dimension (A)
1000 rpm x 1-3/4	508 mm (20in.)

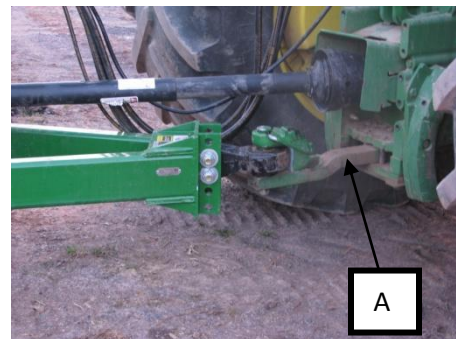

A tractor drawbar support is required on tractors with a drawbar size of 1-1/2 x 3 in. minimum

# PREPARING THE TRACTOR

## USING SELECTIVE CONTROL LEVERS TO CONTROL CHAIN SPEED

Apron Chain speed can be controlled by using the tractor's selective speed control lever to adjust spread rate up or down.

Adjust selective control valve lever to provide the slowest operating speed.  
(See your tractor Operator's Manual)

Maximum hydraulic oil flow through the spreader apron chain motor is 15 gpm. Trying to force through more oil than this may create a pressure drop and could damage the hydraulic motor.

## SETTING HYDRAULIC SPEED ENDGATE OPERATION

**IMPORTANT:** Excessive operating speed may cause machine damage. Adjust selective control valve lever to provide correct operating speed.

### CHECKING TRANSMISSION/HYDRAULIC OIL LEVEL

Cycle all hydraulic cylinders fully two or three times.

Fully retract all cylinders.

Check transmission/hydraulic oil level.  
(See your tractor's Operator's Manual)

# PREPARING THE SPREADER

## PREPARING THE SPREADER

### LUBRICATING THE MACHINE

Be sure the machine has been adequately lubricated.

(See Lubrication and Maintenance page.)

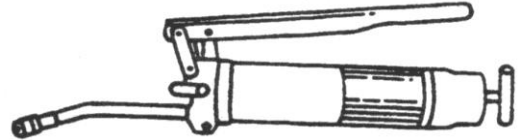

### BRAKE ADJUSTMENT (HYDRAULIC)

Valve is set from factory at 1000 psi



# PREPARING THE SPREADER

## TIGHTENING WHEEL HARDWARE

**IMPORTANT:** Operating the spreader with loose wheel hardware will damage the hub or wheel. Tighten hardware after initial transport, after one hour of operation and every fifty hours thereafter.

Tighten to 475 lb-ft of torque in the sequence shown.

<u>Tire Size</u>	<u>Wheel Size</u>	<u>Tire Pressure</u>
700/40-22.5 treaded	22.5 x 16	65 PSI

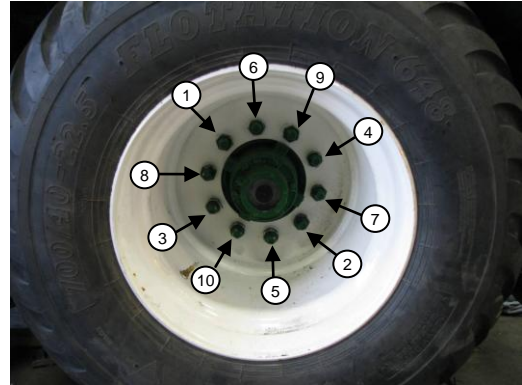

## CHECKING TIRES

1. Check tires daily for damage or noticeably low pressure.
2. Repair any cuts or breaks as soon as possible.
3. Protect tires from exposure to sunlight and petroleum products or chemicals.



## CONTROLS

### OPERATING THE BEATER

To start beater, engage PTO lever slowly, at low engine rpm.

To stop beater, disengage PTO. (See your tractor's Operator's Manual)

For best spreading results, operate the tractor engine at "PTO RATED" speed.

**WARNING:** Do not operate the apron chain without running the beaters as this may damage the spreader.

### OPERATING THE ENDGATE

**IMPORTANT:** Contact of apron chain running with endgate closed will cause damage. To avoid contact with apron chain when running, endgate must be raised fully when running apron chain.

Operate the endgate with the second auxiliary control valve lever.

**WARNING:** Endgate is not a metering device. Doing so may cause damage to the spreader.



### OPERATING APRON CHAIN

To run apron chain lock hydraulic control lever in operating position on tractor.

See your tractor's operating manual for information on how to control flow rates of your hydraulic system.

Maximum hydraulic oil flow through the spreader apron chain motor is 15 gpm. Trying to force through more oil than this may cause serious damage to motor (relief factory set at 1250 psi)



# ATTACHING THE SPREADER

## ATTACHING THE SPREADER

### ATTACHING SPREADER

**CAUTION:** Help prevent personal injury caused by unexpected movement of the machine. Engage parking brake and/or place transmission in "PARK", shut off engine, and remove key before working around hitch.

1. Attach with a 1-1/2 or 2 in. pin and secure.  
(Top clevis required)

**IMPORTANT:** Shorten safety chain to allow only enough slack required for turning.

2. Lock safety hook onto chain.



### ATTACHING DRIVELINE

**IMPORTANT:** Avoid causing damage to shielding, **DO NOT** use bell on driveline to lift driveline into position.

1. Support driveline, cradling it in your hand.
2. Rotate driveline (C) or tractor PTO (B) to align splines.
3. Pull collar (C) rearward and push forward on bell (A) to engage driveline yoke with tractor PTO (B).
4. Pull back on PTO driveline shielding to be sure driveline is locked. **DO NOT** pull on collar, this will release latch.

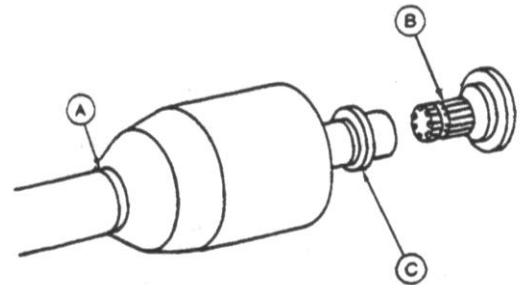

### CONNECTING AIR HOSES (AIR ASSIST BRAKES)

1. Connect red line to supply port.
2. Connect blue line to service/control port.



### CONNECTING HOSES (HYRAULICS BRAKES)

1. Connect pressure hoses to pressure ports of hydraulic remote coupler.
2. Connect return hoses to return ports of hydraulic remote coupler.

(Relief factory set 1000psi)





# DETACHING THE SPREADER

## DETACHING THE SPREADER

### DETACHING SPREADER

1. Secure jackstand in lift position
2. Detach safety chain
3. Remove hitch pin
4. Disconnect hoses. Store on spreader



### DETACHING DRIVELINE

1. Support driveline (A) and pull rearward on collar (C) to release driveline from tractor PTO (B).
2. When possible store driveline in driveline cradle provided with machine.
3. Replace tractor PTO shields.

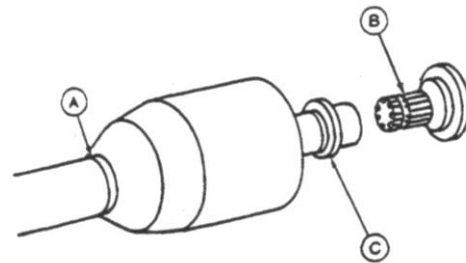



## TRANSPORT

### USING A SAFETY CHAIN

**CAUTION:** A safety chain will help control drawn equipment should it accidentally separate from the drawbar while transporting. Using the appropriate adapter parts, attach the chain to the tractor drawbar support or other specified anchor location. Provide only enough slack in the chain to permit turning. See your Pik Rite dealer for a chain with a strength rating equal to or greater than the gross weight of the towed machine.

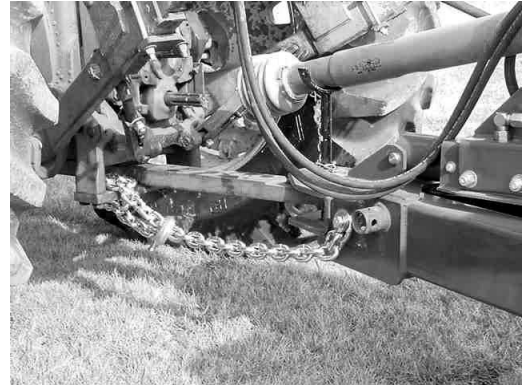

1. Attach safety tow chain

### LIGHTING

**CAUTION:** When transporting the machine on a road or highway at night or during the day, use accessory lights and devices for adequate warning to operators of other vehicles. Check local governmental regulations. Keep safety items in good condition. Replace missing or damaged items.

*Contact your Hydra-Pull Dealer for available lighting kit*



## TOWING LOADS





**CAUTION:** Braking to stop towed loads from transport speeds can cause the towed load to swerve and upset. Reduce speed if towed load is not equipped with brakes and weighs more than the tractor.



*Follow recommended speed-weight ratio guidelines:*

- Maximum speed is 20 mph (32 km/h) when towing loads equal to or less than the weight of the tractor.
- Reduce speed to 10 mph (16 km/h) when towing loads more than or up to double the tractor weight.
- **DO NOT** tow loads that exceed double the tractor weight.
- Use additional caution when towing loads under adverse road surface conditions (i.e. slippery or rough), when turning and/or on inclines.
- For proper tractor size and towing speed see the following “Recommended Maximum Towing Speed” chart.
- If necessary, add ballast as described in your tractor’s Operator’s Manual.

## RECOMMENDED MAXIMUM TOWING SPEED

Gross Tractor Weight	COMBINED WEIGHT OF SPREADER AND LOAD			
				
Tractor Weight				

(0-2997 lb)	Do Not Tow	Do Not Tow	Do Not Tow	Do Not Tow
(2998-5950 lb)	Do Not Tow	Do Not Tow	Do Not Tow	Do Not Tow
(5951-11021 lb)	Do Not Tow	Do Not Tow	Do Not Tow	Do Not Tow
(11022-12123 lb)	Do Not Tow	Do Not Tow	Do Not Tow	Do Not Tow
(12124-14769 lb)	Do Not Tow	Do Not Tow	Do Not Tow	Do Not Tow
(14770-22044 lb)	Do Not Tow	Do Not Tow	Do Not Tow	Do Not Tow
(22045-24910 lb)	(20 mph)	(10 mph)	(10 mph)	(10 mph)
(24911-29540 lb)	(20 mph)	(10 mph)	(10 mph)	(10 mph)
(29541 lb-Up)	(20 mph)	(10 mph)	(10 mph)	(10 mph)

*\*Base Spreader Empty Load*

*\*\*Load struck level consisting of manure with high liquid content.  
Calculated at 70 lb/cu ft*

*\*\*\*Load piled 381 mm (15 in.) above beater consisting of semi-solid type manure  
Calculated at 55 lb/cu ft*

*\*\*\*\*Load piled at 15 in. above optional upper beater consisting of semi-solid type manure.  
Calculated at 55 lb/cu ft*

# OPERATING THE SPREADER

## OPERATING THE SPREADER

### PREOPERATING CHECKS

1. Be sure spreader does not contain any foreign objects
2. Check for correct hydraulic hookup. Raise endgate fully. Engage beaters, engage apron chain
3. Disengage apron chain, disengage beaters
4. Close endgate

### LOADING THE SPREADER

**CAUTION:** Do not place rocks, timbers, or other solid objects in the spreader. Objects of this nature can damage the spreader and could also be thrown great distances causing possible injury to anyone standing in the vicinity.

Load front of spreader first, distributing load evenly.

When operating without an endgate, avoid loading manure against the beater.



### PREPARE TO UNLOAD THE SPREADER

**CAUTION:** Help prevent personal injury. Be sure no one is near spreader and tractor before operating.

1. Start beater by engaging PTO slowly at low engine rpm. Increase to "PTO RATED" speed.

**NOTE:** For best spreading results, operate tractor at "PTO RATED" speed.

**WARNING:** Do not operate apron chain without running the beaters as this may damage the spreader

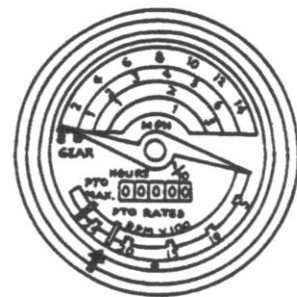

# OPERATING THE SPREADER

## RAISE ENDGATE

**IMPORTANT:** Contact of apron chain with endgate will cause damage. To avoid contact with apron chain, endgate must be raised fully.

The endgate closes off the back end of the spreader to contain manure with high liquid content.

The endgate also prevents solid material from being piled tight against the beater.



## UNLOADING SPREADER USING METERING VALVE

1. Set flow control on tractor hydraulics obtain desired rate of unload speed.

**Note:** Rate of spread is affected by both ground speed and unload speed. Experience will help you determine both gear selection and control knob setting.

2. When spreader is empty, disengage apron chain disengage PTO, and lower endgate.

## PRODUCING GOOD SPREADING RESULTS

1. Operate tractor engine at “PTO RATED” speed.
2. Do not overload beater. A clumpy spread pattern will result from too fast an unload rate.
3. When operating without an endgate, avoid loading material against the beater. Otherwise, large clumps of material will be thrown out during the first few turns of the beater.

## CLEANING SPREADER IN COLD WEATHER

When operating the spreader during extended periods of subfreezing temperatures, frozen material may build up on steel surfaces. This can prevent the beater from moving.

After completing spreading for the day, use the following cleaning procedure.

**NOTE:** Cleaning is only necessary during extended periods of subfreezing temperatures.

Remove material along edges of apron chain

Remove material buildup from endgate panel. Keep endgate arms clean to prevent freezing to side rails.

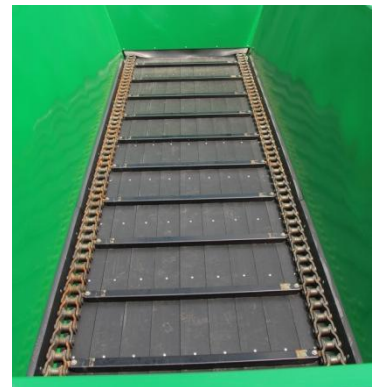

# OPERATING THE SPREADER

## CLEAN WALKING BEAM

When tire valve stems are mounted towards the inside, clean top of walking beams to prevent valve stem damage.



## WARMING HYDRAULIC OIL TEMPERATURES BELOW 0°F (−18°C)

It is necessary to warm the hydraulic oil for proper spreader operation.

Follow the procedures in your tractor's Operator's Manual for warming hydraulic oil.

The following procedures apply only to tractors with a closed center hydraulic system.



## BYPASSING SPREADER CONTROL VALVE

There will be a large hydraulic oil pressure drop across the auxiliary flow control valve when the oil is cold. Oil pressure available to hydraulic cylinders may be too low.

Try cycling the cylinders several times slowly so the cold oil in the cylinders is mixed with the warm oil in the tractor. In the event of extreme cold; you may need to bypass the control valve to do this. Be sure you begin by moving the cylinders very slowly.

Reconnect hoses to flow control valve.

## LUBRICATION & MAINTENANCE

### LUBRICATING AND MAINTAINING SPREADER SAFELY

**CAUTION:** Help prevent personal injury caused by unexpected movement of the machine. If spreader is connected to tractor, disengage PTO, engage parking brake and/or place transmission in "PARK", shut off engine, and remove key. If spreader is detached, block wheels and use safety stands.

Replace all shields after lubricating or servicing.

### OBSERVING INTERVALS

**IMPORTANT:** The intervals recommended are based on normal conditions. Severe or unusual conditions may require more frequent attention.



### SELECTING GREASE

Depending upon the expected air temperature range during the service interval, use grease as shown on the adjusting temperature chart.

-SAE-Multipurpose High Temperature Grease with Extreme Pressure [EP] Performance with 3 to 5% molybdenum disulfide.

**NOTE:** Moly-type grease is recommended, however, if not available, a multipurpose grease is acceptable.

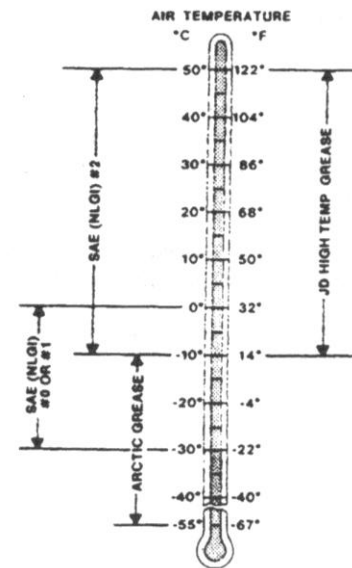

### SELECTING GEAR CASE OIL

Depending upon the expected air temperature range during the drain interval, use oil viscosity shown on the adjoining temperature chart.

-API Service Classification GL-5  
-Military Specification MIL-L-2105B  
-Military Specification MIL-L-2105C

At temperatures below -35° [-31°], use arctic oils such as those meeting Military Specifications MIL-G-10324A.

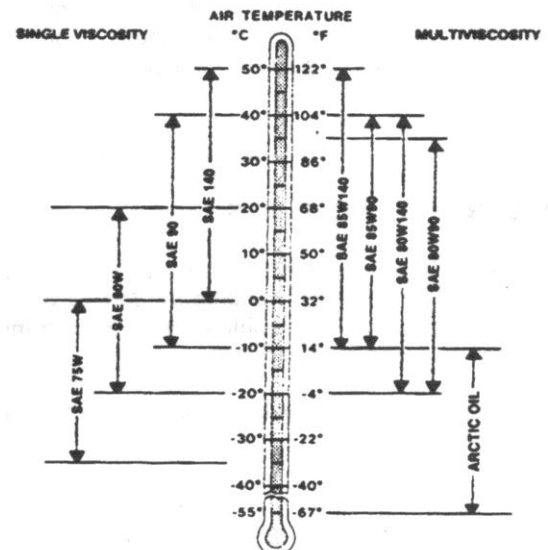

## LUBRICATION & MAINTENANCE



## SERVICE INTERVALS

Lubricate driveline every 8 hrs

- Lubricate top beater bearings every 40 hrs
- Check gear case oil level every 8 hrs
- Check tires every 8 hrs
- Check axle hub oil every 8 hrs
- Grease apron chain drive bearings & sprockets every 40 hrs

### EVERY 50 HOURS

- Adjust apron chain
- Tighten wheel hardware
- Lubricate walking beam pivots

In addition to the above referenced information, you are working with a central lube CV design on the primary that contains a special lubrication provision that needs to be well defined for the user so that extended life on the CV can be achieved.

The key point is that each CV has one zerk in a bearing cap and it is this zerk that is most important since it feeds the inboard cross kit as well as the the ball and socket of the CV. The user needs to understand that the zerk in the cap should receive **15-20 pumps** of grease each day while the other zerks in the joint

CV housing and telescoping members can operate with 5-6 pumps or until the seals purge. The plastic zerks feeding the shielding should also receive 3-4 pumps daily if shields are being restrained.

Primary Driveline (to Tractor) Lubricate fittings D1 through D6 every eight hours of operation.

Secondary Driveline (under spreader)  
Lubricate as above including overrunning clutch.

### EVERY 250 HOURS

- Lubricate endgate pivots

### SERVICE AS REQUIRED

- Adjust apron chain tension
- Slip the clutch

### GEARBOX

- Change lubricant every 6,000 loads

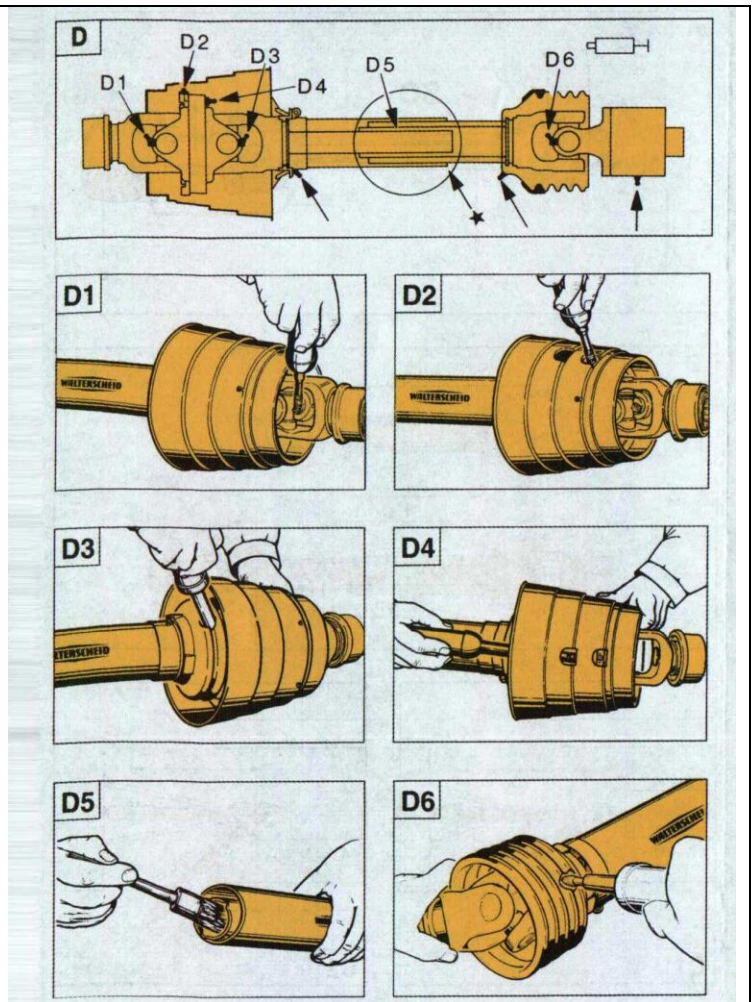

**NOTE:** Lubrication step D5 is only necessary when driveline does not have grease fitting. Separate front and rear halves of driveline and brush with grease.

### CHECK GEAR CASE OIL LEVEL

With spreader on level ground, check oil level at the sight glass on the center gearcase."A"

Add recommended oil as needed. (See Selecting Gear Case Oil)  
To add oil, remove fill cap at the top of the gearcase "B"

B  
A



### GREASE TOP BEATER BEARINGS

Grease the two bearings at the top of the vertical beaters every 8 hours of operation. Rear grease bank on beater side panel

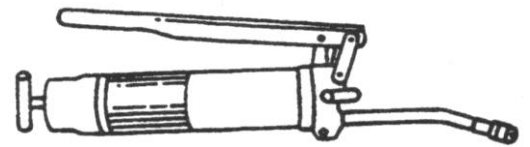
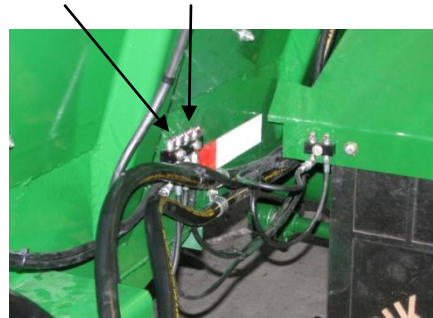

### CHECKING TIRES

1. Check tires daily for damage or noticeably low pressure.
2. Repair any cuts or breaks as soon as possible.
3. Protect tires from exposure to sunlight and petroleum products or chemicals.

<u>Tire Size</u>	<u>Wheel Size</u>	<u>Tire Pressure</u>
700/40-22.5 treaded	22.5 x 16	65 PSI



### LUBRICATE WALKING BEAM PIVOTS

1. Place a jack under the spreader main frame.
2. Raise spreader enough to relieve weight from walking beam.
3. Lubricate grease bank (A) with Moly High Temperature/Extreme Pressure Grease.



### TIGHTENING WHEEL HARDWARE

Operating the spreader with loose wheel hardware will damage the hub or wheel. Tighten hardware after initial transport, after one hour of operation, and every fifty hours thereafter.

Tighten to 475 lb.-ft. in the sequence shown.

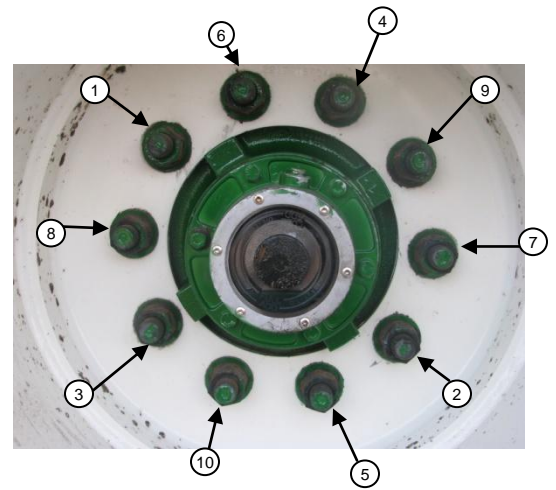

### CHECK OIL LEVEL IN HUBS

See sight glass in hub for proper oil level





### LUBRICATE THE SIX PILLOW BLOCKS UNDER THE SPREADER THAT CARRY THE MAIN POWER SHAFT, USING CENTRAL GREASE LOCATION

1. Lubricate grease fitting with Moly High Temperature/Extreme Pressure Grease.

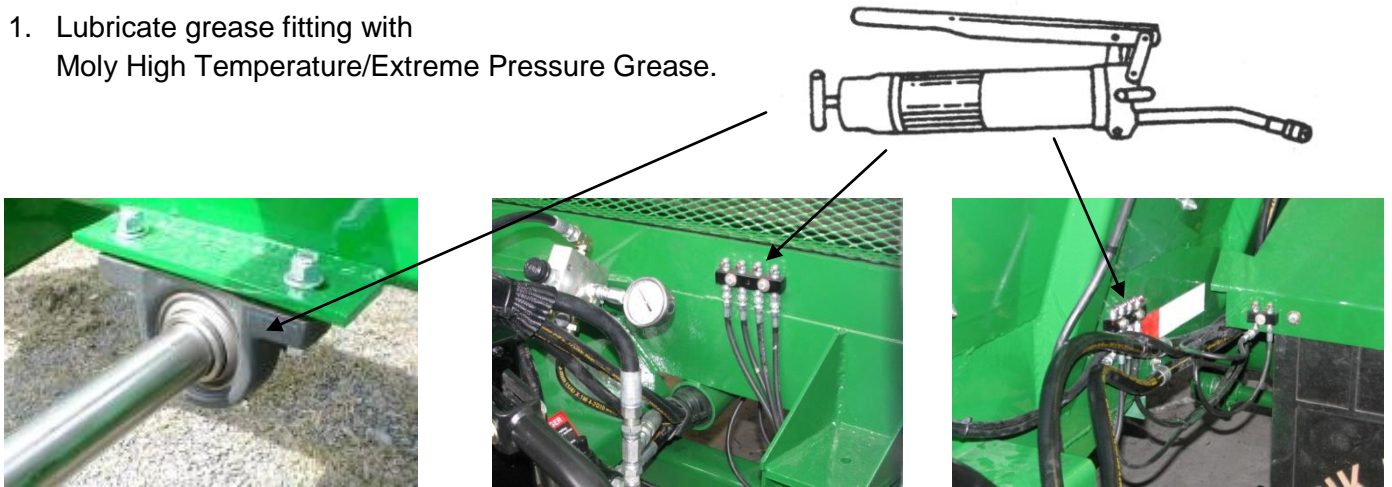

### LUBRICATE WALKING BEAMS USING GREASE BANKS ATTACHED TO THE REAR OF THE FENDERS, TWO ON EACH SIDE



### MAINTAINING SLIP CLUTCH, WALTERSCHEID

The clutch is preset and is not field adjustable.

If you determine that your slip clutch needs maintenance or adjustment, contact your dealer.



### LUBRICATE HITCH EVERY 40 HRS



# SPECIFICATIONS

## SPECIFICATIONS

Tractor Size (Minimum recommended)	200 hp PTO
Weight Spreader, Complete with Implement tires and all Attachments	17040 lb
Load Capacity	48400 lb
Volume Capacity Struck Level Heaped Load	712 cu. ft. 1096 cu. ft.
Beater Speed	420 rpm
Unloading Speed	0-16 ft/min Infinitely Variable
Driveline	Shielded 1000 rpm
Attachments	Endgate

**(Specifications and design subject to change without notice)**







## ***PARTS MANUAL***

Pik Rite, Inc.  
60 Pik Rite Lane  
Lewisburg, PA 17837

Phone: 800-326-9763  
Fax: 570-523-8175  
[www.pikrite.com](http://www.pikrite.com)

***HP 700***  
**Manure Spreader**



### **DIRECTION ARROW**

ARROWS ARE USED WITH ILLUSTRATIONS TO INDICATE THE FRONT OF THE UNIT. "RIGHT-HAND" AND "LEFT-HAND" SIDES ARE DETERMINED BY FACING THE DIRECTION OF MACHINE FORWARD TRAVEL.

### **BOX ENCLOSED ILLUSTRATIONS**

A REFERENCE NUMBER, SHOWN IN THE PARTS LIST, IS ASSIGNED TO A BOX ENCOMPASSING ALL PARTS SOLD AS A SERVICE ASSEMBLY.

### **REFERENCE NUMBER IDENTIFICATION**

000-099	PARTS USED FOR ASSEMBLY
100-199	BOLTS & FASTENERS
800-899	REPLACEMENT PARTS OR SERVICE ASSEMBLIES – USED TO REPLACE OR REBUILD COMPONENTS OF THE MACHINE

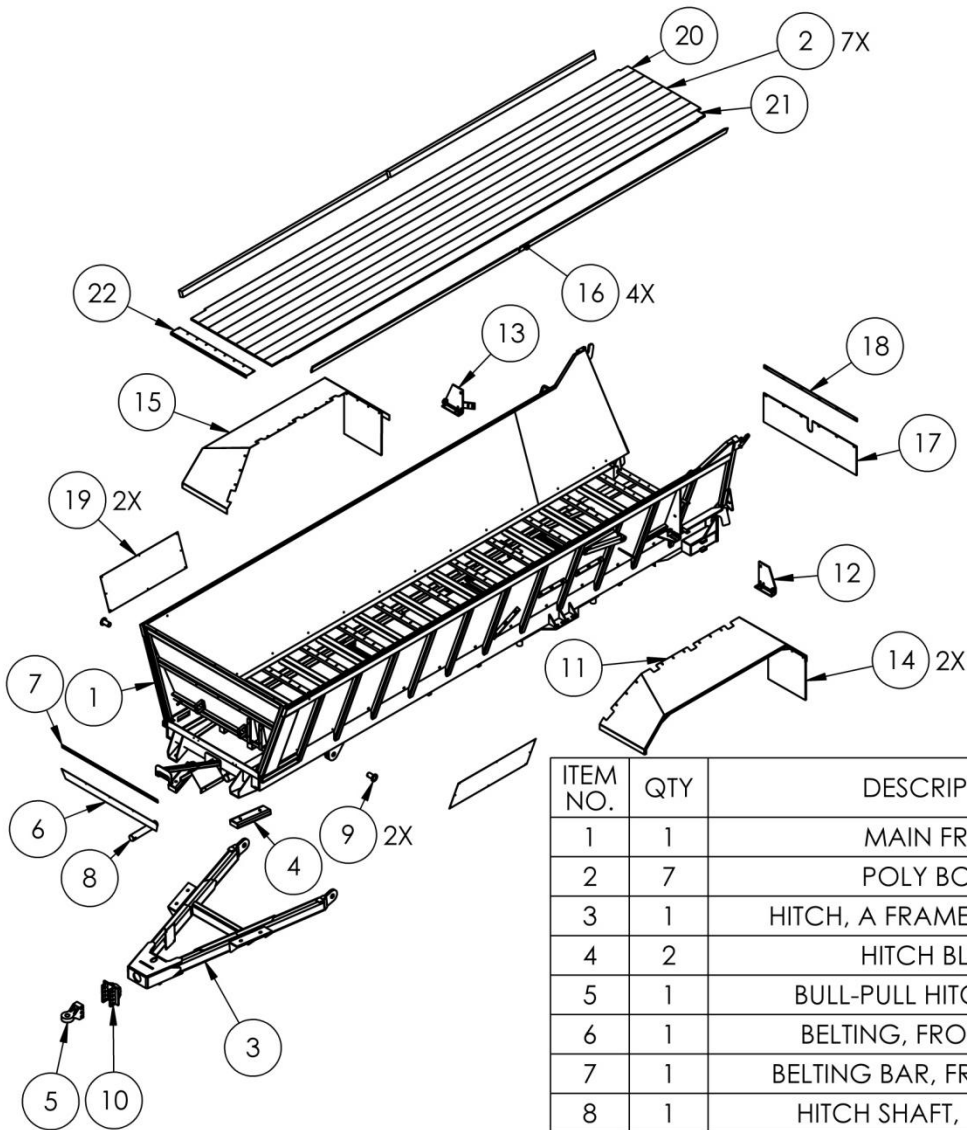

ITEM NO.	QTY	DESCRIPTION	PART NUMBER
1	1	MAIN FRAME	PR63008
2	7	POLY BOARD	PR60009
3	1	HITCH, A FRAME HITCH ASSY	PR63100
4	2	HITCH BLOCK	PR63103
5	1	BULL-PULL HITCH, 3 BOLT	TH-0002
6	1	BELTING, FRONT CHAIN	PR60018
7	1	BELTING BAR, FRONT CHAIN	PR60019
8	1	HITCH SHAFT, HARDNED	PR63101
9	2	TONGUE PIN	PR60025
10	1	HITCH MOUNT	PR80007
11	1	FENDER, LH	PR60022
12	1	ENDGATE MOUNT	PR60023
13	1	ENDGATE MOUNT	PR60024
14	2	MUD FLAP, 24" X 24"	MF-9307
15	1	FENDER, RH	PR60036
16	4	BOTTOM BUMPER RAIL	PR60037
17	1	REAR DEFLECTOR BELT	PR60045
18	1	FLAT BAR, REAR BELTING	PR60046
19	2	DECAL PLATE	PR60043
20	1	POLY BOARD, RH	PR60052
21	1	POLY BOARD, LH	PR60053
22	1	End Cap, Poly Board	PR60063
100	11	3/8 SAE FW ZC	BL-6-SW

## 74215-1-02 -Stone Guard

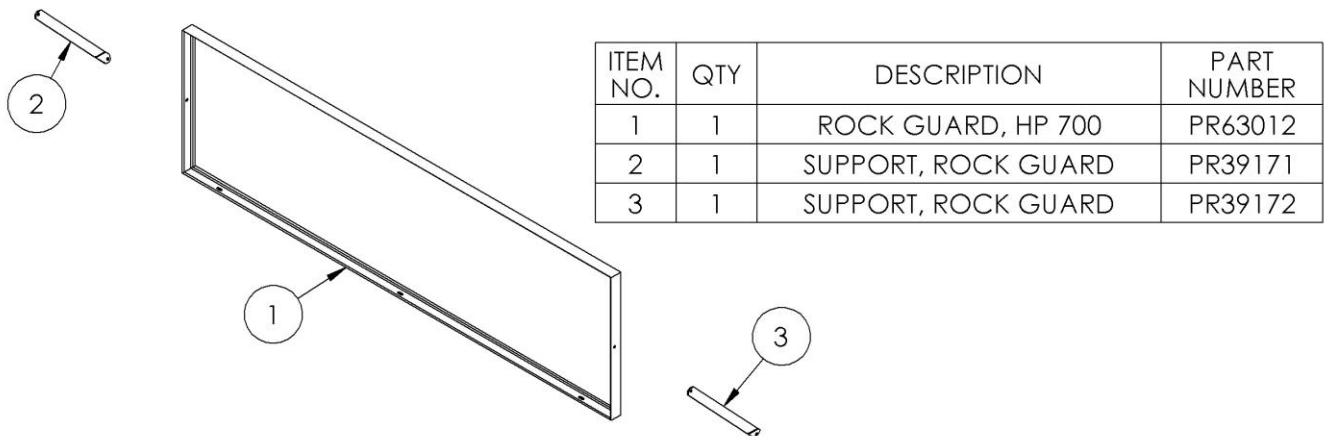

## 74215-1-03 Front Shields

ITEM NO.	QTY	DESCRIPTION	PART NUMBER
1	1	PTO HOLDER	PR63003
2	1	FRONT SPROCKET COVER	PR60001
3	1	BELTING, HOSE HOLDER	PR60403

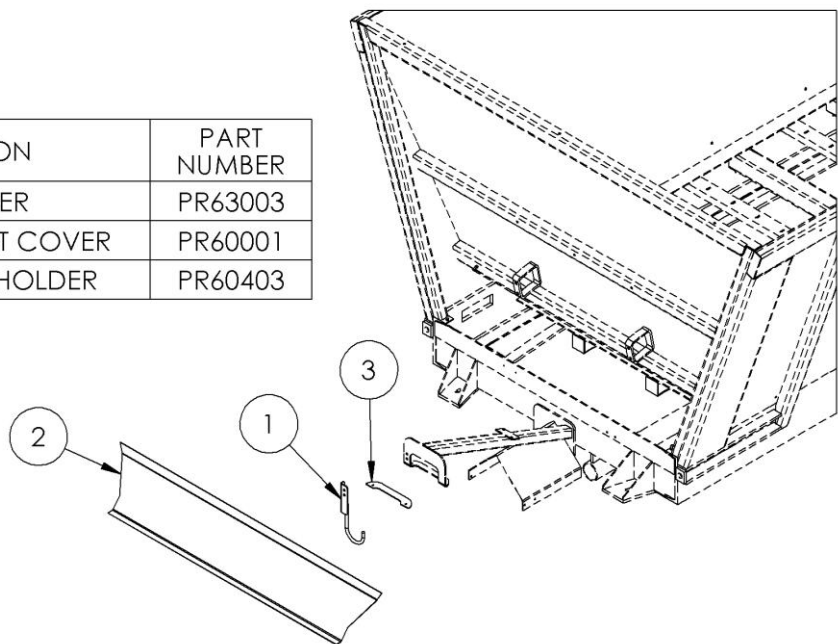

# 74215-1-05 Endgate

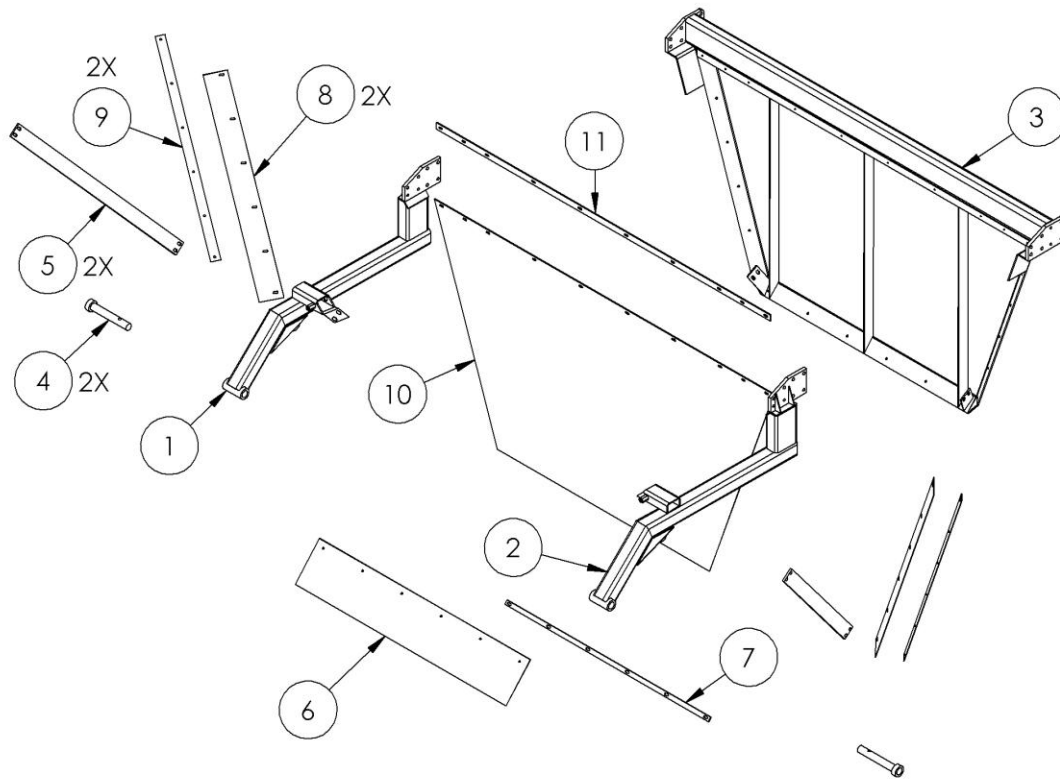

ITEM NO.	QTY	DESCRIPTION	PART NUMBER
1	1	ENDGATE ARM, LH	PR63009
2	1	ENDGATE ARM, RH	PR63010
3	1	ENDGATE	PR60047
4	2	ENDGATE PIN	PR60015
5	2	BAR, ENDGATE BRACE	PR63011
6	1	BELTING, ENDGATE, BOTTOM	PR60013
7	1	BELTING BAR, ENDGATE, BOTT	PR60014
8	2	BELTING, ENDGATE, SIDE	PR60050
9	2	BELTING BAR, ENDGATE, SIDE	PR60051
10	1	BELTING, ENDGATE FLAP	PR60011
11	1	BELTING BAR, ENDGATE FLAP	PR60012

## 74215-1-07 Axle & Walking Beam

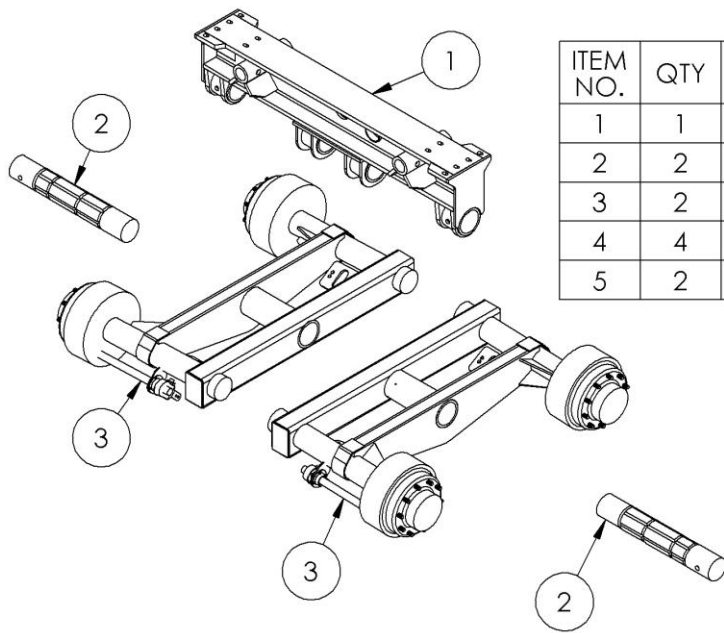

ITEM NO.	QTY	DESCRIPTION	PART NUMBER
1	1	AXLE FRAME	PR80001
2	2	SHAFT, WALKING BEAM PIVOT	PR60003
3	2	ROCKER	PR80004
4	4	DUST COVER	TRL-2750-2
5	2	GREASE MANIFOLD	GF-2-2

74215-1-07A

Opt. – Weight Scale Assy, 5 pt, GT400

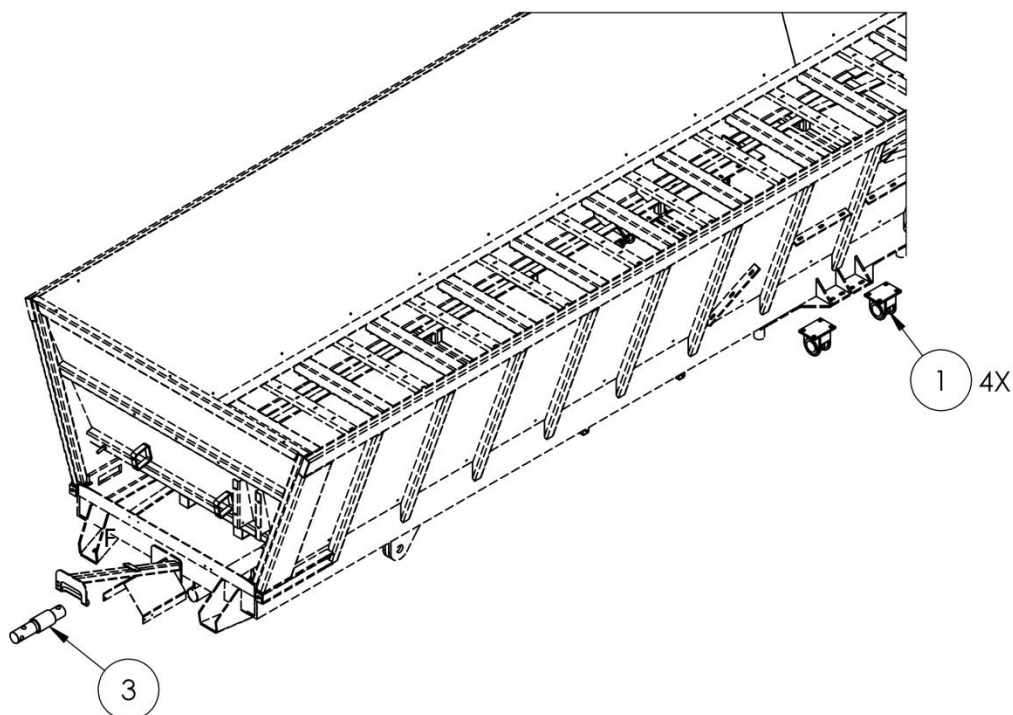

ITEM NO.	QTY	DESCRIPTION	PART NUMBER
1	4	MOUNT, LOAD CELL	PR80003
2	-1	HITCH SHAFT, HARDENED, LONG	PR63101
3	1	5 POINT WEIGH SYSTEM, GT400	SWS-4605
4	1	MOUNT BRACKET- STR TOP MOUNT	SWS-403769
5	1	MOUNT BRACKET-ROBO MOUNTING	SWS-40398
801	0	CELL, DIA 2.875 DB -21	SWS-4605-001
802	0	CELL, DIA 2.875 DB-21 HT	SWS-4605-002
803	0	J-BOX 6 PT.	SWS-4605-003
804	0	J-BOX CABLE, 9M	SWS-4605-004
805	0	POWER CABLE 4-WIRE, 3M CABLE	SWS-4605-005
806	0	GT400 INDICATOR WITH RS232	SWS-4605-006

74215-1-07B

Opt. – Weight Scale Assy, 5 pt, NT460

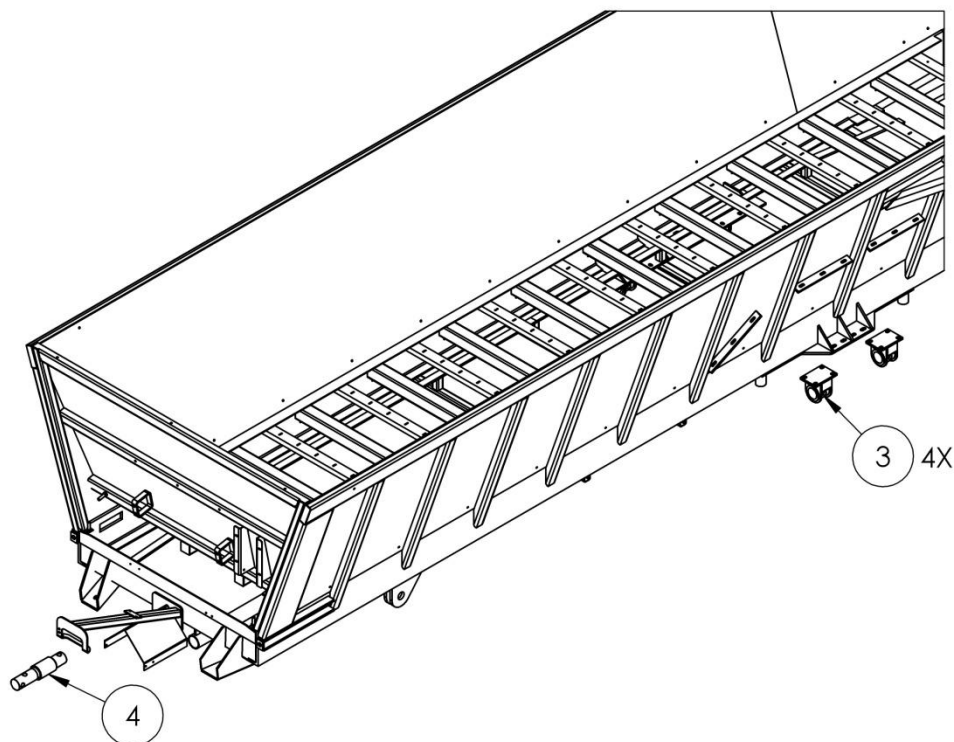

ITEM NO.	QTY	DESCRIPTION	PART NUMBER
1	1	RAIL MOUNT	SWS-4604-006
2	-1	HITCH SHAFT, HARDENED, LONG	PR93101
3	4	MOUNT, LOAD CELL	PR80003
4	1	5 POINT WEIGH SYSTEM, NT460	SWS-4606
5	1	SENSOR SHIELD	SWS-4604-007
6	1	MOUNT BRACKET-EZ3 PLASTIC RAIL	SWS-404353
7	1	MOUNT BRACKET-SC#10X 5/8 FHSTS BLACK ZP	SWS-40378
100	1	1-8 X 5-1/2 BOLT HH C/S G8 ZC	BL-16-550-H8
801	0	CELL, DIA 2.875 DB -21	SWS-4605-001
802	0	CELL, DIA 2.875 DB-21 HT	SWS-4605-002
803	0	J-BOX 6 PT	SWS-4605-003
804	0	J-BOX CABLE, 9M	SWS-6405-004
805	0	POWER CABLE 4-WIRE, 3M CABLE	SWS-4605-005
806	0	INDICATOR, W/AUTOLOG NT460	SWS-4604-003

## 74215-1-08      Wheels & Tires

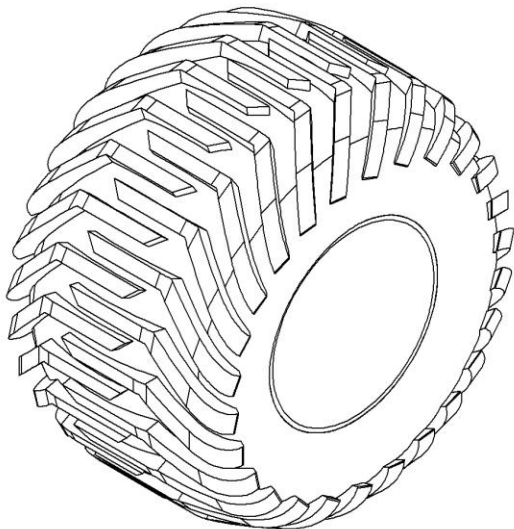

ITEM NO.	QTY	DESCRIPTION	PART NUMBER
1	4	TIRE & WHEEL ASSY, 700/40-22.5	WHM-2000
800	1	WHEEL	WHL-2000
801	1	TIRE, 700/40-22.5	WHT-2000

## 74215-1-09      Opt. – Metering Shield

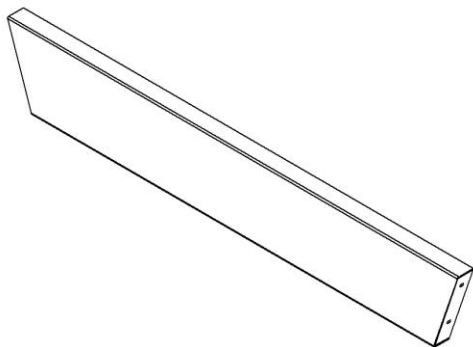

ITEM NO.	QTY	DESCRIPTION	PART NUMBER
1	1	METERING SHIELD	PR63013



## Driveline, 1000 rpm

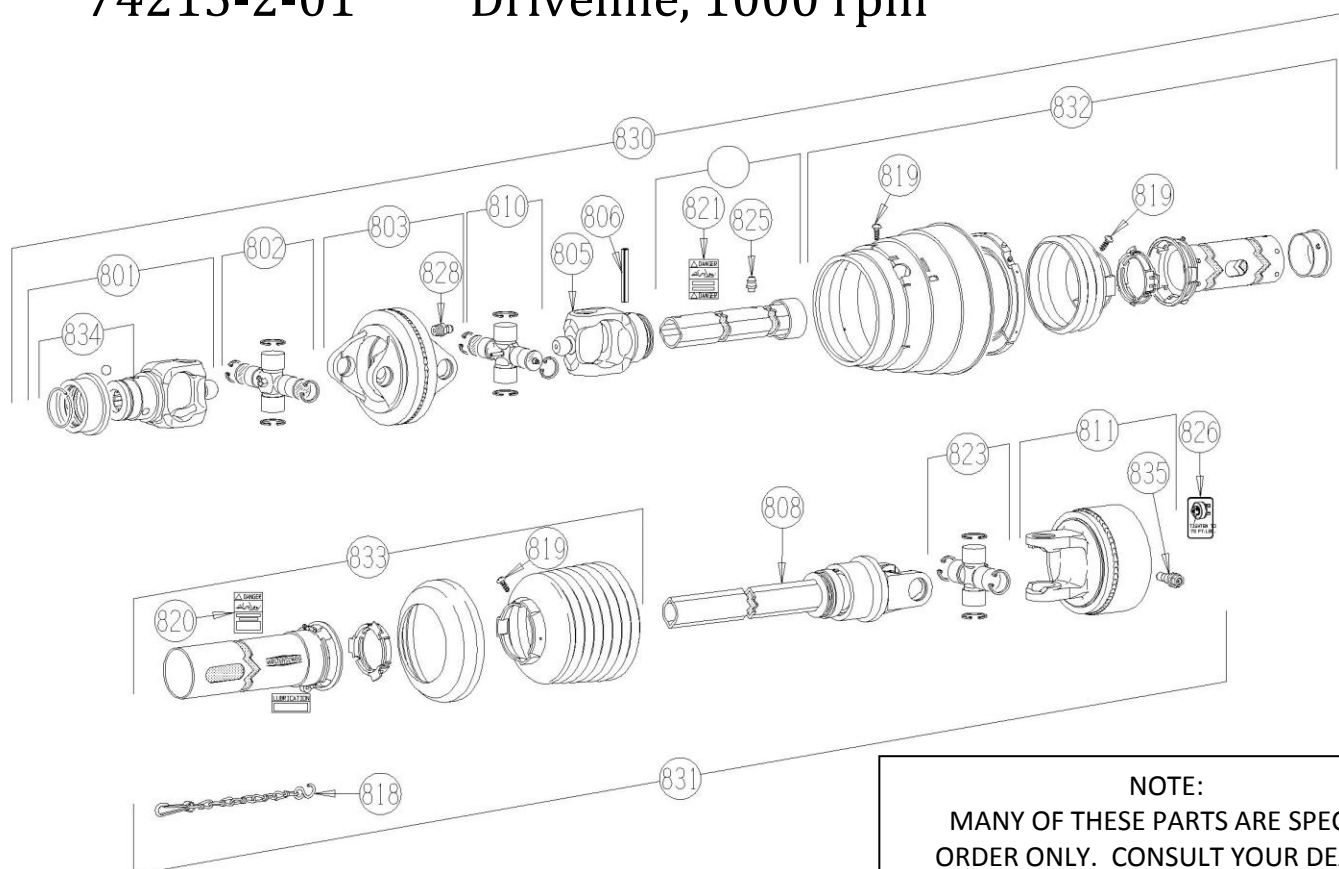

NOTE:  
MANY OF THESE PARTS ARE SPECIAL  
ORDER ONLY. CONSULT YOUR DEALER  
FOR AVAILABILITY

ITEM NO.	QTY	DESCRIPTION	PART NUMBER
1	1	DRIVELINE, 1 3/4-20 SPLINE	PTS-1021
801	1	YOKE, 1 3/4-20 SPLINE	PTS-1021A
802	1	CROSS & BEARING KIT	PTS-1021B
803	1	DOUBLE YOKE	PTS-1005B
805	1	INBOARD YOKE S5	PTS-1021C
806	1	SPRING PIN, 10X 75	PTB-1014C
808	1	OVERRUNNING CLUTCH	PTS-1021D
810	1	EXTENDED LUBE CROSS & BEARING KIT	PTS-4001B
811	1	CUT-OUT CLUTCH	PTS-1021E
812	1	CV GUARD & BEARING ASSY	PTS-1021K
813	1	FLEX NET & GUARD ASSY	PTS-1021L
814	2	PTO SHIELD BEARING RING	PTS-1002J
817	1	GUARD CONE 9 RIB	PTS-1021F
818	1	PTO SHIELD SAFETY CHAIN	PTS-1002K

ITEM NO.	QTY	DESCRIPTION	PART NUMBER
819	8	SCREW	PTS-1010K
820	1	DECAL, OUTER	PTS-1010L
821	1	DECAL, INNER	PTS-1010M
822	1	REINFORCING COLLAR	PTS-8100D
823	1	CROSS & BEARING KIT	PTS-1021G
824	1	SUPPORT BEARING	PTS-1021H
825	1	ZERK	PTB-1014L
826	1	DECAL	PTS-1009J
827	1	LUBRICATION DECAL	PTS-1021P
828	1	ZERK, DOUBLE YOKE	PTS-1008C
830	1	FRONT HALF SHAFT	PTS-1021FH
831	1	REAR HALF SHAFT	PTS-1021RH
832	1	INNER GUARD KIT	PTS-1021FS
833	1	OUTER GUARD KIT	PTS-1021RS
834	1	ASG COLLAR KIT	PTS-1008R
835	1	CC LOCK ASSEMBLY	PTS-1009K

74215-2-02

## Main Drive Shaft

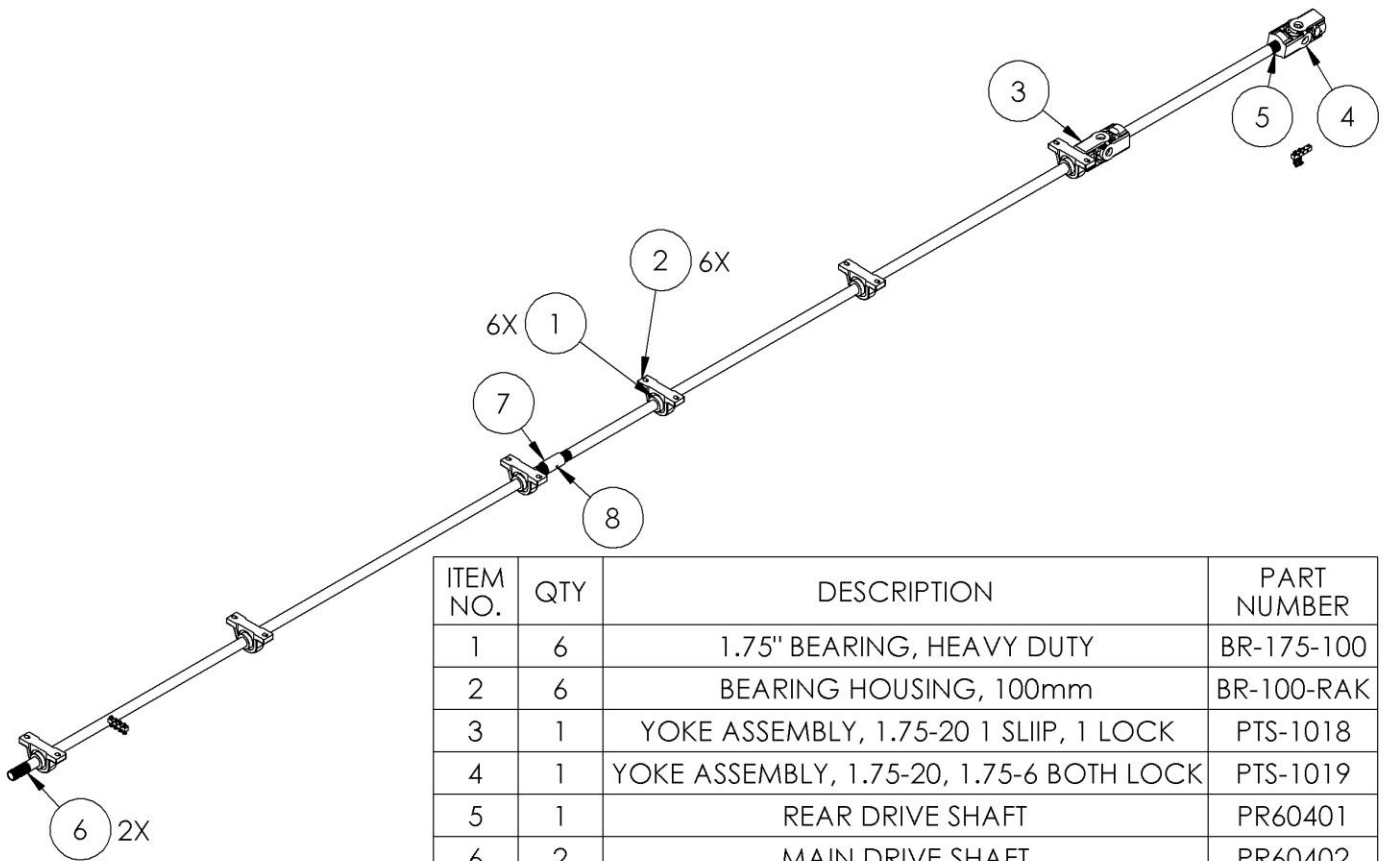

ITEM NO.	QTY	DESCRIPTION	PART NUMBER
1	6	1.75" BEARING, HEAVY DUTY	BR-175-100
2	6	BEARING HOUSING, 100mm	BR-100-RAK
3	1	YOKE ASSEMBLY, 1.75-20 1 SLIIP, 1 LOCK	PTS-1018
4	1	YOKE ASSEMBLY, 1.75-20, 1.75-6 BOTH LOCK	PTS-1019
5	1	REAR DRIVE SHAFT	PR60401
6	2	MAIN DRIVE SHAFT	PR60402
7	1	COUPLER, 1.75 X 20 SPLINE	PR60404
8	1	SPS 0.25x2.25	PIN-4-36

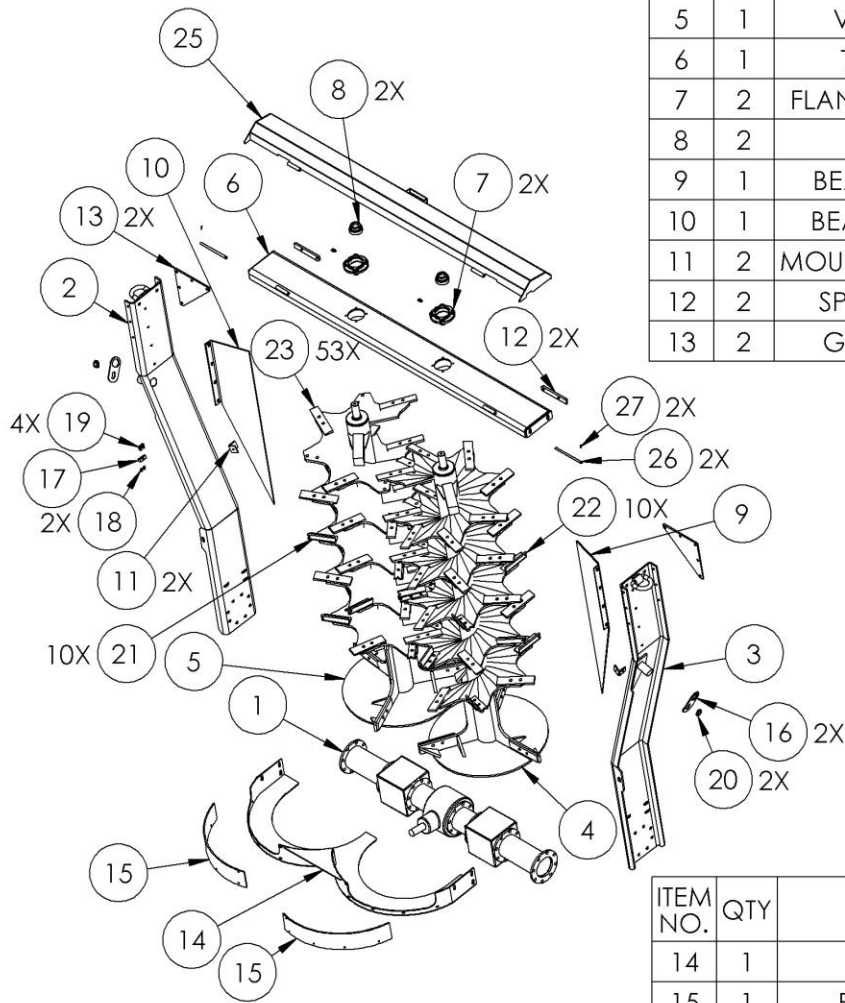

ITEM NO.	QTY	DESCRIPTION	PART NUMBER
1	1	GEARBOX, HP SPREADER	VTB-1893-A1
2	1	BEATER PANEL, RH	PR63500
3	1	BEATER PANEL, LH	PR63501
4	1	VERTICAL BEATER, LH	VTB-0040
5	1	VERTICAL BEATER, RH	VTB-0041
6	1	TOP BEARING PLATE	PR63502
7	2	FLANGE BEARING HOUSING	BR-085-4PF
8	2	1.75" BEARING	BR-175-085-I
9	1	BEATER PANEL WING, LH	PR64011
10	1	BEATER PANEL WING, RH	PR64012
11	2	MOUNT, BEATER PANEL WING	PR60058
12	2	SPACER, BEATER PANEL	PR60060
13	2	GUSSET, BEATER PANEL	PR60059

ITEM NO.	QTY	DESCRIPTION	PART NUMBER
14	1	BEATER PAN	PR63503
15	1	BEATER PAN BELTING	PR63504
16	2	BEATER LOCKING PLATE	PR63505
17	1	2" GREASE MANIFOLD	GF-2-2
18	2	GREASE FITTING 1/8 NPT 45°	GF-1827-45
19	4	1/8MP X 1/8 FPX	A-1404-02-02
20	2	1/4" Lynch Pin	PIN-250L
21	10	BEATER BLADE, RH	VTB-1899-B3
22	10	BEATER BLADE, LH	VTB-1899-C3
23	53	BLANCED BEATER KNIFE	VTB-1899-F3
24	11	GEAR LUBE	HP-1038
25	1	COVER, BEATER BEARING	PR63506
26	2	HINGE PIN	PR70133
27	2	ROLL PIN, 3/16 X 7/8	PIN-3-14

# 74215-2-03A

# Vertical Beater Gearbox

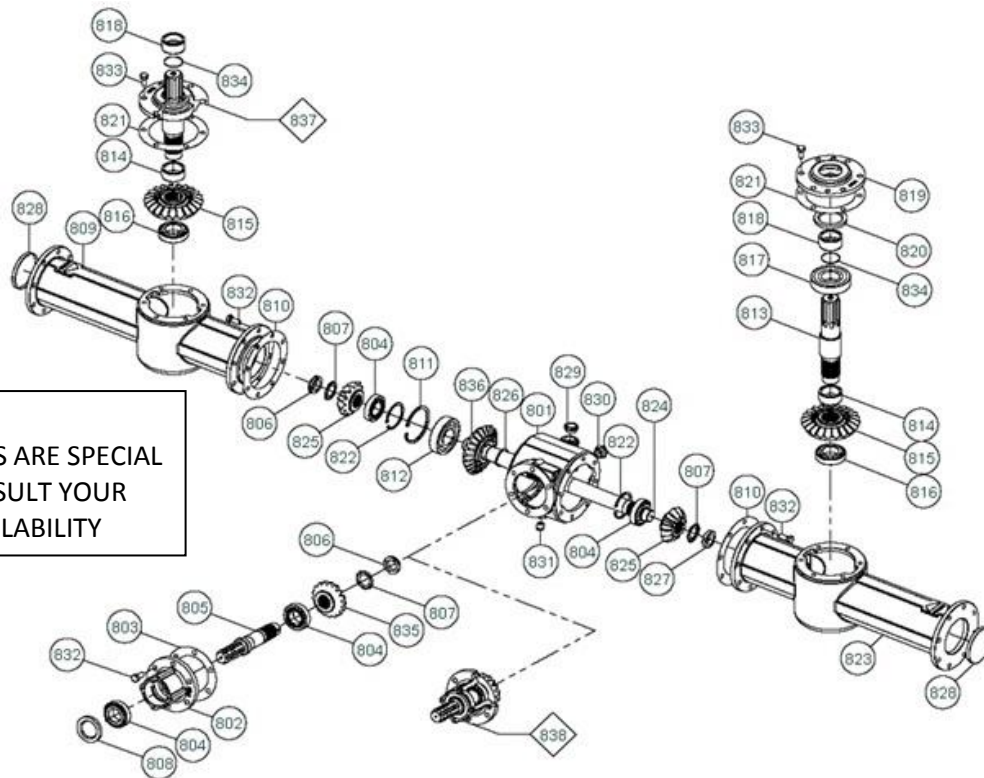

ITEM NO.	QTY	DESCRIPTION	PART NUMBER	ITEM NO.	QTY	DESCRIPTION	PART NUMBER
1	0	1,000 rpm GEARBOX	VTB-1893-A1	820	2	OIL SEAL	VTB-1899-S1
801	1	HOUSING	VTB-1899-A1	821	2	GASKET	VTB-1899-R1
802	1	HUB	VTB-1899-J2	822	2	SNAP RING	VTB-1893-E1
803	1	GASKET	VTB-1899-H2	823	1	RIGHT SPACER TUBE	VTB-1893-F1
804	4	BEARING 32209	VTB-1899-G1	824	1	SHAFT	VTB-1899-C1
805	1	SHAFT	VTB-1899-L2	825	2	BEVEL PINION Z=13	VTB-1899-F1
806	2	THREADED RING	VTB-1899-D1	826	1	CIRCLIP E 55	VTB-1899-K1
807	3	WASHER	VTB-1899-E1	827	1	THREADED RING	VTB-1899-L1
808	1	OIL SEAL	VTB-1899-K2	828	2	END CAP	VTB-1893-G1
809	1	RIGHT SPACER TUBE	VTB-1893-B1	829	1	OIL PLUG, 1" GAS.	VTB-1899-E2
810	2	GASKET	VTB-1899-A2	830	1	OIL LEVEL INDICATOR	VTB-1899-C2
811	1	SNAP RING	VTB-1893-C1	831	1	OIL PLUG, 1/2" GAS.	VTB-1899-D2
812	1	BEARING 6311	VTB-1899-H1	832	22	SCREW, HEX-HD M14 X 35	VTB-1899-Z1
813	2	SPINED SHAFT	VTB-1893-D1	833	12	SCREW, HEX-HD M14 X 30	VTB-1899-P1
814	2	SPACER	VTB-1899-V1	834	2	O-RING 2212	VTB-1899-N1
815	2	GEAR Z=22	VTB-1899-W1	835	1	BEVEL PINION Z=17	VTB-1899-G2
816	2	BEARING 32210	VTB-1899-X1	836	1	GEAR Z=24	VTB-1899-J1
817	2	BEARING 6311-2RS	VTB-1899-T1	837	2	CAP	VTB-1893-H1
818	2	SPACER	VTB-1899-M1	838	1	HUB COMPLETE, GEARBOX	VTB-1899-M2
819	2	CALOTTE	VTB-1899-Q1				

## 74215-2-04 Web Chain Drive

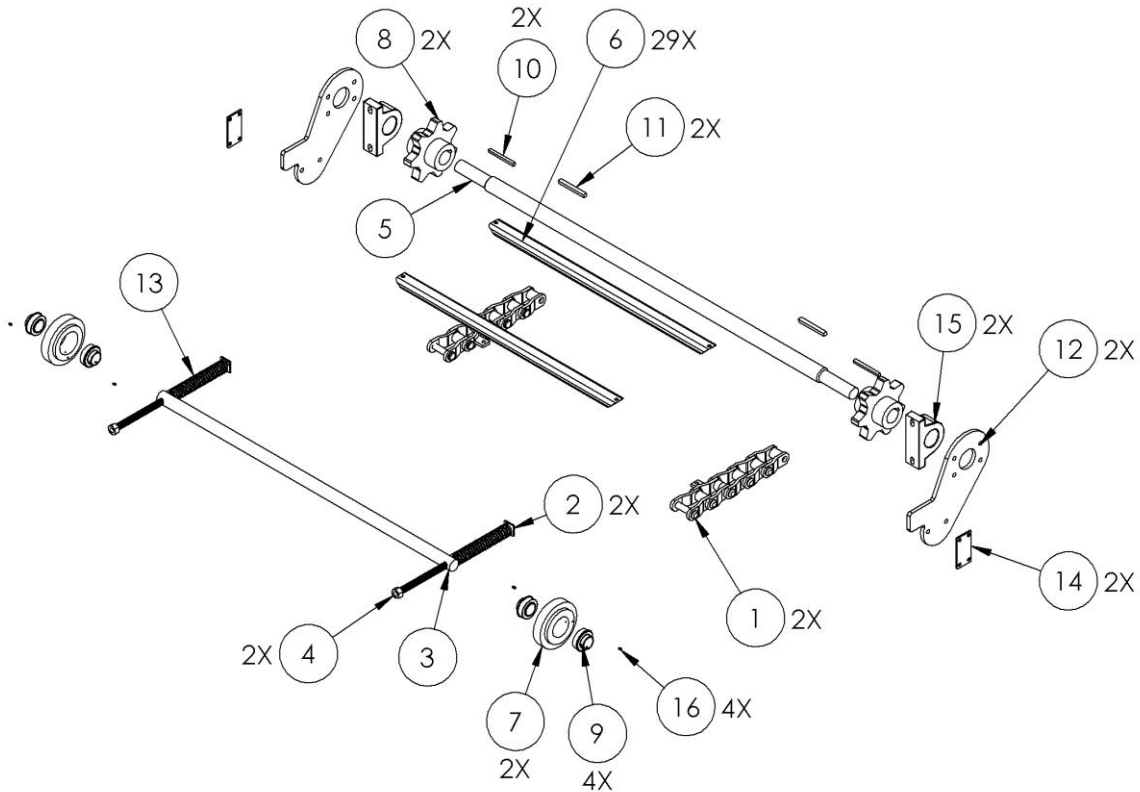

ITEM NO.	QTY	DESCRIPTION	PART NUMBER
1	0	PULL CHAIN, RIGHT HAND SIDE, PINTLE STYLE	PR60415
1	0	PULL CHAIN, LEFT HAND SIDE, PINTLE STYLE	PR60416
1	2	PULL CHAIN, PINTLE WH124HD STYLE, SS PIN, TAB CENTER OF LINK	PR60422
2	2	ADJUSTMENT PLATE, FRONT DRIVE	PR60016
3	1	CHAIN SHAFT, FRONT IDLER	PR60017
4	2	TENSION BOLT, CHAIN SPREADER	PR60041
5	1	SHAFT, APRON CHAIN, DUAL DRIVE	PR60040
6	37	FLIGHT MILL CHAIN, TUB CENTER ON CHAIN	PR60420
7	2	SPREADER CHAIN ROLLER	RLR-0027
8	2	DRIVE SPOCKET, WH124 PINTLE CHAIN, 2 PIECE SPOCKET, 2 1/2 BORE, 5/8 KEYWAY	PR60424
9	4	BEARINGS, 2" ER	BR-200-ER
10	2	1/2IN KEY 5.375IN LONG, HIGH CARBON STEEL	KEY-8-8-86-HCS
11	2	5/8IN KEY, 5.50IN LONG, 4140 MATERIAL	KEY-10-10-550-HCS
12	2	TORQUE PLATE, GEARBOX	PR60066
13	2	SPRING, EXTRA HEAVY 2 HOLE DIA., 1 ROD X 12 LONG	SPRG-1200-EH
14	2	MOUNT, TORQUE PLATE, GEARBOX	PR60068
15	2	HEAVY DUTY 2-1/2 BRG ASSY, W/PILLOW BLOCK	BR-250-HD
16	4	GREASE FITTING 1/4" X 28 STRAIGHT	GF-1428

ITEM NO.	QTY	DESCRIPTION	PART NUMBER
100	74	1/2 X 1-1/2 HH G8	BL-8-150-H8
101	156	1/2 SAE FW ZC	BL-8-SW
102	74	1/2-13 LN NYLON INSERT ZC	BL-8-LN
103	8	1/2-13 X 1-3/4 HH G5 ZC	BL-8-175-H
104	8	1/2 SPLIT LW ZC	BL-8-LW
105	4	5/8-11 X 2-1/2 HH G8 ZC	BL-10-250-H-8
106	4	5/8 SPLIT LW ZC	BL-10-LW
107	4	5/8 SAE FW ZC	BL-10-SW
108	2	1-8 JAM NUT HEX GR 5 YZ	BL-16-JN
109	2	1/4 UNC X 3/4 CARRIAGE BOLT G5 ZC	BL-4-075-C
110	1	1/4' U BOLT 1 1/8 WIDE 2 LONG	BL-4-200-U
111	4	1/4 USS FW ZC	BL-4-FW
112	2	1/4-20 HEX LN NE ZC	BL-4-LN
113	2	1/4 SPLIT LW ZC	BL-4-LW
114	2	1/4-20 HEX FIN NUT ZC	BL-4-N
115	6	5/16 UNC X 1 HH C/S BOLT GR5 ZINC	BL-5-100-H
116	12	5/16 USS FW ZC	BL-5-FW
117	6	5/16-18 HEX LN NE ZC	BL-5-LN
118	2	3/8-16 X 1/2 KNURLED POINT SET SCREW	BL-6-050-SC
	2	1/4 MALE PIPE X 1/4 PUSH LOC	A-4124-4-4
	2	1/4 NPT CLOSE NIPPLE, BRASS	AN-4-CLB
	1	1/4 NPT CLOSE NIPPLE, BRASS, WITH HEX CENTER	AN-4-CLB-H
	1	1/4 X 1/4 X 1/4 BRASS TEE	ATB-4-4-4
	2	1/4 X 1/4 X 1/4 WHITE NYLON HOSE BARB WYE	AYN-4-4-4
	12	PUSH LOC HOSE 1/4 @ FT	H4-PL
	6	HYDRAULIC HOSE HOLDER 3/8	HA-1031
	2	3 KEY STOCK	KEY-10-10-300-HCS
	2	ROLL PIN 1/4 X 2.25	PIN-4-36
	0	FLIGHT, MILL CHAIN, ANGLE	PR60419
	2	1/4 BRASS BALL VALVE	VLV-025-B
	1	5 QUART RESERVOIR WITH BLACK CAP, NVE STYLE	VPA-NVE-36001
	1	CHAIN OIL SYSTEM BRACKET	PR70316
	1	CHAIN OIL SYSTEM BRACKET	PR70330

74215-2-05

## Web Chain Gearbox

NOTE:  
MANY OF THESE PARTS ARE SPECIAL  
ORDER ONLY. CONSULT YOUR  
DEALER FOR AVAILABILITY

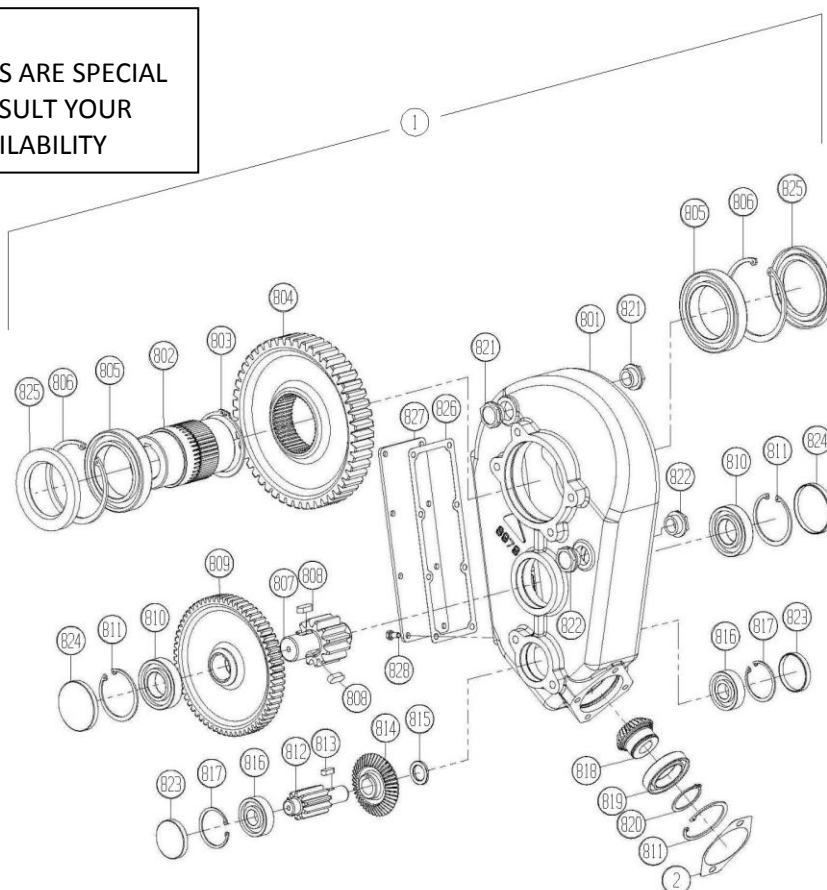

ITEM NO.	QTY	DESCRIPTION	PART NUMBER	ITEM NO.	QTY	DESCRIPTION	PART NUMBER
1	2	GEARBOX	GBX-1893	812	1	PINION Z=10	GBX-1893-L
2	0	FLANGE GASKET	PR60026	813	1	KEY 8 X 7 X 25	GBX-1893-M
3	2	ORBIT MOTOR	HM-1893	814	1	GEAR Z=43	GBX-1893-N
4	3	GEAR LUBE, 80W90	HP-1038	815	1	SPACER	GBX-1893-O
100	12	14mm X 40mm, BOLT	BL-M-14-40-H	816	2	BEARING 6305	GBX-1893-P
101	12	5/8 SPLIT LW ZC	BL-10-LW	817	2	CIRCLIP I 62	GBX-1893-Q
801	1	HOUSING	GBX-1893-D	818	1	PINION Z=28	GBX-1893-R
802	1	GEARBOX HUB	GBX-1893-B	819	1	BEARING	GBX-1893-S
803	1	INTERNAL RETAINING CLIP	GBX-1893-C	820	1	CIRCLIP E 50	GBX-1893-T
804	1	GEAR Z=54	GBX-1893-E	821	2	OIL PLUG 1" GAS	GBX-1893-U
805	2	BALL BEARING, OPEN	GBX-1893-A	822	2	OIL LEVEL INDIC. 1" GAS.	GBX-1893-V
806	2	INTERNAL CLIP	GBX-1893-F	823	2	PLUG	GBX-1893-W
807	1	PINION Z=12	GBX-1893-G	824	2	PLUG	GBX-1893-X
808	2	KEY 12 X 8 X 30	GBX-1893-H	825	2	SHAFT SEAL, GEARBOX	GBX-1893-Y
809	1	GEAR Z=63	GBX-1893-I	826	1	GASKET	GBX-1893-Z
810	2	BEARING 6208	GBX-1893-J	827	1	COVER	GBX-1893-A1
811	3	CIRCLIP I 80	GBX-1893-K	828	8	SCREW, HEX-HD M 8 X 16	GBX-1893-B1

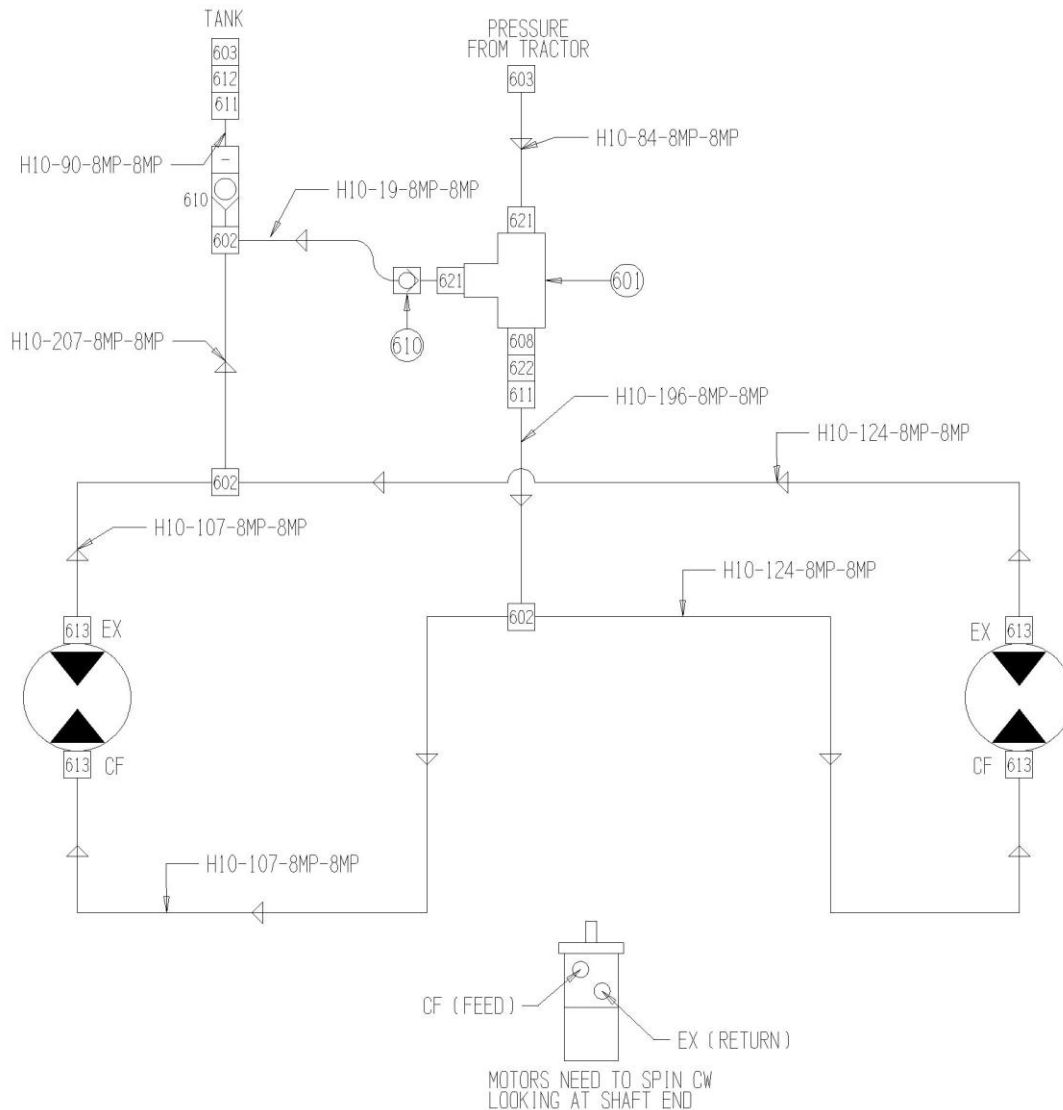

ITEM NO.	QTY	DESCRIPTION	PART NUMBER
601	1	RELIEF VALVE	HV-RV-3H
602	3	SWIVEL T 1/2" NPTF	A-1603-8-8-8
603	2	TRACTOR QUICK CPLR	A-QD2010-8-8
604	1	TEST POINT PLUG	HA-1004-4
605	1	8 SAE X 1/2 FPX90	A-6901-8-8
606	1	8 SAE X 1/2 FPX	A-6900-8-8
607	1	1/2 MP X 1/2 FPX90	A-1501-8-8
608	3	10 SAE X 1/2 MPT	A-6401-10-8
610	1	1/2 PARKER CHECK VALVE	HV-CKV-800S
611	2	1/2 MP TO 1/2 FPX	A-1404-8-8
612	1	HEX NIPPLE, 1/2 X 1/2	A-5404-8-8

ITEM NO.	QTY	DESCRIPTION	PART NUMBER
613	4	10 SAE X 1/2 FPX 45	A-6902-10-8
614	1	5/8" HOSE 1/2 X 1/2	H10-84-8MP-8MP
615	1	5/8 HOSE X 1/2MP X 1/2MP	H10-90-8MP-8MP
616	2	5/8" HOSE 1/2 MP X 1/2 MP	H10-107-8MP-8MP
617	1	5/8" HOSE 1/2 MP X 1/2 MP	H10-196-8MP-8MP
618	1	5/8" HOSE 1/2 MP X 1/2 MP	H10-207-8MP-8MP
619	2	5/8" HOSE 1/2 MP X 1/2 MP	H10-124-8MP-8MP
620	1	5/8" HOSE 1/2 MP X 1/2 MP	H10-19-8MP-8MP
621	2	10 SAE X 1/2 FPX90	A-6901-10-8
622	1	VALVE, BALL	VLV-050-BHP
623	1	HYD. PRESSURE GAUGE	HA-1004-G
624	1	TEST POINT PROBE	HA-1005-T



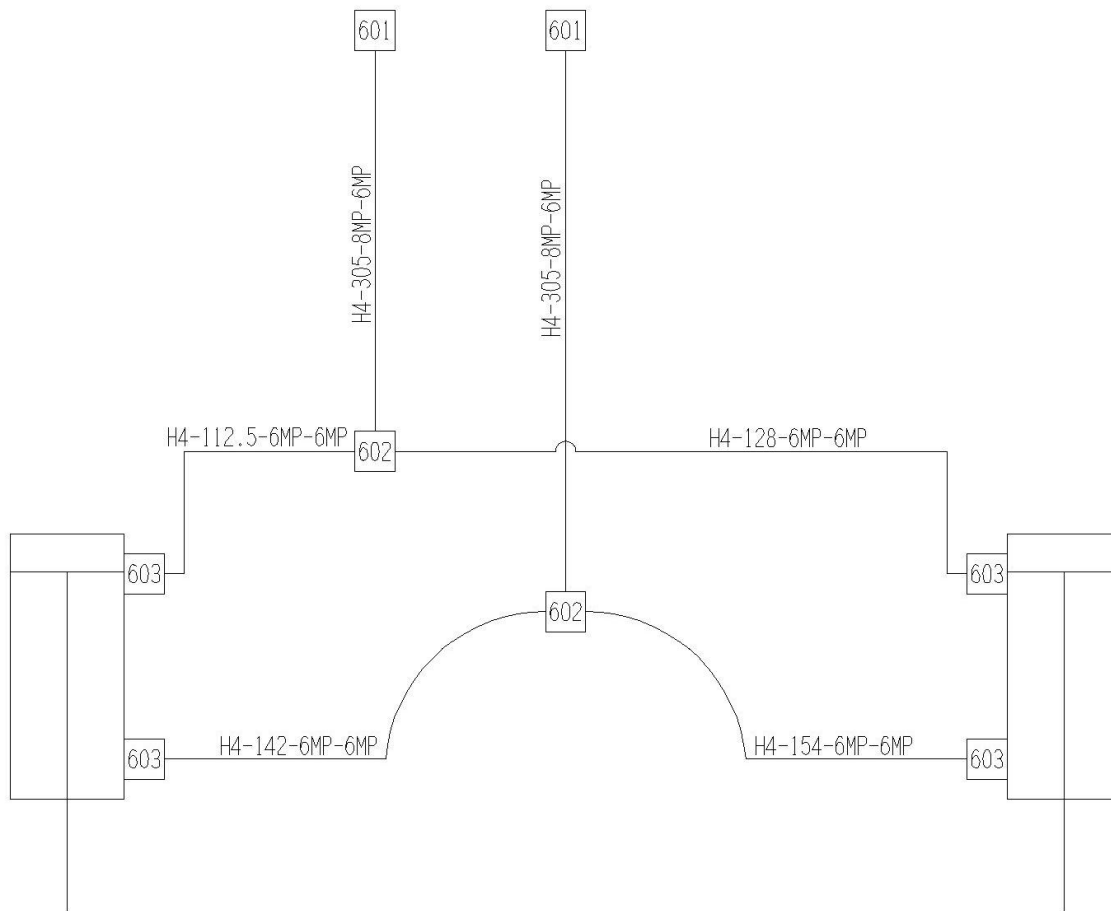

ITEM NO.	QTY	DESCRIPTION	PART NUMBER
601	2	TRACTOR QUICK CPLR	A-QD2010-8-8
602	2	SWIVEL T 3/8" NPTF	A-1603-6-6-6
603	4	8 SAE X 3/8FPX90	A-6901-8-6
604	2	1/4" HOSE 1/2MP X 3/8MP	H4-305-8MP-6MP
605	1	1/4" HOSE 6MP X 6MP	H4-112.5-6MP-6MP
606	1	1/4" HOSE 3/8MP X 3/8MP	H4-128-6MP-6MP
607	1	1/4" HOSE 6MP X 6MP	H4-142-6MP-6MP
608	1	1/4" HOSE 3/8MP X 3/8MP	H4-154-6MP-6MP

74215-3-03

## Endgate Cylinders

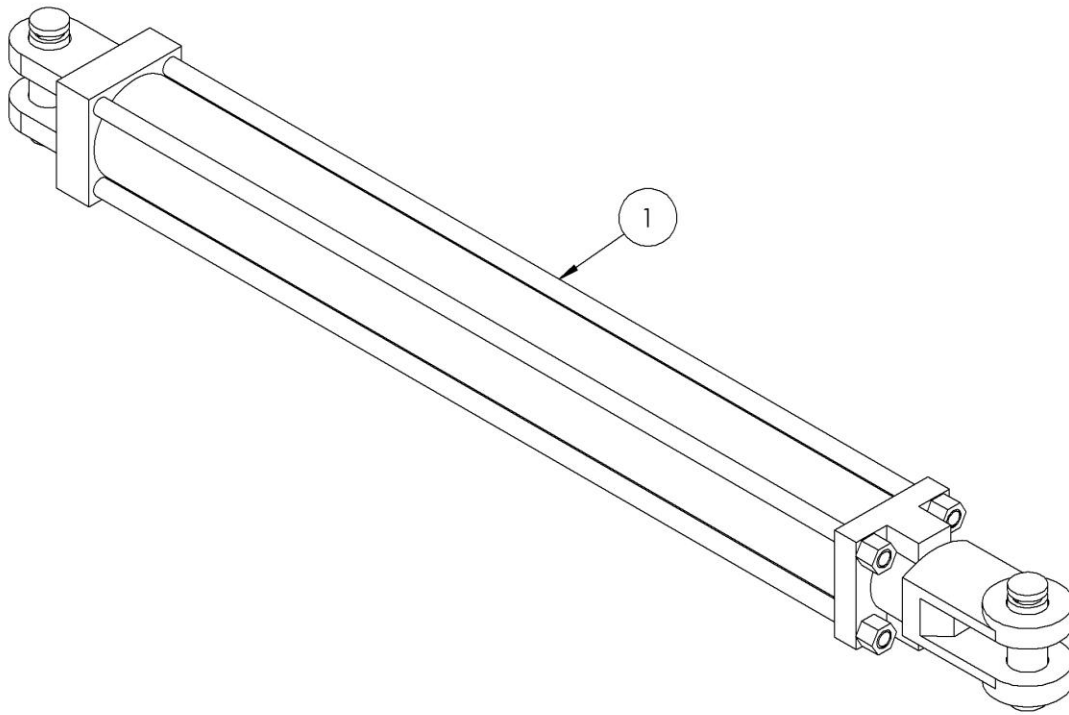

ITEM NO.	QTY	DESCRIPTION	PART NUMBER
1	2	HYDRAULIC CYLINDER	HC-250-2408-0R
801	0	SEAL KIT	HC-250-125

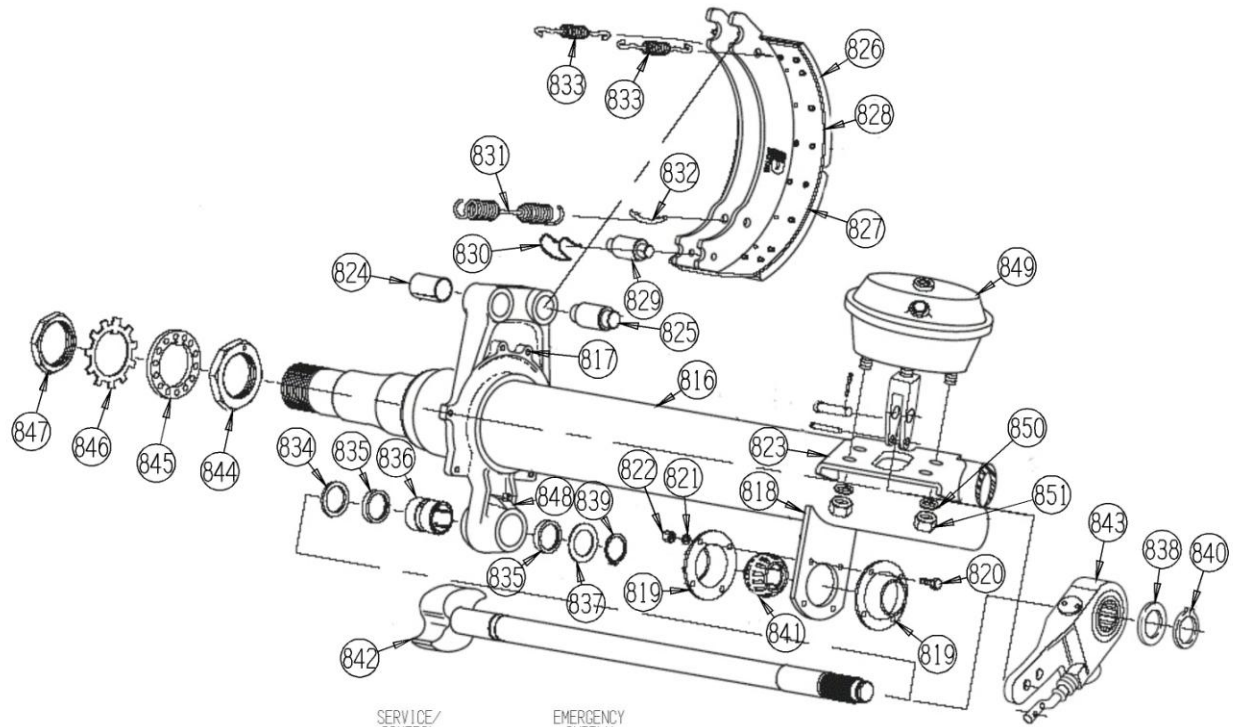

**NOTE:**  
MANY OF THESE PARTS ARE SPECIAL  
ORDER ONLY. CONSULT YOUR DEALER  
FOR AVAILABILITY

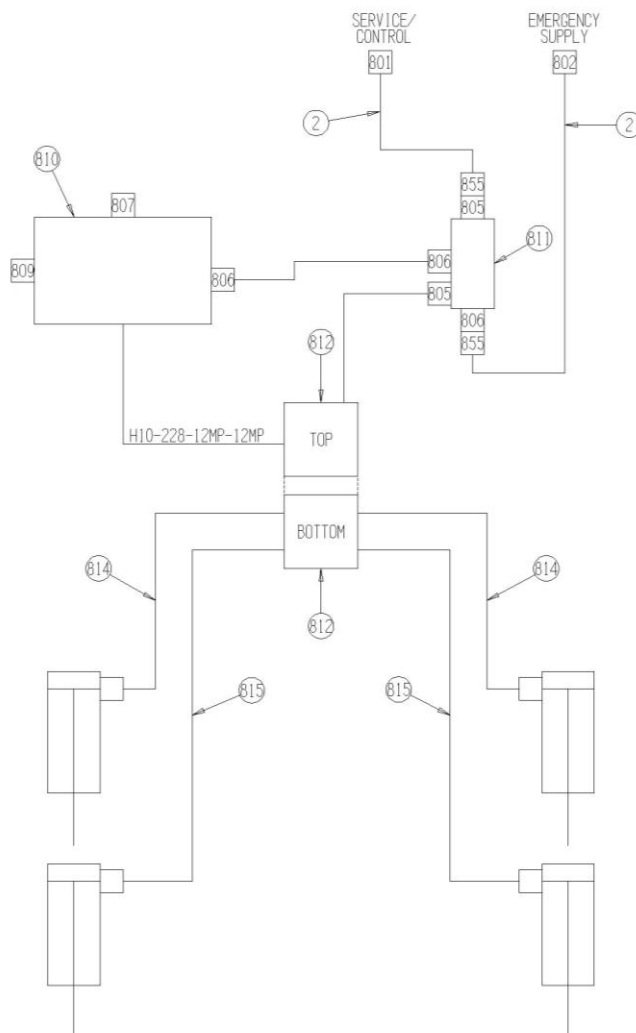

ITEM NO.	QTY	DESCRIPTION	PART NUMBER
1	1	TRAILER AIR BRAKE	TRL-BRK-0001
2	1	AIRLINE SET FOR AIR BRAKES	TRL-BRK-0002
3	24	3/8" NYLON TUBING	AIR-N6DOT
4	2	1/82" NPT COUPLER	A-1405-8-8
5	1	3/4MP X 3/4FPX 90	A-1501-12-12
6	1	3/4MP X 3/4FPX	A-1404-12-12
7	2	PIPE ADAPTER	A-5405-4-6
8	2	UNIV. GLADHAND HOLDER	LA-309
9	4	AIR CHAMBER ASSY	TRL-BRK-0001-34
10	1	PANEL, AIR COMP. SHIELD	PR60032
601	1	5/8" HOSE 3/4MP X 3/4MP	H10-228-12MP-12MP
801	1	GLADHAND - SERVICE	TRL-BRK-0003
802	1	GLADHAND - EMERGENCY	TRL-BRK-0004
803	2	1/2" BULKHEAD COUPLING	TRL-BRK-0005
804	2	3/8 X 1/4 MALE CONN.	TRL-BRK-0006
805	3	3/8 X 3/8 MALE CONN.	TRL-BRK-0007
806	5	3/8 X 3/8 MALE ELBOW	TRL-BRK-0008
807	1	1/4" DRAIN VALVE	TRL-BRK-0009
808	1	3/4" HEX NIPPLE	TRL-BRK-0010
809	1	3/8" PIPE PLUG	TRL-BRK-0011
810	1	AIR TANK	TRL-BRK-0012
811	1	EMERGENCY SPOOL	TRL-BRK-0013
812	1	AIR RELAY VALVE	TRL-BRK-0014
814	2	3/8" X 40" AIR BRAKE HOSE	TRL-BRK-0016
815	2	3/8" X 72" AIR BRAKE HOSE	TRL-BRK-0017
816	1	BEAM OPTIONS	TRL-BRK-0001-01
817	2	SPIDER	TRL-BRK-0001-02
818	2	BRACKET-CAMSHAFT SUPP.	TRL-BRK-0001-03
819	4	RETAINER PLATE	TRL-BRK-0001-04
820	8	BOLT, RET. PLATE ATTACH.	TRL-BRK-0001-05
821	8	LOCKWASHER, COVER ATT.	TRL-BRK-0001-06

ITEM NO.	QTY	DESCRIPTION	PART NUMBER
822	8	NUT, RET. PLATE ATTACH.	TRL-BRK-0001-07
823	2	BRACKET, AIR CHAMBER MOUNTING	TRL-BRK-0001-08
824	4	BUSHING, SPIDER ANCH. PIN	TRL-BRK-0001-09
825	4	ANCHOR PIN	TRL-BRK-0001-10
826	4	SHOE & LINING ASSY	TRL-BRK-0001-11
827	4	LINING, BRAKE BLOCK CAM	TRL-BRK-0001-12
828	4	LINING, BRAKE BLOCK ANCH.	TRL-BRK-0001-13
829	4	ROLLER	TRL-BRK-0001-14
830	4	RETAINER, ROLLER	TRL-BRK-0001-15
831	2	SPRING, SHOE RETRACTOR	TRL-BRK-0001-16
832	4	RETAINER PIN, RET. SPRING	TRL-BRK-0001-17
833	4	SPRING, SHOE KEEPER	TRL-BRK-0001-18
834	2	WASHER, CAMSHAFT	TRL-BRK-0001-19
835	4	GREASE SEAL	TRL-BRK-0001-20
836	2	BUSHING, CAMSHAFT SPIDER	TRL-BRK-0001-21
837	2	WASHER	TRL-BRK-0001-22
838	2	WASHER, CAMSHAFT SLACK ADJ.	TRL-BRK-0001-23
839	2	SNAP RING	TRL-BRK-0001-24
840	2	RETAINER, CAMSHAFT SL. ADJ.	TRL-BRK-0001-25
841	2	BUSHING, CAMSHAFT SUPP.	TRL-BRK-0001-26
842	2	CAMSHAFT, LH/RH	TRL-BRK-0001-27
843	2	SLACK ADJ. STRAIGHT AUTO.	TRL-BRK-0001-28
844	2	NUT, INNER SPINDLE BRG	TRL-BRK-0001-29
845	2	LOCKWASHER, INDEXING	TRL-BRK-0001-30
846	2	LOCKWASHER, TAB	TRL-BRK-0001-31
847	2	NUT, OUTER SPINDLE	TRL-BRK-0001-32
848	2	GREASE FITTING	TRL-BRK-0001-33
850	4	LOCKWASHER, AIR CHAM. MTG	TRL-BRK-0001-35
851	4	NUT, AIR CHAM. MTG	TRL-BRK-0001-36
855	2	STREET ELBOW 90	A-5502-6-8

74215-4-02

# Hydraulic Brake Assembly

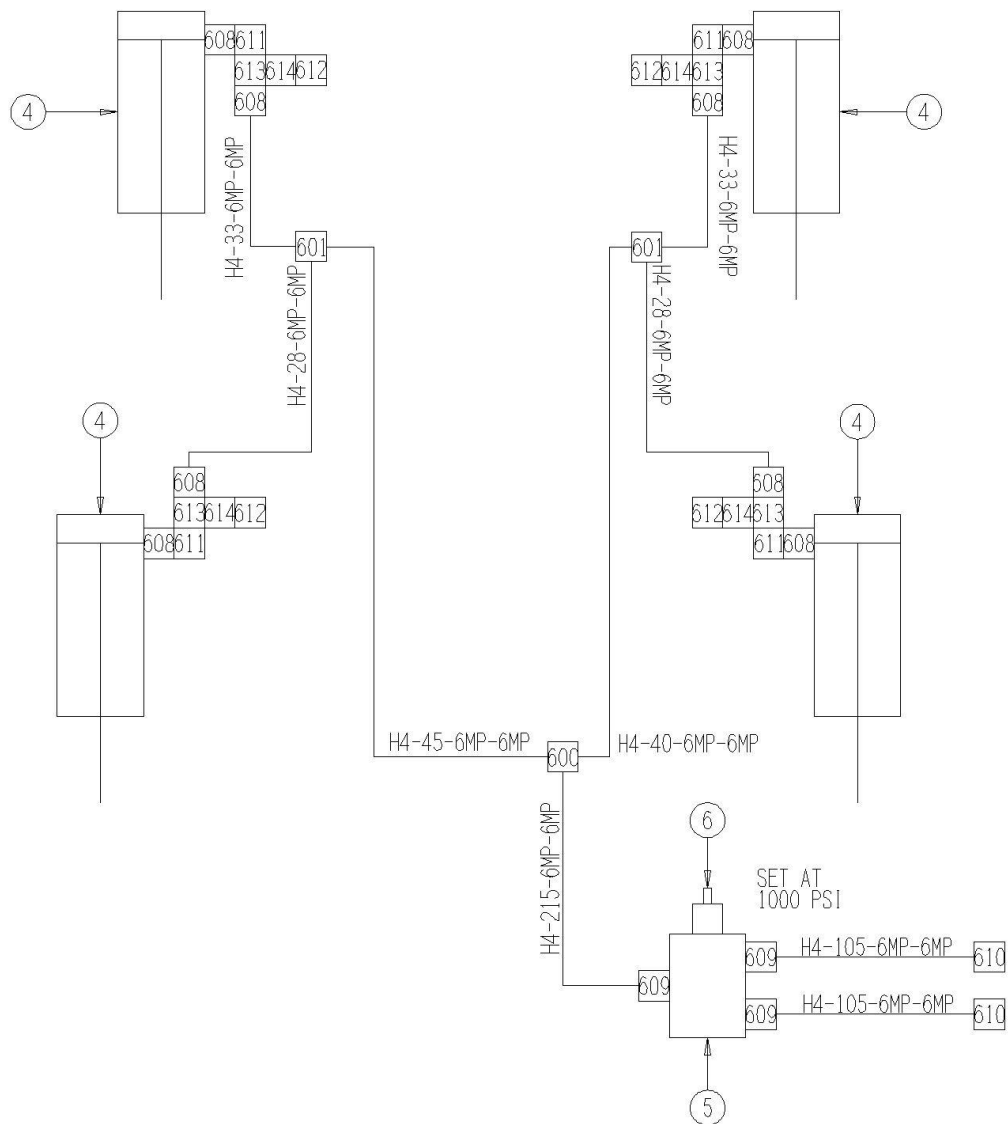

ITEM NO.	QTY	DESCRIPTION	PART NUMBER
3	4	HYDRAULIC BRAKE MOUNT	PR60074
4	4	SPRING RET. BRAKE CYL.	PR60073
5	1	PRESSURE RED./REL. VALVE	HV-1002
6	1	STANDARD KNOB	HV-1002-K
600	1	SWIVEL T 3/8" NPTF	A-1603-6-6-6
601	1	3/8MP x 3/8FPX x 3/8FPX TEE	A-1601-6-6-6
602	2	1/4" HOSE X 3/8MP X 3/8MP	H4-28-6MP-6MP
603	1	1/4" HOSE X 3/8MP X 3/8MP	H4-45-6MP-6MP
604	1	1/4" HOSE X 3/8MP X 3/8MP	H4-40-6MP-6MP
605	1	1/4" HOSE X 3/8MP X 3/8MP	H4-215-6MP-6MP

ITEM NO.	QTY	DESCRIPTION	PART NUMBER
606	2	1/4" HOSE X 3/8MP X 3/8MP	H4-105-6MP-6MP
607	2	1/4" HOSE X 3/8MP X 3/8MP	H4-33-6MP-6MP
608	8	3/8"MP X 3/8"FPX90	A-1501-6-6
609	3	6 SAE X 3/8 FPX	A-6900-6-6
610	2	TRACTOR QUICK CPLR	A-QD2010-8-8
611	4	HEX NIPPLE, 3/8" X 3/8"	A-5404-6-6
612	4	TEST POINT PLUG	HA-1004-T
613	4	1/4"MP X 3/8" FPX X 3/8"FPX TEE	A-1601-04-06-06
614	4	1/4" NPTF HEX PIPE CPLG.	A-5000-4

74215-4-03

## Opt. – Tractor Brake Control

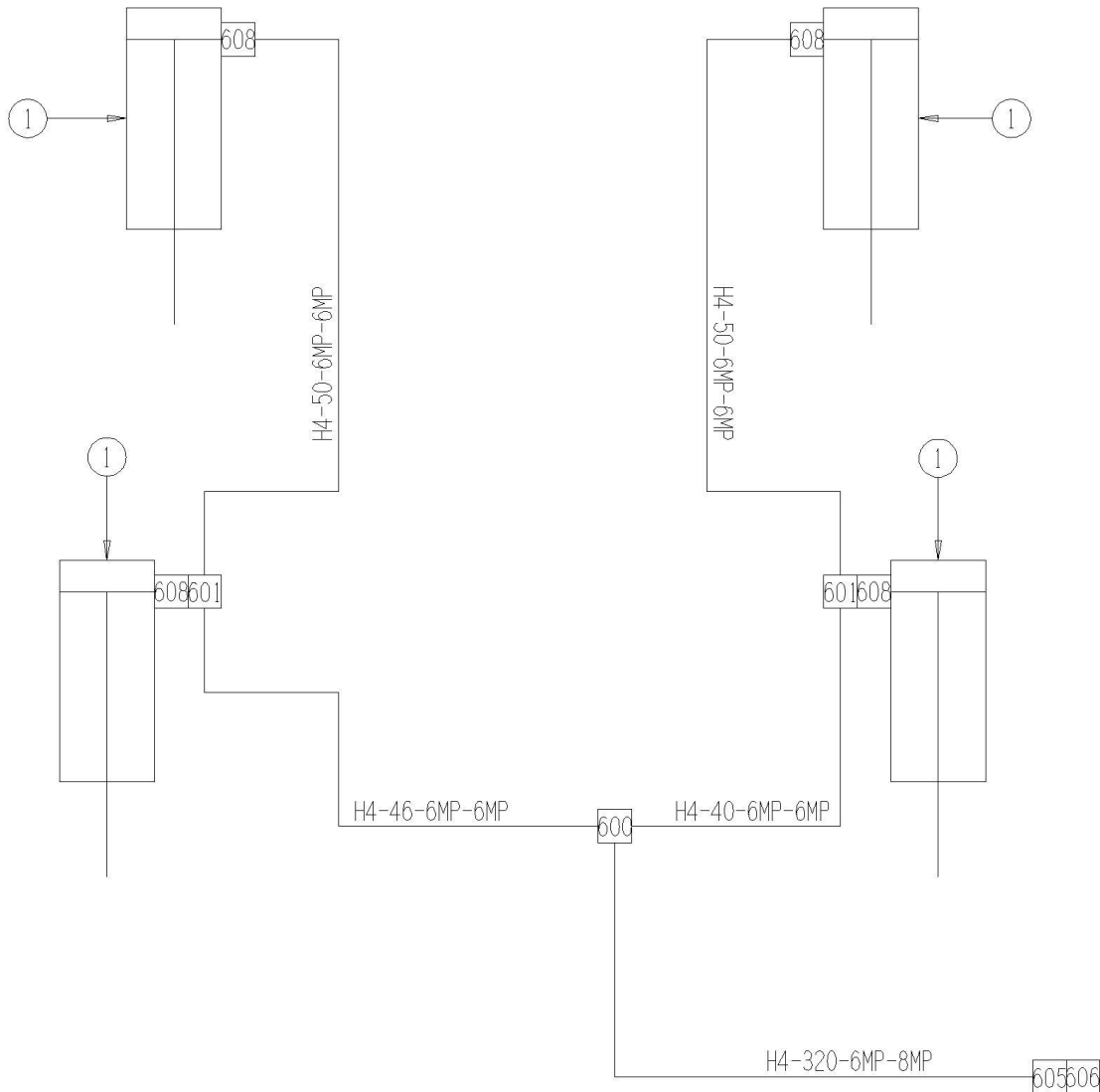

ITEM NO.	QTY	DESCRIPTION	PART NUMBER
0	4	HYDRAULIC BRAKE MOUNT	PR60074
1	4	SPRING RET. BRAKE CYL.	PR60073
600	1	SWIVEL T 3/8" NPTF	A-1603-6-6-6
601	2	3/8MP x 3/8FPX x 3/8FPX TEE	A-1601-6-6-6
602	2	1/4" HOSE X 3/8MP X 3/8MP	H4-50-6MP-6MP
603	1	1/4" HOSE X 3/8MP X 3/8MP	H4-46-6MP-6MP
604	1	1/4" HOSE X 3/8MP X 3/8MP	H4-40-6MP-6MP
605	1	METRIC TO PIPE ADAPTER	A-7455-08-18
606	1	HYD QUICK CONNECT CPLR	AQ-160559
607	1	1/4" HOSE X 3/8MP X 3/8MP	H4-320-6MP-8MP
608	4	3/8MP X 3/8FPX	A-1404-6-6
609	3	6 SAE X 3/8"FPX	A-6900-6-6

## 74215-5-01 Electrical & Lighting

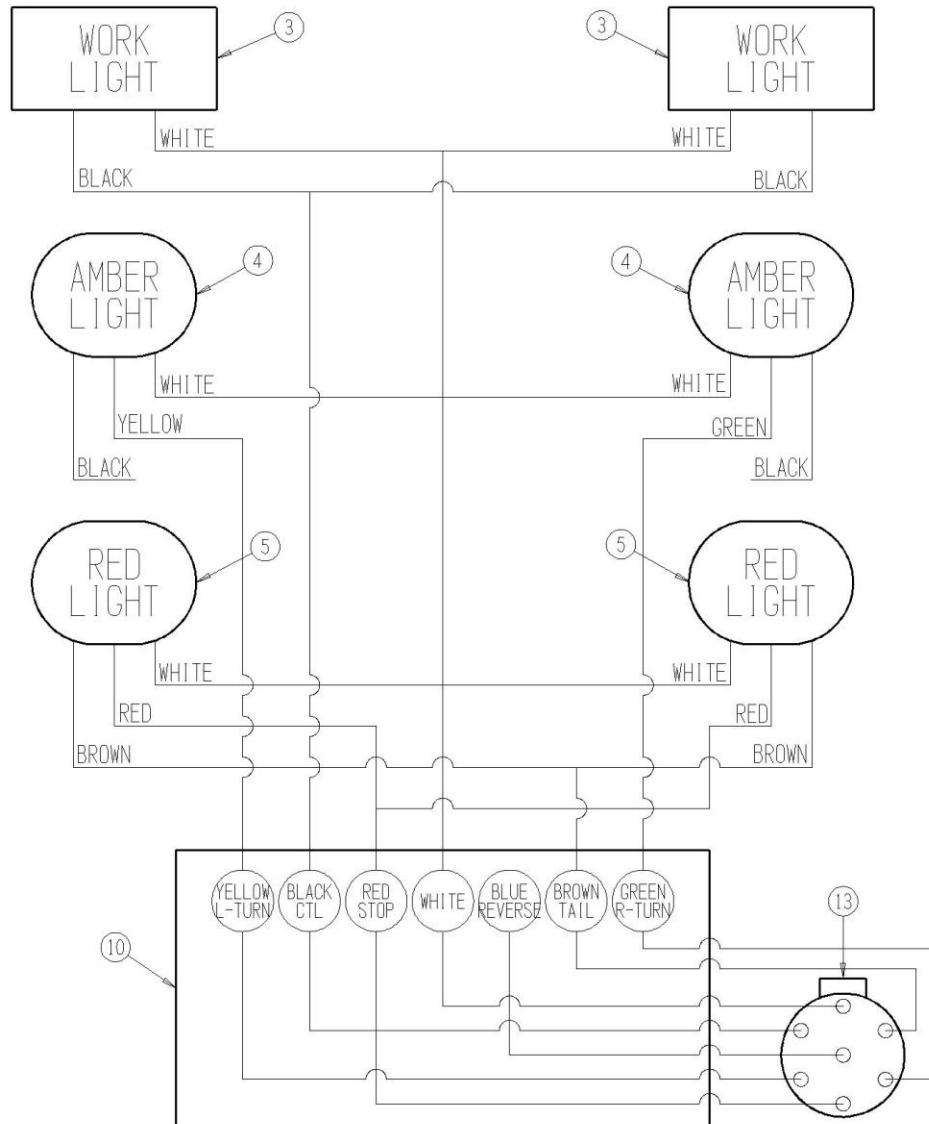

ITEM NO.	QTY	DESCRIPTION	PART NUMBER
1	1	LIGHT HARNESS, LH	EL-50561-397
2	1	LIGHT HARNESS, RH	EL-50562-416
3	2	HARNESS, WORK LIGHTS	EL-40604-13
4	1	7 CONDUCTOR HARNESS	EL-50780-362
5	2	LIGHT BRACKET	PR63007
601	2	WORK LIGHT	EL-1233
602	1	LED w/ BRAKE LIGHT, LH	EL-1501
603	1	LED w/ BRAKE LIGHT, RH	EL-1502
604	1	JUNCTION BOX	ELE-15-964
605	1	7 CONDUCTOR PLUG WITH SPRING	ELT-37675
606	1	4-PIN CONN., LH	EL-1503
607	1	4-PIN CONN., RH	EL-1504

## 74215-6-01 Safety Tow Chain

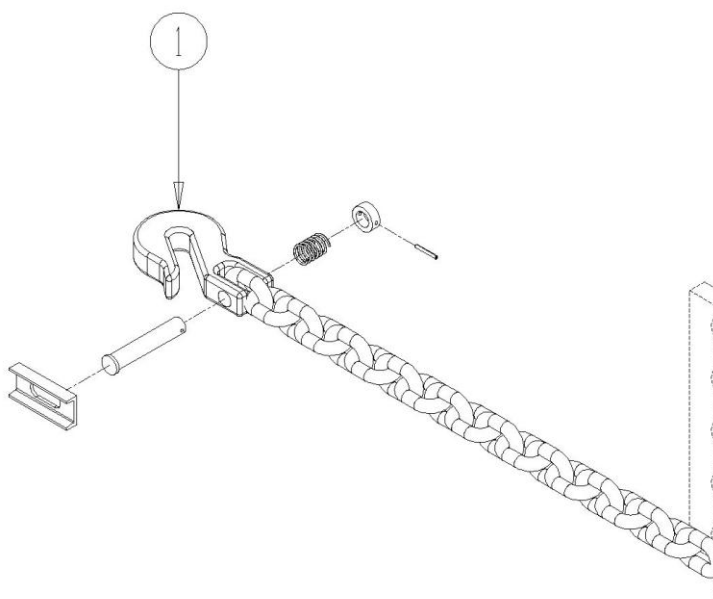

ITEM NO.	QTY	DESCRIPTION	PART NUMBER
1	1	SAFETY CHAIN	FRM-3172
101	1	1-1/2" FLAT WASHER	BL-24-FW
102	2	1" FLAT WASHER	BL-16-FW
103	1	1 UNC X 5 HH C/S GR5	BL-16-500-H
104	1	1" LOCK NUTS	BL-16-LN



74215-6-02

## Jack Stand

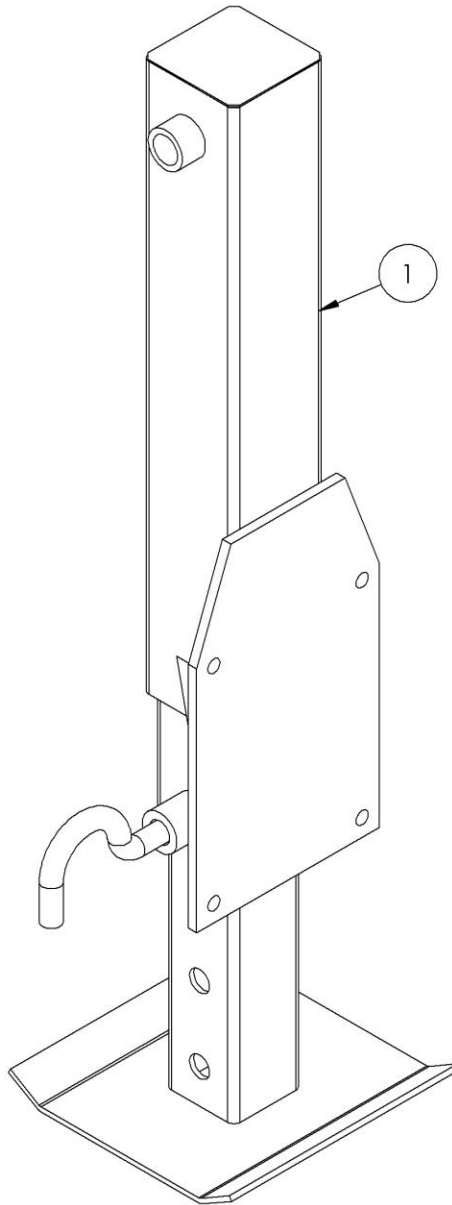

ITEM NO.	QTY.	DESCRIPTION	PART NUMBER
1	1	JACK	WH-1131

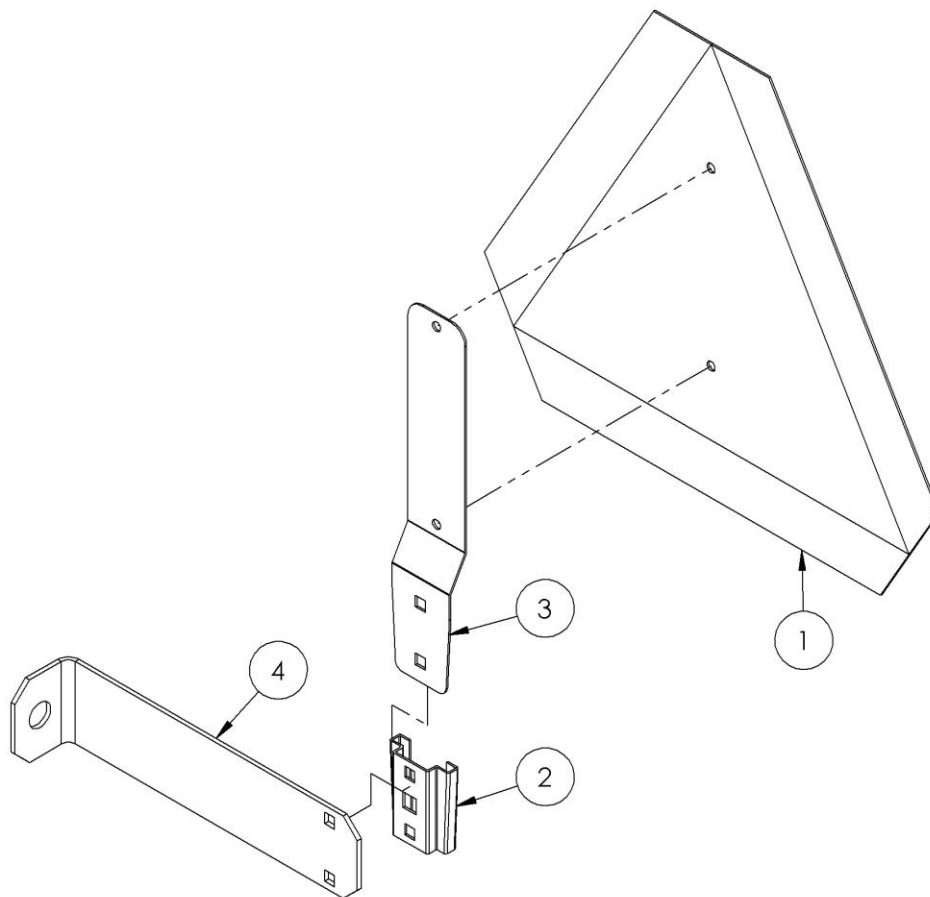

ITEM NO.	QTY	DESCRIPTION	PART NUMBER
1	1	SMV SIGN	SMV-PL
2	1	SOCKET, SPADE MOUNT	SMV-S
3	1	SPADE MOUNT	SMV-SM
4	1	SMV BRACKET	PR63006

# 74215-6-04      Decals, Front

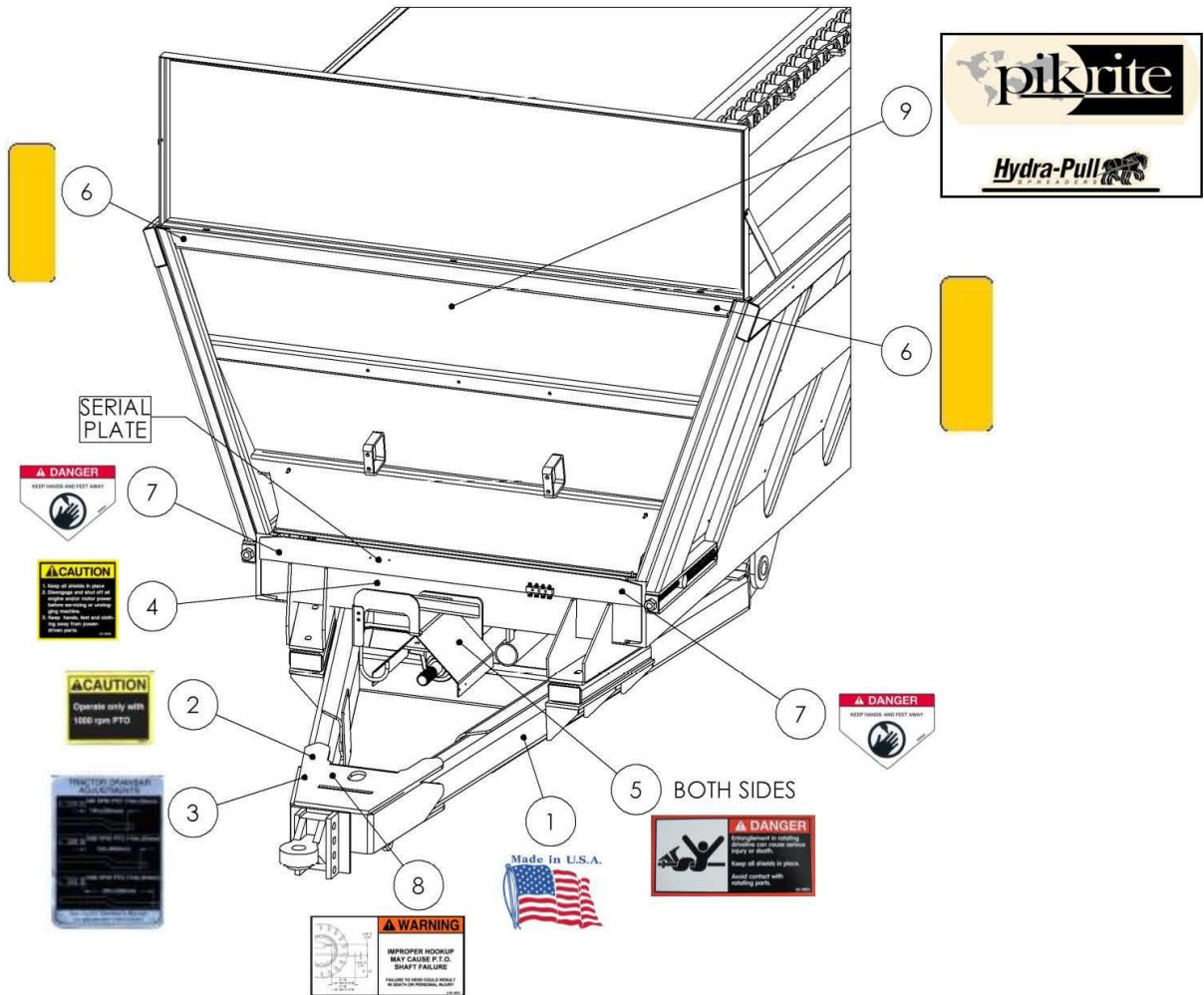

ITEM NO.	QTY	DESCRIPTION	PART NUMBER
1	1	DECAL, MADE IN USA	DC-0011
2	1	DECAL, CAUTION, 1000 rpm PTO	DC-0021
3	1	DECAL, TRACTOR DRAWBAR ADJUST.	DC-0022
4	1	DECAL, CAUTION, SHIELDS	DC-0023
5	2	DECAL, DANGER, ENTANGLEMENT	DC-0025
6	2	REFLECTOR, YELLOW	EL-1226
7	2	DECAL, DANGER, HANDS & FEET	DC-1174
8	1	DECAL, DANGER, IMPROPER PTO HOOKUP	DC-0013
9	1	DECAL, HYDRA PULL	DC-0103

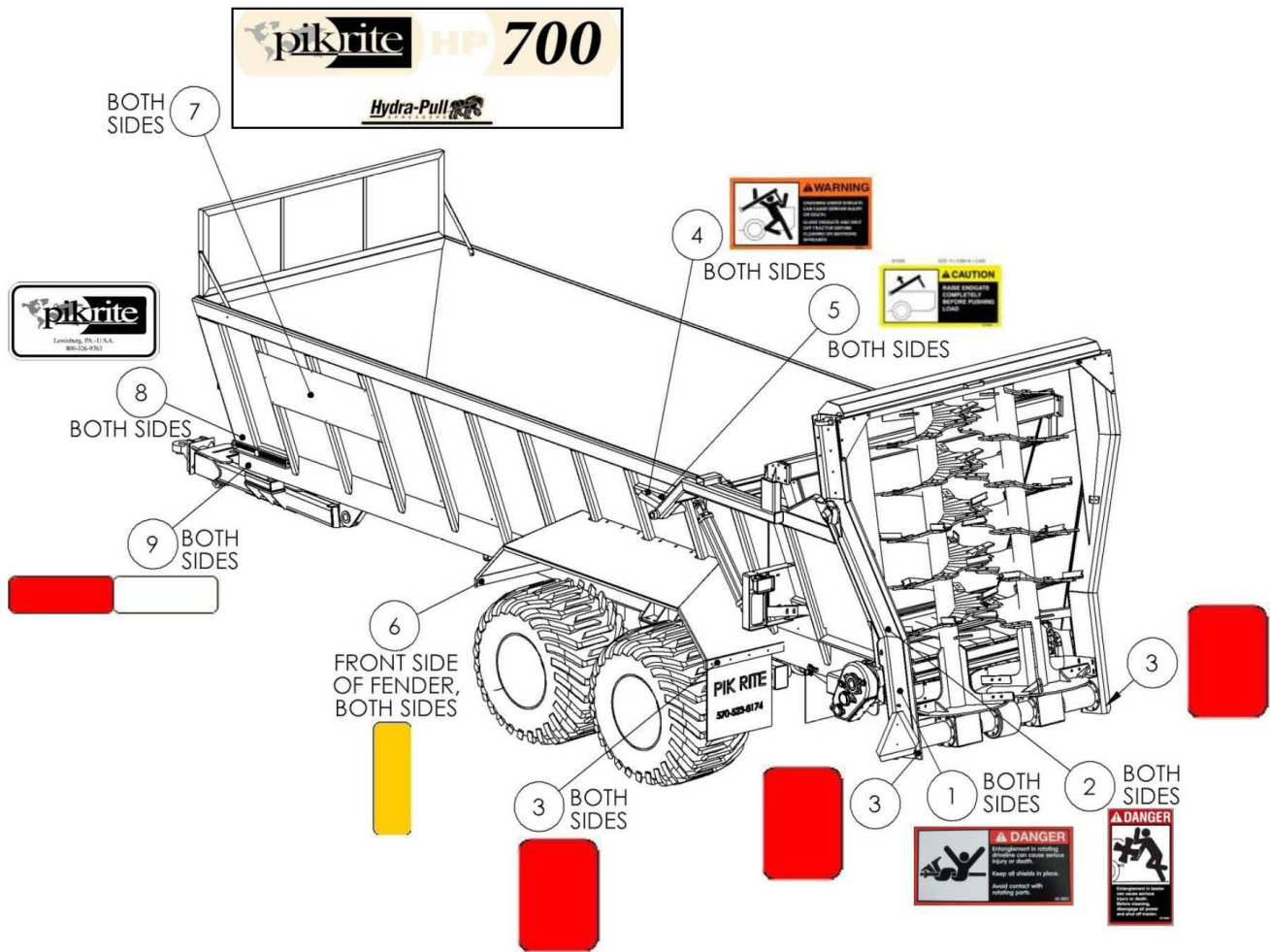

ITEM NO.	QTY	DESCRIPTION	PART NUMBER
1	2	DECAL, DANGER, DRIVE ENTANGLEMENT	DC-0025
2	2	DECAL, DANGER, BEATER ENTANGLEMENT	DC-0030
3	4	REFLECTOR, RED	EL-1227
4	2	DECAL, WARNING, ENDGATE	DC-0026
5	2	DECAL, CAUTION, RAISE ENDGATE	DC-0038
6	2	REFLECTOR, YELLOW	EL-1226
7	2	DECAL, PIK RITE LOGO	DC-0109
8	2	DECAL, LOGO	DC-4W
9	.15	REFLECTIVE TAPE, RED/WHITE, PER 150'	DC-3025





## ***WARRANTY***

Pik Rite, Inc. provides a limited warranty assuring any new Hydra-Pull Spreader to be free from defects in material and workmanship for a period of two (2) years from the original date of purchase.

Pik Rite will repair or replace, at its option and without charge, any defective or malfunctioning part (excluding items of normal wear or misuse) of the spreader for this allotted time.

**PIK RITE MAKES NO WARRANTY OF  
MERCHANTABILITY OR FITNESS FOR A  
PARTICULAR USE.**

## Customer's Responsibility:

It is the customer and/or operator's responsibility to read the Operator's Manual, to operate, lubricate, maintain and store the equipment in accordance with all instructions and safety procedures. Failure of the operator to read the operators manual is a misuse of this equipment.

It is the customer and/or operators responsibility to inspect the product and to have any part(s) repaired or replaced when continued operation would cause damage or excessive wear to other parts or cause a safety hazard.

It is the customer's responsibility to deliver the product to the authorized dealer, from whom the spreader was purchased, for service or replacement of defective parts, which are covered by warranty.

It is the customer's responsibility for any cost incurred by the dealer for hauling the product for the purpose of performing a warranty obligation or inspection.

## WARRANTY INFORMATION

Make certain the warranty registration card has been forwarded to:

Pik Rite, Inc.  
60 Pik Rite Lane  
Lewisburg, PA 17837

Always give your dealer the serial number of your Pik Rite, Inc. product when ordering parts or requesting service or other information.

In the space provided record the model number, the serial number and the date of purchase to assist in providing you with prompt and efficient service.

MODEL NUMBER: HP700

DEALER: \_\_\_\_\_

SERIAL NUMBER: \_\_\_\_\_

ADDRESS: \_\_\_\_\_

PURCHASE DATE: \_\_\_\_\_

PHONE: \_\_\_\_\_

SALESMAN: \_\_\_\_\_

# Keep Page for Your Records



Pik Rite, Inc.  
60 Pik Rite Lane  
Lewisburg, PA 17837

Phone: 800-326-9763  
Fax: 570-523-8175  
[www.pikrite.com](http://www.pikrite.com)

***HP 700***  
**Manure Spreader**